



PENTAIR



STRUCTURAL

ZUBEHÖR UND ERSATZTEILEN
DES DRUCKTANKS

WATER PURIFICATION

TANKS & SYSTEMS



EINLEITUNG

INHALT	5
POLYMERE	5
GUMMI/ELASTOMERE.....	6
METALLE	6
GEBRAUCHSANWEISUNG	7
WAS IST WAS ?.....	7
SYMBOLEN & IKONEN	8
ANWEISUNGEN	9
INSTALLATION INSTRUCTIONS	9
FLANSH MONTAGE	9
MONTAGE	10
ZUBEHÖRTEILE	
DECKEL & ADAPTERS	
2.5" GEWINDE	
2.5" CLOSURE PVC	11
4" GEWINDE	
DN 400	12
4" CLOSURE PVC	13
4" - 2.5" ADAPTER.....	14
6" GEWINDE	
6" CLOSURE PVC	15
6" FLANSCH	
6" BLINDFLANGE	16
6" BLINDFLANGE ULTRA PURE	17
6" FLANGE - 1.5 BSP	18
6" FLANGE - 2.5" 8UN	19
6" FLANGE - 4" 8UN	20
6" FLANGE - DN65	21
6" FLANGE - DN80	22
6" FLANGE - DN100	23



BLINDFLANSCH

DN50 FLANGE	24
DN65 FLANGE	25
DN80 FLANGE	26
DN100 FLANGE	27
DN125 FLANGE	28
DN150 FLANGE	29
DN200 FLANGE	30
DN400 FLANGE	31

ENTLEERUNG ADAPTERS

6" FLANSCH

1" BSP OUTLET STANDARD	32
1" BSP OUTLET LOW FLOW	33
1" BSP OUTLET HIGH FLOW	34

SHAUGLASS

SIGHTGLASS	35
------------------	----

VENTILE

BELÜFTUNGSVENTIL

1.5" AERATION VALVE	36
ADAPTER FOR AERATION VALVE 1.5"	37

2.5" VENTIL

2.5" VALVE MANUAL VALVE - 3/4" INLET/OUTLET	38
---	----

WERKZEUGE

SCHLUSSEL

NOTCHED WRENCH FOR ADATORS	39
OCTOGON 2.5"	40
OCTOGON 4"	41
WRENCH FOR MANUAL VALVE	42

EXTENSIONEN

EXTENSION 3/4 BSP	43
EXTENSION 2" BSP	44
EXTENSION HOLDER 6-FOLD HUB	45



ZUBEHÖRTEILE

VERTEILERKOPFE & ZUBEHÖR

HUB	46
HUBCAP	47
HUB ADAPTORS	48
LATERAL	49
DIFFUSOR	50
UNION	51
ELBOW	52

DICHTUNGEN

O'RING	53
FLAT SEAL	54



INHALT

POLYMERE

POLYETHYLEN (PE)

Polyethylen wird als Material für die innere Auskleidung der Standardbehälter von Structural sowie für einige Verschlüsse und Adapter in diesem Katalog verwendet.

Typische Eigenschaften:

- Geringes Gewicht
- Hohe Belastbarkeit und Dehnung vor Bruch
- Sehr geringe Wasseraufnahme und -durchlässigkeit
- Hohe Widerstandsfähigkeit gegenüber Chemikalien
- Widerstandsfähigkeit gegenüber Rissen aufgrund von Umweltbelastung

POLYPROPYLEN (PP)

Spritzgussmaterial für Standard-Rohrabzweigungen, Trichter und Trichterzwischenstücke

Typische Eigenschaften:

- Ähnliche Eigenschaften wie PE
- Höhere Temperaturbeständigkeit als PE
- Bei Kälte (unter 10 °C) wird PP spröde (Vorsicht bei Montage in Kälte).

GLASFASERVERSTÄRKTES POLYPROPYLEN (PP-GF)

Spritzgussmaterial für Rohrabzweigungen, Trichter und Trichterzwischenstücke für hohe Temperaturen. PP-GF ist wesentlich steifer als PP.

POLYPHENYLENOXID (PPO)

Spritzgussmaterial für typische Flansche und geflanschte Verschlüsse. PPO wird als 30 % glasgefülltes Produkt verwendet.

Typische Eigenschaften:

- Hohe Maßtreue
- Hohe Temperaturbeständigkeit (bis zu 99 °C)
- Gute Widerstandsfähigkeit gegenüber Hydrolyse
- Selbstlöschend, nicht tropfend
- Geringe Wasserabsorption

POLYVINYLIDENFLUORID (PVDF)

Verkleidungen und Bauteile für extrem reine Anwendungen. PVDF ist ein hochwertiges technisches Polymer mit hervorragenden (chemischen) Eigenschaften.

Typische Eigenschaften:

- Hohe Belastbarkeit und Dehnung vor Bruch bei hohen und tiefen Temperaturen.
- Sehr hohe Widerstandsfähigkeit gegenüber Chemikalien
- Geeignet für extrem reine Anwendungen
- Hohe mechanische Festigkeit.



POLYVINYLCHLORID (PVC)

Häufig verwendetes Polymer für Wasserleitungssysteme aber auch andere Anwendungen. PVC ist einer der am häufigsten verwendeten Kunststoffe der Welt. Structural verwendet PVC in einigen maschinell und mithilfe von Spritzguss hergestellten Teilen der Verteilungssysteme.

Typische Eigenschaften:

- Hohe mechanische Festigkeit, Steifheit und Härte
- Niedrige Kälteschlagfestigkeit
- Hohe chemische Widerstandsfähigkeit
- Selbstlöschend nach Entfernung der Zündquelle

GLASFASERVERSTÄRKTES EPOXIDHARZ (EP-GF)

Duroplastisches Material mit sehr hoher Festigkeit. Dieser Kunststoff ist bis zu 60 % glasgefüllt und erreicht die Festigkeit von Aluminium, hat jedoch ein noch höheres Verhältnis von Festigkeit zu Gewicht. Er soll keinen Kontakt mit dem Inhalt des Behälters haben und wird nur als Verstärkungselement verwendet.

Typische Eigenschaften:

- Sehr hohe Festigkeit und Haltbarkeit
- Nur für Strukturelemente



GUMMI/ELASTOMERE

ACRYL-NITRILKAUTSCHUK (NBR)

Gummiverbindung für allgemeine Zwecke

ETHYLEN-PROPYLEN-DIEN-KAUTSCHUK (EPDM)

Gummiverbindung mit besserer chemischer und thermischer Widerstandsfähigkeit als Standard-NBR

FLUORKAUTSCHUK (FPM)

Besondere Güte (Viton ®) für spezielle Anwendungen. Geeignet für die meisten extrem reinen oder hochkorrosiven Anwendungen.



TETRAFLUORETHYLEN/ HEXAFLUORPROPEN (FEP)

O-Ring-Material für sehr hohe Leistungsfähigkeit. FEP-Dichtungen bestehen eigentlich aus einem inneren FPM-Kern, der ihnen die erforderliche Flexibilität verleiht und von einer nahtlosen Hülle aus Teflon ® (PFA) umgeben ist.

Einsatz dort, wo chemische, toxikologische und thermische Eigenschaften von höchster Bedeutung sind.



METALLE

EDELSTAHL (SS)

Alle Schrauben werden aus Edelstahl der Güte A2 (1.4303-1.4301-1.4541), und alle Muttern, Nutscheiben, Federscheiben usw. aus Edelstahl der Güte A4 (1.4401-1.4571) hergestellt.

ALUMINIUM (AL)

Korrosionsbeständiges Metall mit geringem Gewicht für die Herstellung der Flansche, die in STRUCTURAL Druckbehälter eingebaut sind.

Für Auskünfte über spezielle chemische Widerstandsfähigkeit eines Materials bzw. mehrerer Materialien wenden Sie sich bitte an unsere Vertriebsabteilung. Wir helfen Ihnen gerne weiter. Bitte geben Sie die Chemikalie sowie deren Konzentration und Temperatur genau an.





GEBRAUCHSANWEISUNG

WAS IST WAS

1
14" - 16" - 18"

2 
6" FLANGE

6 
65°C

7 

8 
DN65

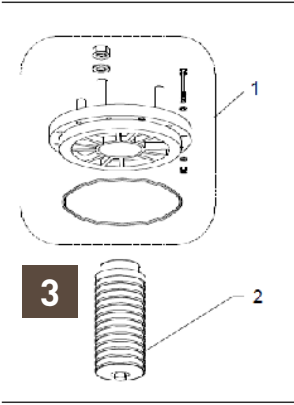
3 

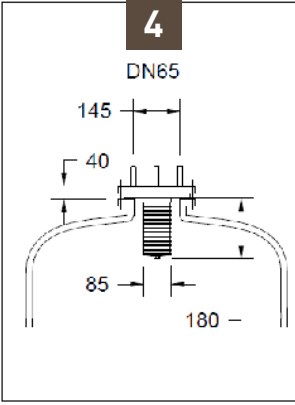
4
DN65

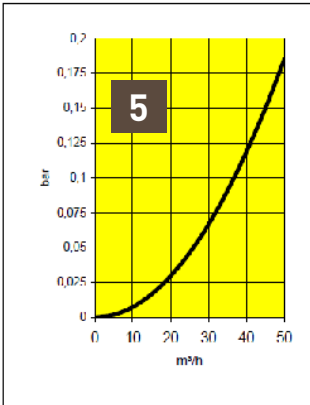
5

9 

10

Item	Description	11	Dimensions	Quantity	Matière	N° d'article	
1	Adaptor		6" - DN65	1	PP	A-3100-02C	A-3100-02C
2	Diffusor		2.5" - 180mm	1	PP	A-2740--	A-2746--
						A-2727-F6	A-2527-F6

12 
1

13

1 Diameter of vessel

2 Vessel connection

3 Exploded View

4 Dimensions

5 Pressure drop curve

6 Operating temperature

7 Type of installation

8 System connection

9 Type of lateral connection

10 Lateral slot size

11 Spare parts list

12 Minimum order quantity

13 Codes



SYMBOLLEN & IKONEN



Bajonet system



Systeme mit Gewinde



Schlitzbreite von 0.2 mm



Schlitzbreite von 0.3 mm



Schlitzbreite von 0.5 mm



Schlitzbreite von 12 mm



System oder Teil für Behälter mit Flan-



System oder Teil für Behälter mit Gewind-



Deckel mit Gewinde oder Flansch



Adapters mit Gewinde oder Flansch



Entleerung Adapter



Werkzeug und Zubehör für Montage



Oberes System für Behälter mit Flansch



Unteres System für Behälter mit Flansch



System für Behälter mit Flansch oben



System oder Teil einsetzbar von 1°C bis 50 °C



System oder Teil einsetzbar von 1°C bis 65 °C



System oder Teil einsetzbar von 1°C bis 99 °C



Systemanschluss



Adaptorfunktion von ... nach ...



Klebeanschluss



Zubehörteile



System oder Teil für Ultra Pure Anwend-



Maximum Drehmoment



Minimum Auftragsmenge



Oberes system für behälter mit Gewind-



Unteres system für behälter mit Gewinde



System für Behälter met uberer Gewinde



System für Behälter met Flansch oben und seitliche Öffnung



PENTAIR

EINLEITUNG



ANWEISUNGEN

INSTALLATION INSTRUKTIONEN FÜR VERTEILERSYSTEMEN

- Bitte überprüfen Sie die Teile auf Transportschaden bevor Montage und Installation.
- Beschützen Sie die Teile gegen Frost 0°C (32°F).
- Es empfiehlt sich die Teile in Heißwasser vorzuwärmen, bevor Montage unter 10°C (50°F).
- Maximum Torsion bis 5 Nm (3,69 ft.-lbs).

FLANSCH MONTAGE

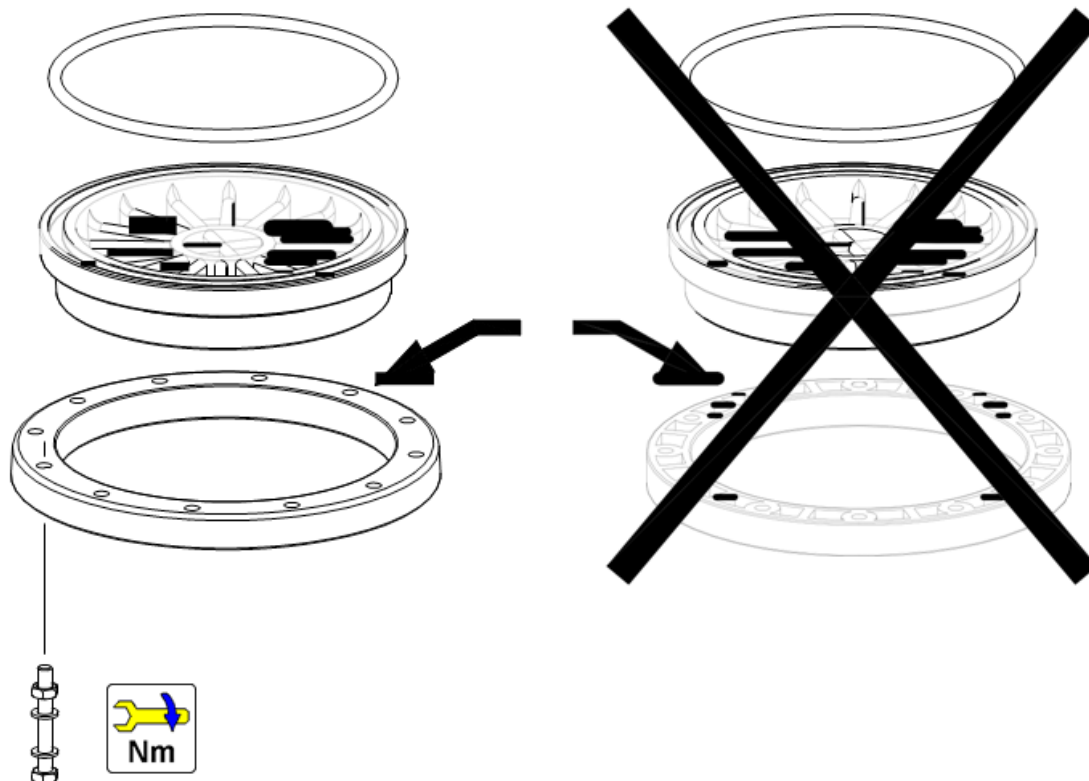



MONTAGE



1.Schritt: Einzelteile mit Montagehilfe I-WR03-LA.



2.Schritt: Montierte Einzelteile mit der Montagehilfe I-WR03-LA in den Behälter einbringen



3.Schritt: Montierte Einzelteile müssen komplett im Behälter sein, um das Verteilerrohr zu montieren



4.Schritt: Verteilerröhre in Verteilerkopf montieren, dabei Verteilerkopf mit Montagehilfe festhalten



5.Schritt: Flansch adapter auf Montage schrauben, dabei beachten dass der Dichtungsring auf dem Adapter montiert ist und abschliesst



6.Schritt: Zur Montage des Verteilersystems auf den Flansch den hinteren Flansch verwenden. Montagehilfe entfernen





PENTAIR

DECKEL & ADAPTERS

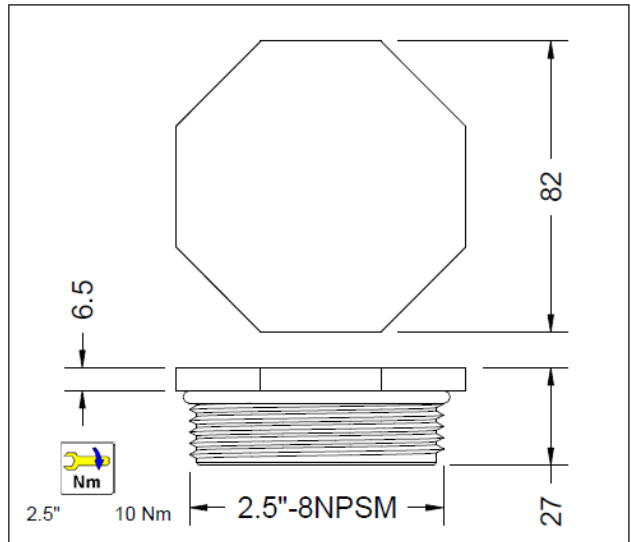
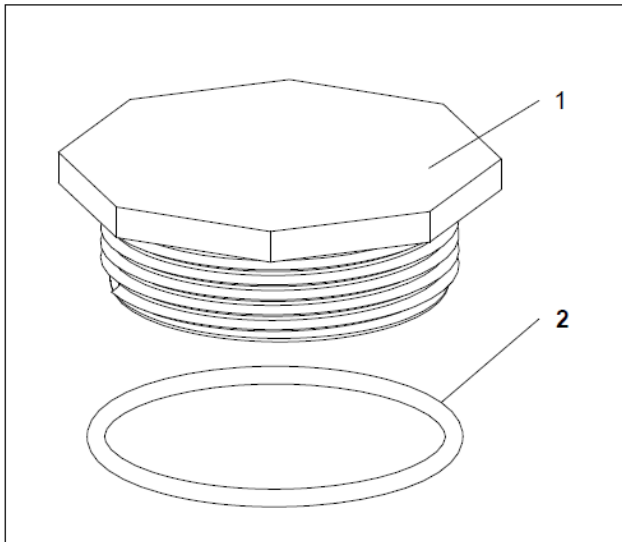
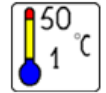
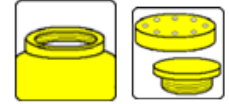

2.5" THREAD

2.5"-8NPSM

Item	Description	Dimensions	Quantity	Material	Part number
1	Closure	2.5" -8NPSM	1	PVC	A-2751-1
2	O-ring	66.27 x 3.53 mm	1	NBR	A-2694-1





PENTAIR

DECKEL & ADAPTERS



DN 400

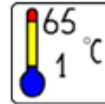
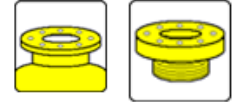

DN400



DN50

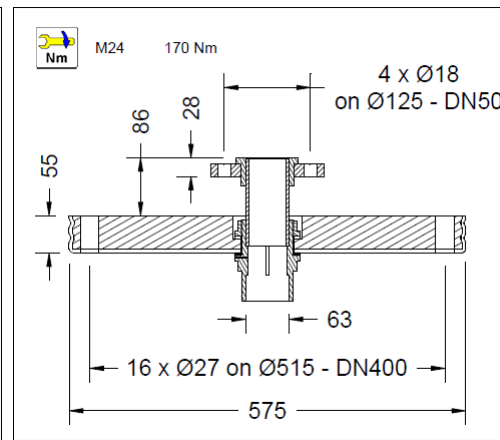
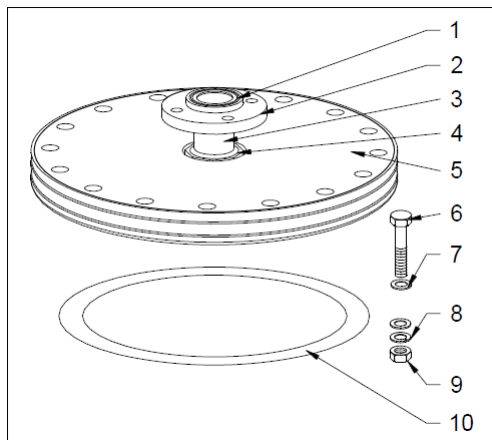

DN400 - DN50

Item	Description	Dimensions	Quantity	Material	Part number
1	Flange Adapter	DN50 - 63 mm	1	PVC	A-3720-64
2	Flange	DN50	1	PP-GF	X-1V-IPN1
3	Pipe	63 - 178 mm	1	PVC	A-PVC-063
4	Table Duct	63 mm	1	PVC	A-5160-65C
5	Flange	DN400	1	LLDPE/GR-EP	A-MACH-DN400
6	Bolt	M24 x 130	16	SS	A-M24-130
7	Washer	M24	32	SS	A-M24-RON
8	Spring Washer	M24	16	SS	A-M24-VRO
9	Nut	M24	16	SS	A-M24-A4
10	Flat Seal	DN400	1	NBR	A-DN40-0D



1

A-3400-02C



PENTAIR

DECKEL & ADAPTERS



4" THREAD

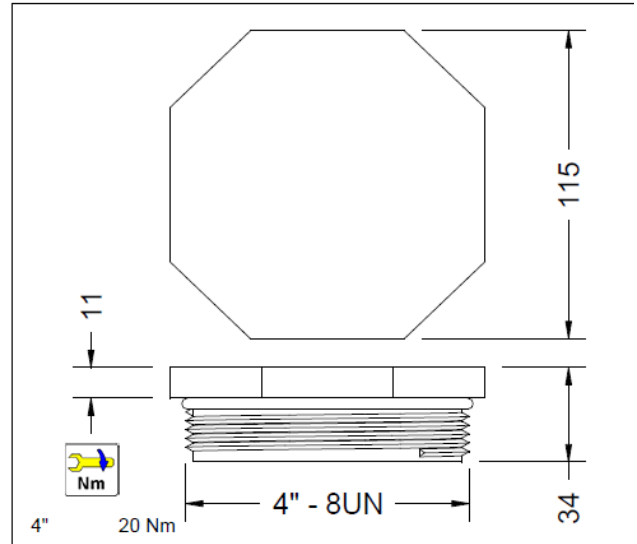
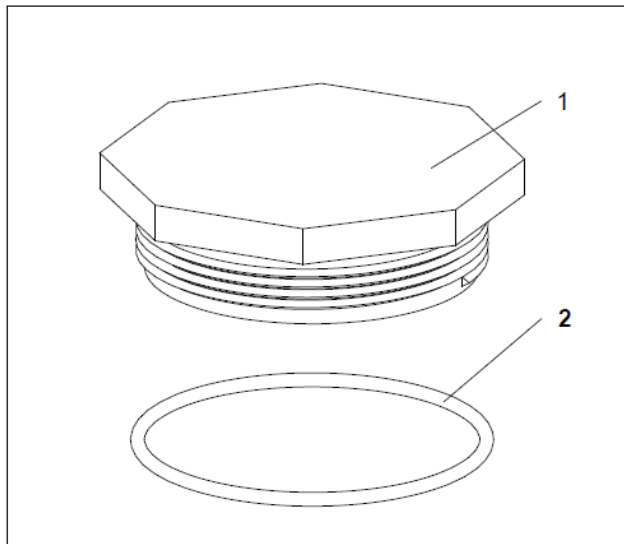
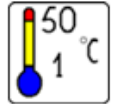
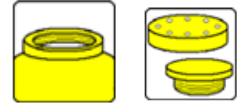

Item	Description	Dimensions	Quantity	Material	Part number
1	Closure	4"-8UN	1	PVC	A-2752-1
2	O-ring	98 x 4 mm	1	NBR	A-2694-3
					A-2752-1C



1



PENTAIR

DECKEL & ADAPTERS



4" THREAD

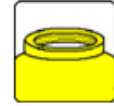

4"-8UN



2 1/2"-8NPSM

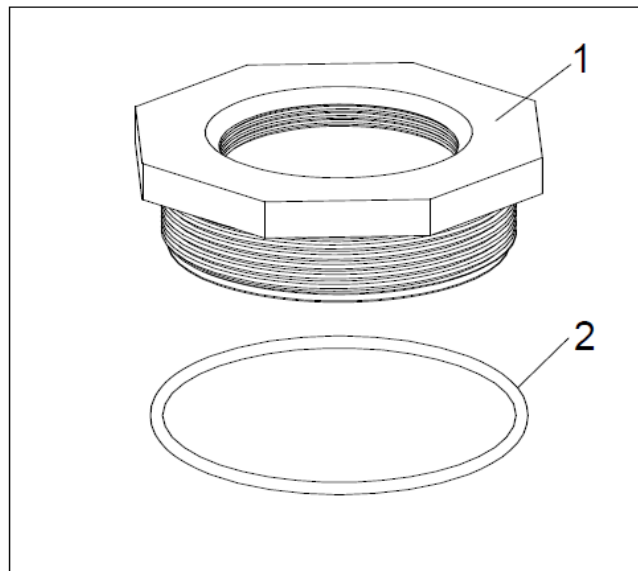

4" 20Nm



4" - 8 UN

Item	Description	Dimensions	Quantity	Material	Part number
1	Closure	4"-8UN	1	PVC	A-2752-2
2	O-ring	98 x 4 mm	1	NBR	A-2694-3
					A-2752-2C



1



PENTAIR

DECKEL & ADAPTERS



6" THREAD

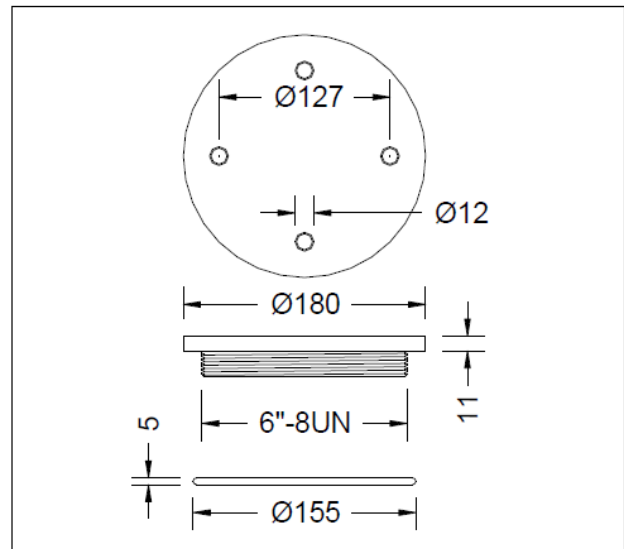
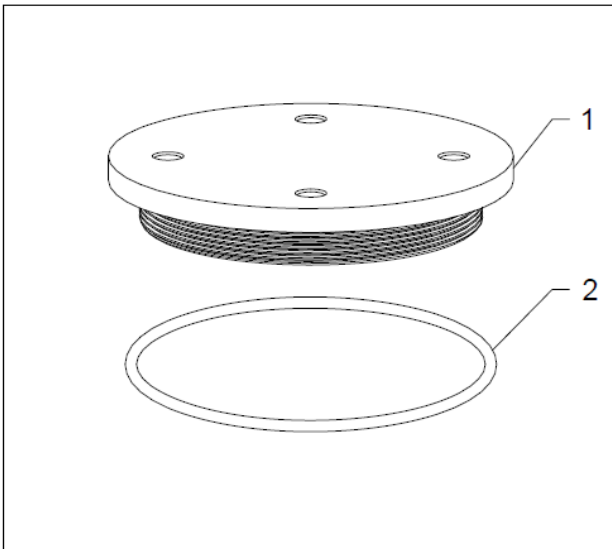
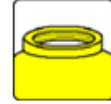

6" - 8 UN

Item	Description	Dimensions	Quantity	Material	Part number
1	Closure	6"-8UN	1	C-PVC	A-2695-3F
2	O-ring	155 x 5 mm	1	NBR	A-2694-BF
					A-2695-3FC



1



PENTAIR

DECKEL & ADAPTERS



6" FLANGE

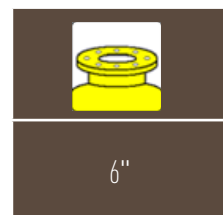
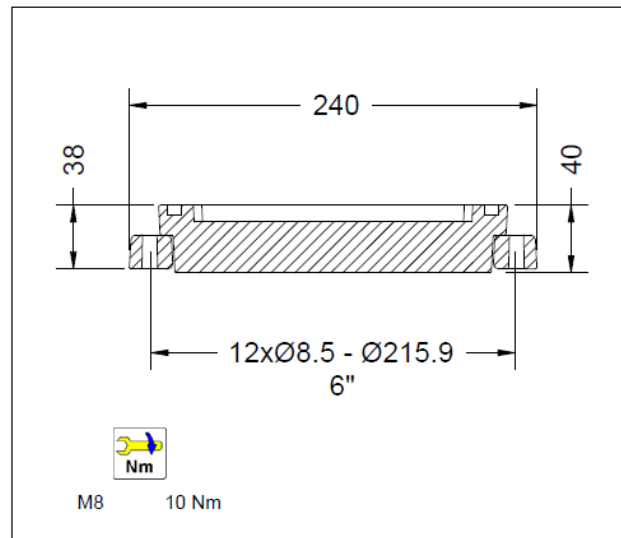
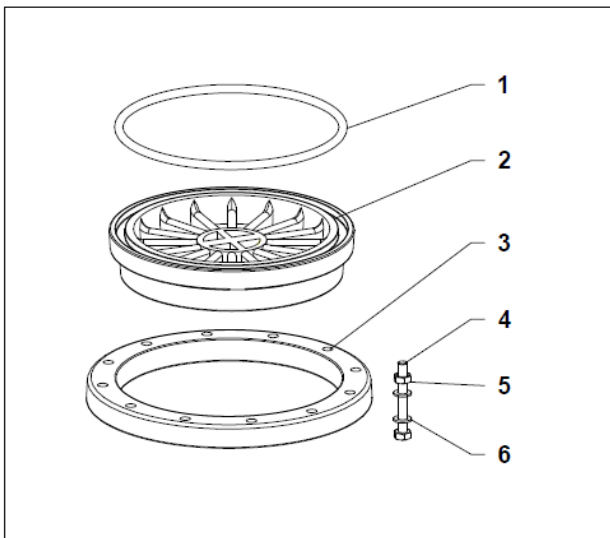
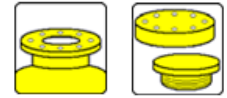

Item	Description	Dimensions	Quantity	Material	Part number
1	O-ring	183.52 x 6.99 mm	1	NBR	A-2694-8F
2	Closure	6"	1	PPO	A-085-0006
3	Backing Flange	6"	1	PPO	A-085-0221
4	Bolt	M8 x 75	12	SS	A-M8-075
5	Nut	M8	12	SS	A-M8-A4
6	Washer	M8	24	SS	A-M8-RON



A-3100-01C

1





PENTAIR

DECKEL & ADAPTERS

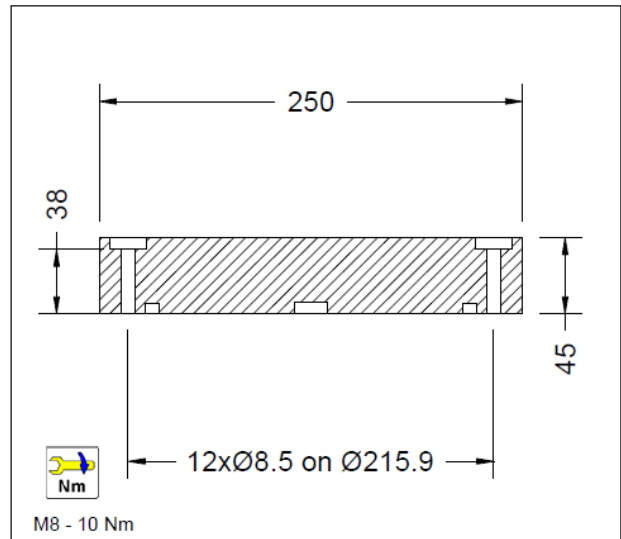
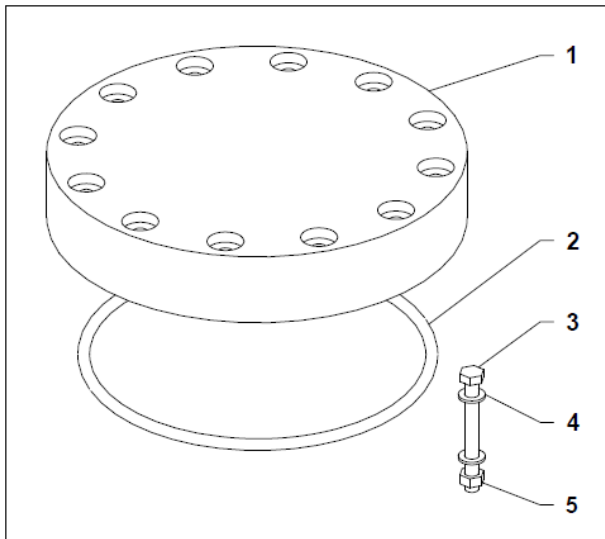
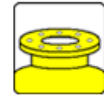

6" FLANGE

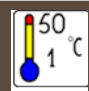
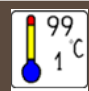

 HDPE	 PVDF
 50 1 °C	 99 1 °C
A-3100-ALC A1-3100-ALC	

Item	Description	Dimensions	Quantity	Material
1	Closure	6"	1	
2	O-ring	183.52 x 6.99 mm	1	FPM
3	Bolt	M8 x 75	12	SS
4	Washer	M8	24	SS
5	Nut	M8	12	SS





PENTAIR

DECKEL & ADAPTERS



6" FLANGE



6" FLANGE
1.5" BSP



1.5" BSP

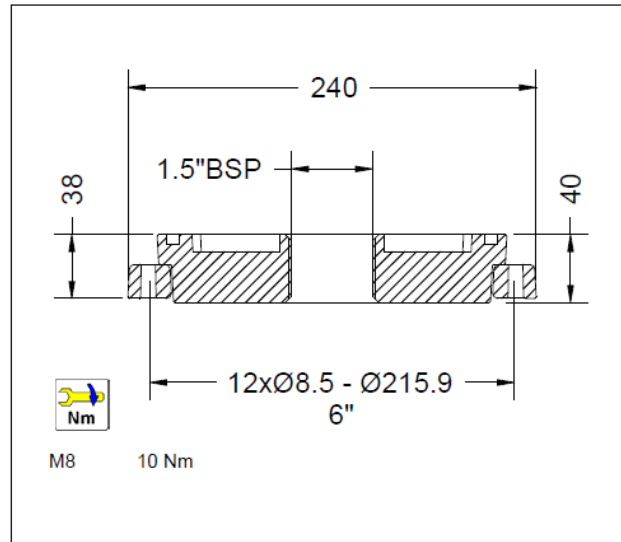
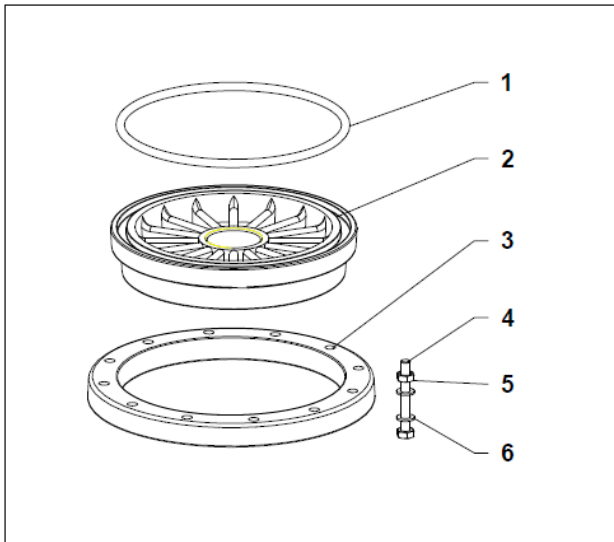

6" - 1.5" BSP

Item	Description	Dimensions	Quantity	Material	Part number
1	O-ring	183.52 x 6.99 mm	1	NBR	A-2694-8F
2	Adapter	6" - 1.5" BSP	1	PPO	A-085-0007
3	Backing Flange	6"	1	PPO	A-085-0221
4	Bolt	M8 x 75	12	SS	A-M8-075
5	Nut	M8	12	SS	A-M8-A4
6	Washer	M8	24	SS	A-M8-RON



1

A-3100-06C



PENTAIR

DECKEL & ADAPTERS



6" FLANGE

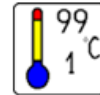
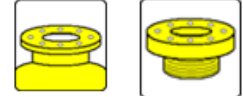

6" FLANGE
2.5"-8 NPSM



2.5" 8 NPSM

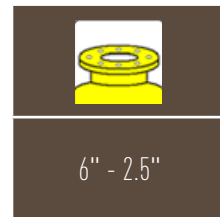
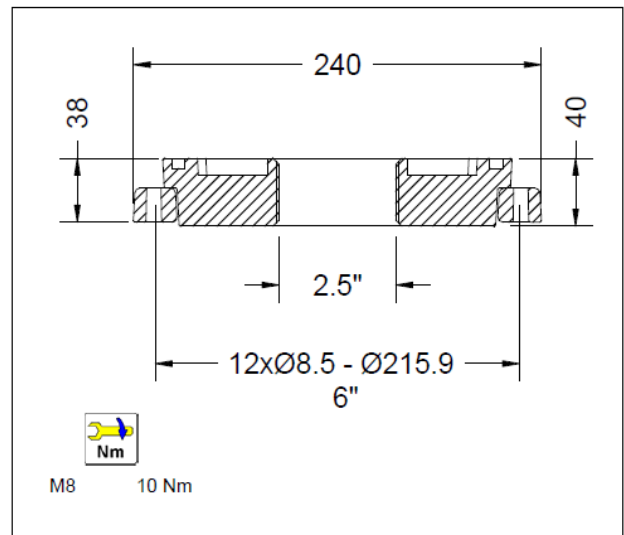
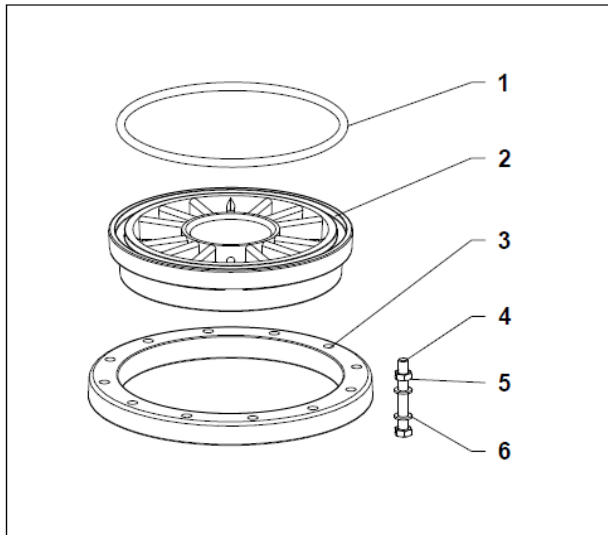

6" - 2.5"

Item	Description	Dimensions	Quantity	Material	Part number
1	O-ring	183.52 x 6.99 mm	1	NBR	A-2694-8F
2	Adapter	6" - 2.5"	1	PPO	A-085-0009
3	Backing Flange	6"	1	PPO	A-085-0221
4	Bolt	M8 x 75	12	SS	A-M8-075
5	Nut	M8	12	SS	A-M8-A4
6	Washer	M8	24	SS	A-M8-RON

A-3100-07C



1



PENTAIR

DECKEL & ADAPTERS



6" FLANGE

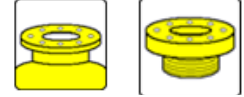

6" FLANGE
4" - 8 UN



4" - 8 UN

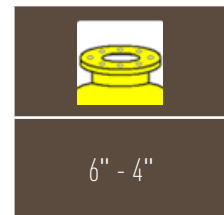
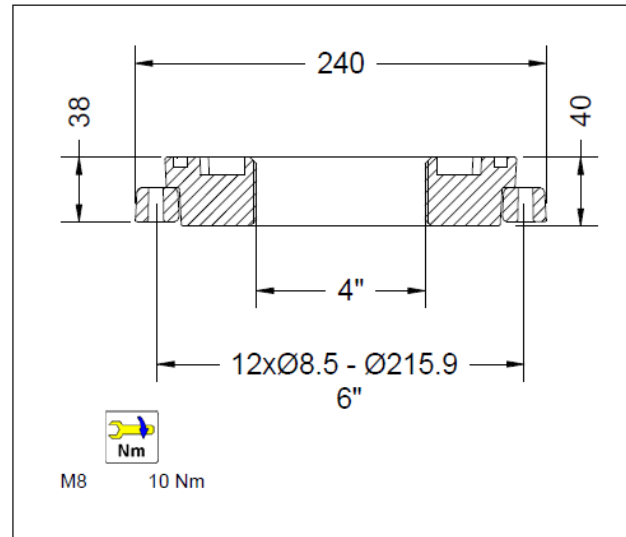
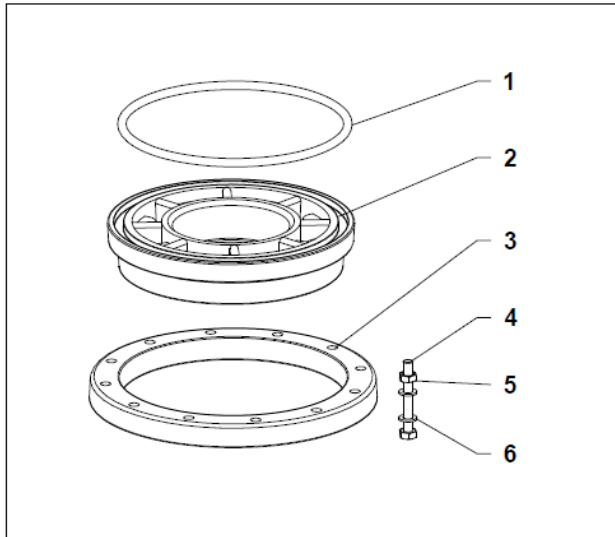

Item	Description	Dimensions	Quantity	Material	Part number
1	O-ring	183.52 x 6.99 mm	1	NBR	A-2694-8F
2	Adapter	6" - 4"	1	PPO	A-085-0101
3	Backing Flange	6"	1	PPO	A-085-0221
4	Bolt	M8 x 75	12	SS	A-M8-075
5	Nut	M8	12	SS	A-M8-A4
6	Washer	M8	24	SS	A-M8-RON



1

A-3100-08C



PENTAIR

DECKEL & ADAPTERS



6" FLANGE

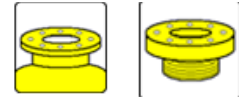

6" FLANGE
2.5" - 8 UN



DN 65

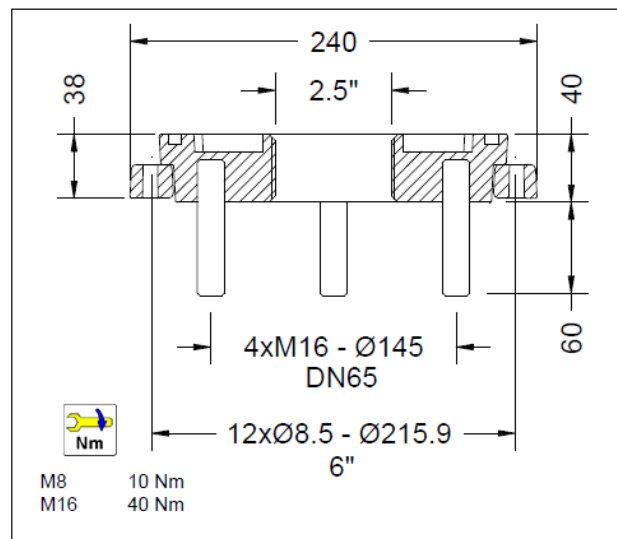
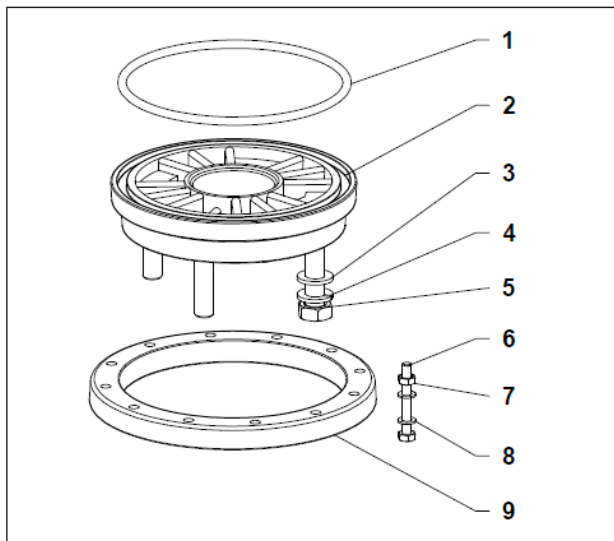

6" - DN65 - 2.5"

Item	Description	Dimensions	Quantity	Material	Part number
1	O-ring	183.52 x 6.99 mm	1	NBR	A-2694-8F
2	Adapter	6" - DN65	1	PPO	A-086-0000
3	Washer	M16	4	SS	A-M16-RON
4	Spring Washer	M16	4	SS	A-M16-VRO
5	Nut	M16	4	SS	A-M16-A4
6	Bolt	M8 x 75	12	SS	A-M8-075
7	Nut	M8	12	SS	A-M8-A4
8	Washer	M8	24	SS	A-M8-RON
9	Backing Flange	6"	1	PPO	A-085-0221



1

A-3100-02C



PENTAIR

DECKEL & ADAPTERS



6" FLANGE

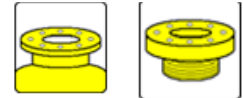

6" FLANGE
4" - 8 UN



DN 80

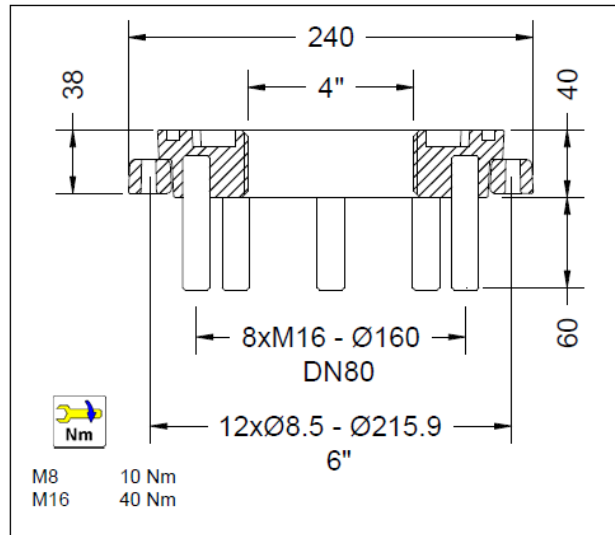
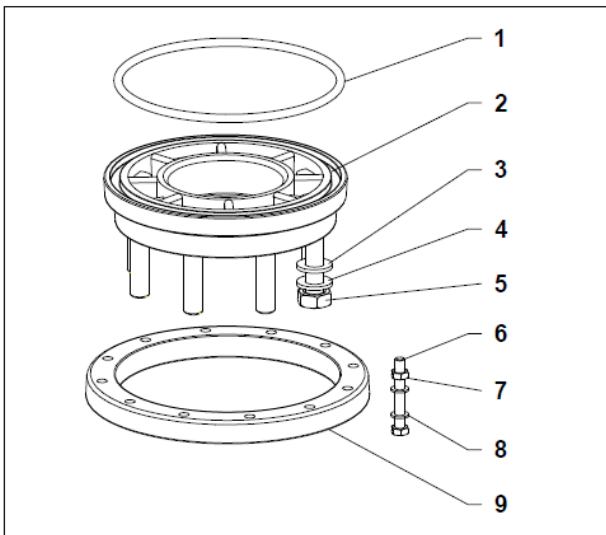

Item	Description	Dimensions	Quantity	Material	Part number
1	O-ring	183.52 x 6.99 mm	1	NBR	A-2694-8F
2	Adapter	6" - DN80	1	PPO	A-086-0003
3	Washer	M16	8	SS	A-M16-RON
4	Spring Washer	M16	8	SS	A-M16-VRO
5	Nut	M16	8	SS	A-M16-A4
6	Bolt	M8 x 75	12	SS	A-M8-075
7	Nut	M8	12	SS	A-M8-A4
8	Washer	M8	24	SS	A-M8-RON
9	Backing Flange	6"	1	PPO	A-085-0221



A-3100-03C

1



PENTAIR

DECKEL & ADAPTERS



6" FLANGE

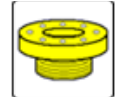
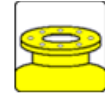

6" FLANGE
4" - 8 UN



DN 100

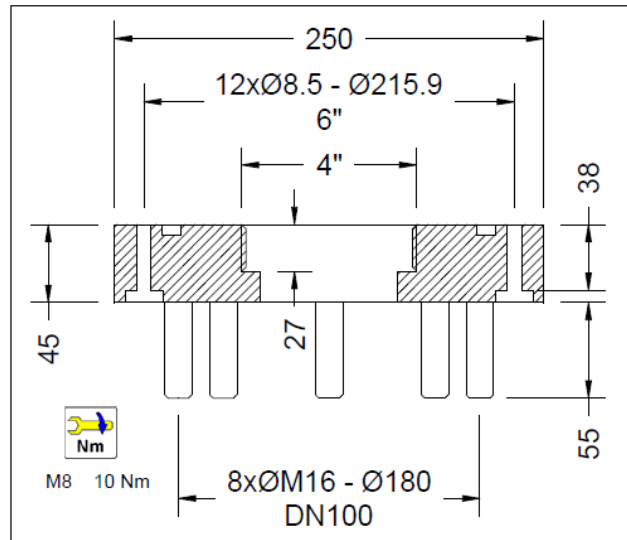
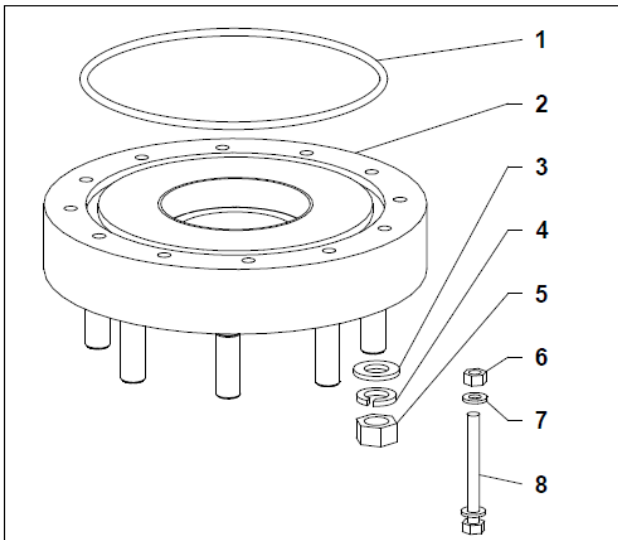

6"-DN100-4"

Item	Description	Dimensions	Quantity	Material	Part number
1	O-ring	183.52 x 6.99 mm	1	NBR	A-2694-8F
2	Adapter	6" - DN100	1	PPO	A-3100-100
3	Washer	M16	8	SS	A-M16-RON
4	Spring Washer	M16	8	SS	A-M16-VR0
5	Nut	M16	8	SS	A-M16-A4
6	Nut	M8	12	SS	A-M8-A4
7	Washer	M8	24	SS	A-M8-RON
8	Bolt	M8	12	SS	A-M8-075

A-3100-09C



1



PENTAIR

DECKEL & ADAPTERS



BLINDFLANGE

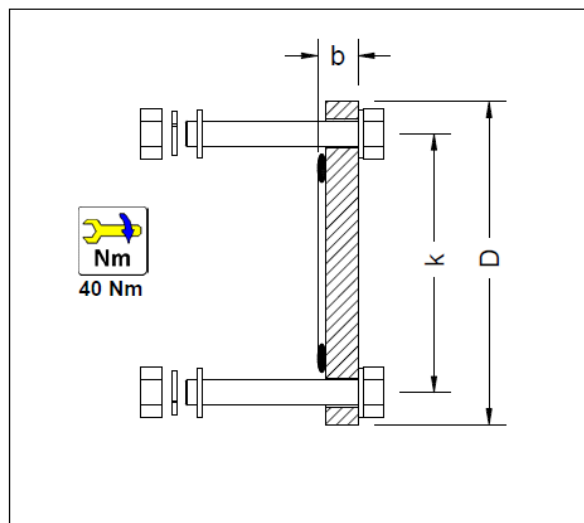
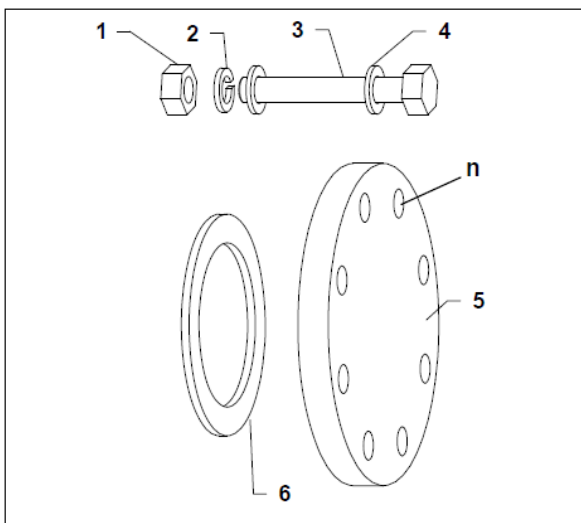
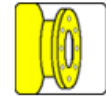

Item	Description	Material	DN50	DN80	DN100	DN200
1	Nut	SS	A-M16-A4	A-M16-A4	A-M16-A4	A-M20-A4
2	Spring Washer	SS	A-M16-VRO	A-M16-VRO	A-M16-VRO	A-M20-VRO
3	Bolt	SS	A-M16-90	A-M16-90	A-M16-90	A-M20-120
4	Washer	SS	A-M16-RON	A-M16-RON	A-M16-RON	A-M20-RON
5	Blind Flange	PP-GF/PVC	AG-DN-50B	AG-DN-80B	AG-DN-10B	A6-DN20-PPGF
6	Seal	NBR	A-2600-68	A-2600-71	A-2600-67	A-DN20-0D
			4	8	8	8
			19	19	20	46
			145	160	180	295
			185	200	220	340
			AG-DN-50L	AG-DN-80L	AG-DN-10L	A-3200-01C





PENTAIR

DECKEL & ADAPTERS



BLINDFLANGE

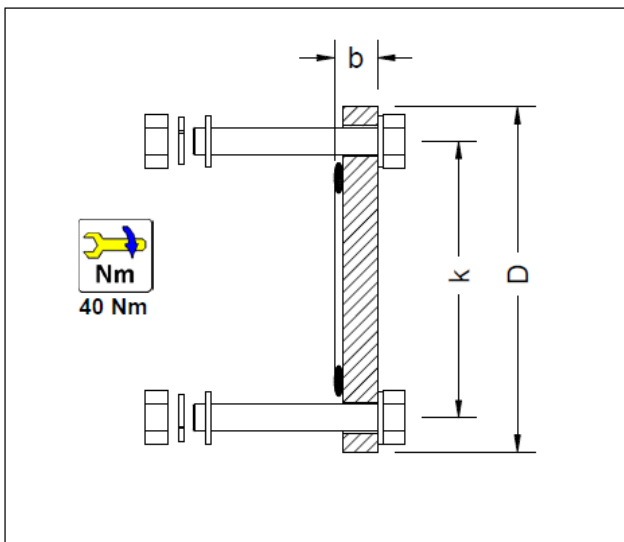
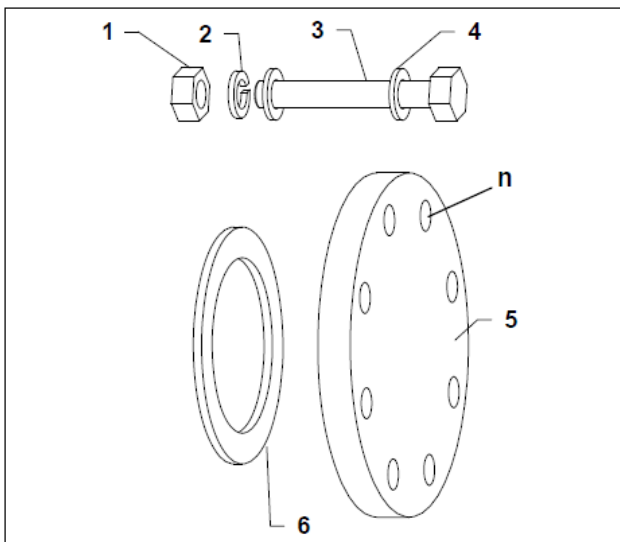

Item	Description	Material	DN50	DN80	DN100	DN200
1	Nut	SS	A-M16-A4	A-M16-A4	A-M16-A4	A-M20-A4
2	Spring Washer	SS	A-M16-VRO	A-M16-VRO	A-M16-VRO	A-M20-VRO
3	Bolt	SS	A-M16-90	A-M16-90	A-M16-90	A-M20-120
4	Washer	SS	A-M16-RON	A-M16-RON	A-M16-RON	A-M20-RON
5	Blind Flange	PP-GF/PVC	AG-DN-50B	AG-DN-80B	AG-DN-10B	A-3742-00
6	Seal	NBR	A-2600-68	A-2600-71	A-2600-67	A-DN20-0D
			4	8	8	8
			19	19	20	46
			145	160	180	295
			185	200	220	340
			AG-DN-50L	AG-DN-80L	AG-DN-10L	A-3200-01C





PENTAIR

DECKEL & ADAPTERS



BLINDFLANGE

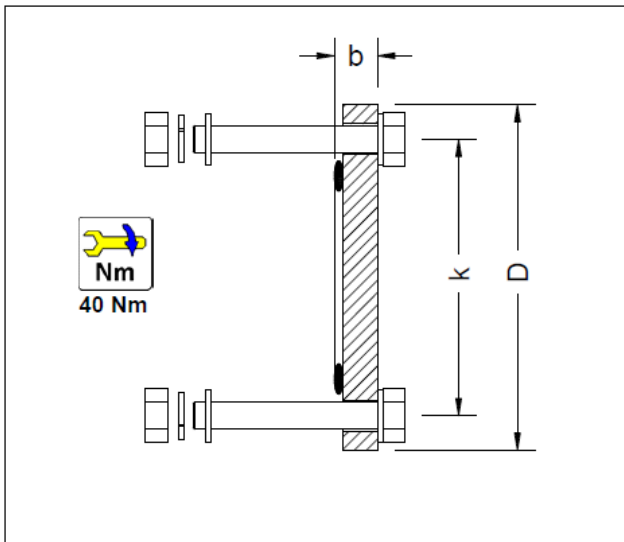
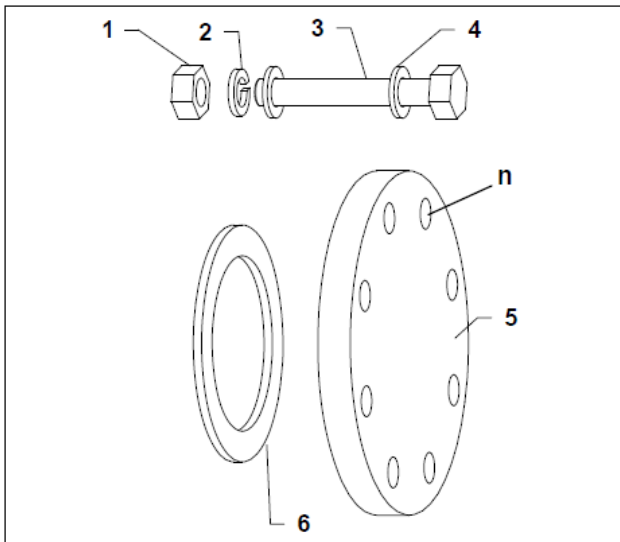
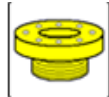

Item	Description	Material	DN50	DN80	DN100	DN200
1	Nut	SS	A-M16-A4	A-M16-A4	A-M16-A4	A-M20-A4
2	Spring Washer	SS	A-M16-VRO	A-M16-VRO	A-M16-VRO	A-M20-VRO
3	Bolt	SS	A-M16-90	A-M16-90	A-M16-90	A-M20-120
4	Washer	SS	A-M16-RON	A-M16-RON	A-M16-RON	A-M20-RON
5	Blind Flange	PP-GF/PVC	AG-DN-50B	AG-DN-80B	AG-DN-10B	A-3742-00
6	Seal	NBR	A-2600-68	A-2600-71	A-2600-67	A-DN20-0D
			4	8	8	8
			19	19	20	46
			145	160	180	295
			185	200	220	340
			AG-DN-50L	AG-DN-80L	AG-DN-10L	A-3200-01C







PENTAIR

DECKEL & ADAPTERS

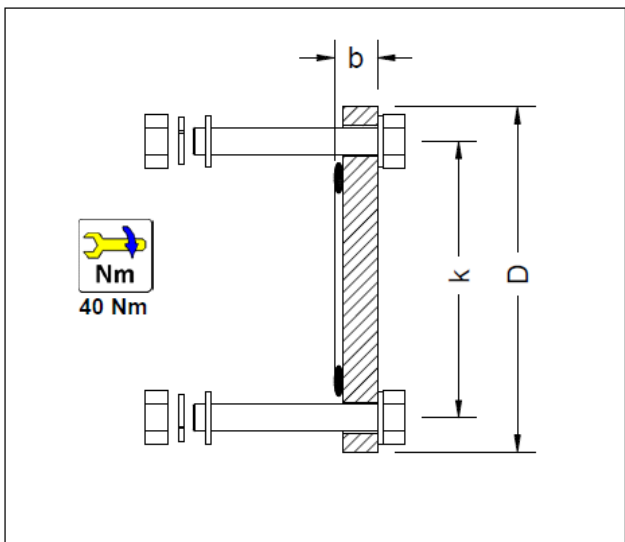
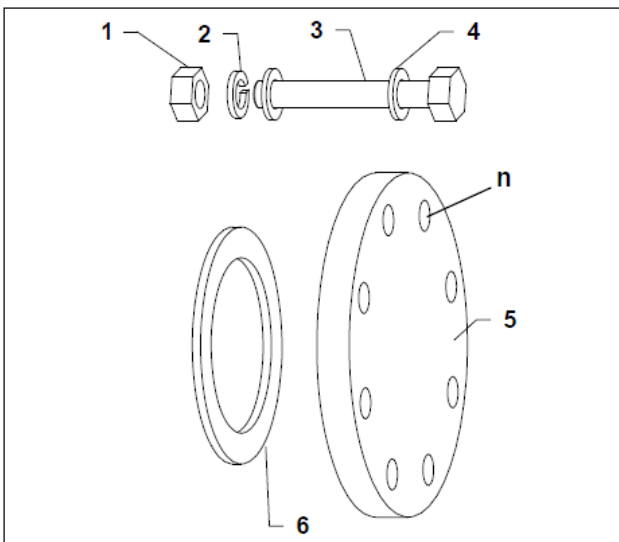
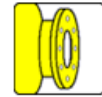

BLINDFLANGE



Item	Description	Material	DN50	DN80	DN100	DN200
1	Nut	SS	A-M16-A4	A-M16-A4	A-M16-A4	A-M20-A4
2	Spring Washer	SS	A-M16-VRO	A-M16-VRO	A-M16-VRO	A-M20-VRO
3	Bolt	SS	A-M16-90	A-M16-90	A-M16-90	A-M20-120
4	Washer	SS	A-M16-RON	A-M16-RON	A-M16-RON	A-M20-RON
5	Blind Flange	PP-GF/PVC	AG-DN-50B	AG-DN-80B	AG-DN-10B	A-3742-00
6	Seal	NBR	A-2600-68	A-2600-71	A-2600-67	A-DN20-0D
 1			4	8	8	8
			19	19	20	46
			145	160	180	295
			185	200	220	340
			AG-DN-50L	AG-DN-80L	AG-DN-10L	A-3200-01C



PENTAIR

DECKEL & ADAPTERS



BLINDFLANGE

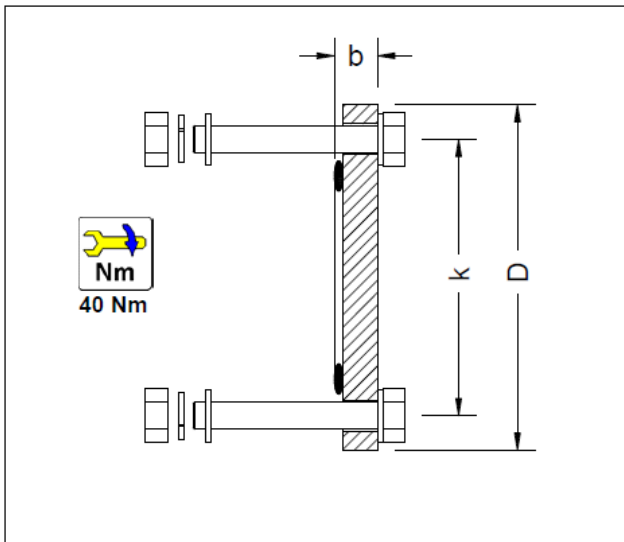
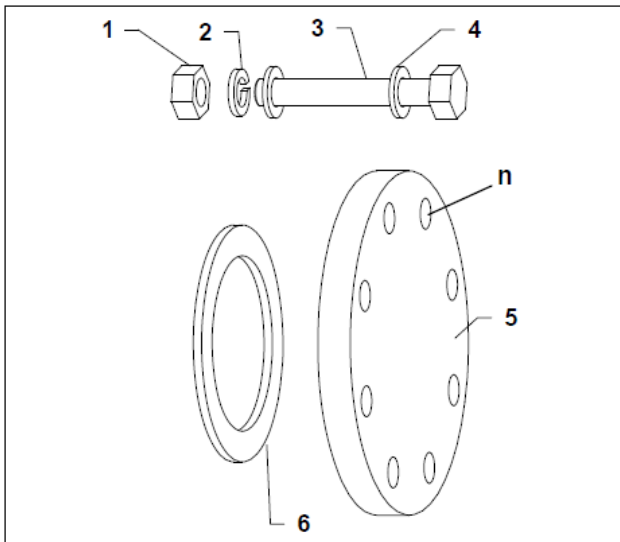
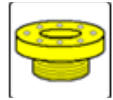
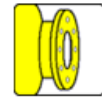

Item	Description	Material	DN50	DN80	DN100	DN200
1	Nut	SS	A-M16-A4	A-M16-A4	A-M16-A4	A-M20-A4
2	Spring Washer	SS	A-M16-VRO	A-M16-VRO	A-M16-VRO	A-M20-VRO
3	Bolt	SS	A-M16-90	A-M16-90	A-M16-90	A-M20-120
4	Washer	SS	A-M16-RON	A-M16-RON	A-M16-RON	A-M20-RON
5	Blind Flange	PP-GF/PVC	AG-DN-50B	AG-DN-80B	AG-DN-10B	A-3742-00
6	Seal	NBR	A-2600-68	A-2600-71	A-2600-67	A-DN20-0D
			4	8	8	8
			19	19	20	46
			145	160	180	295
			185	200	220	340
			AG-DN-50L	AG-DN-80L	AG-DN-10L	A-3200-01C





PENTAIR

DECKEL & ADAPTERS



BLINDFLANGE

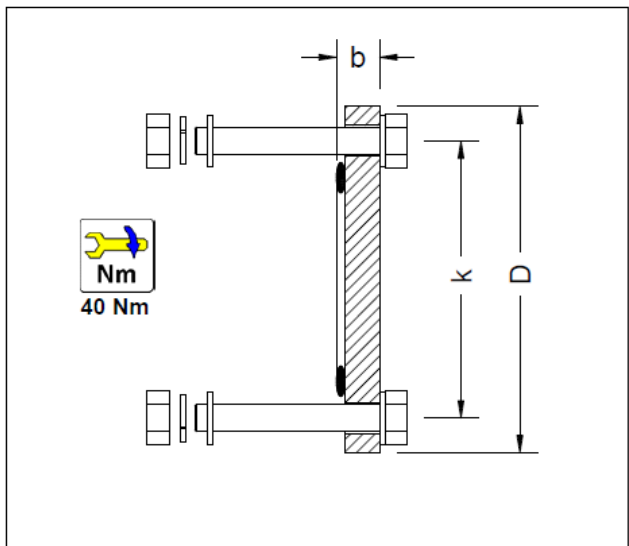
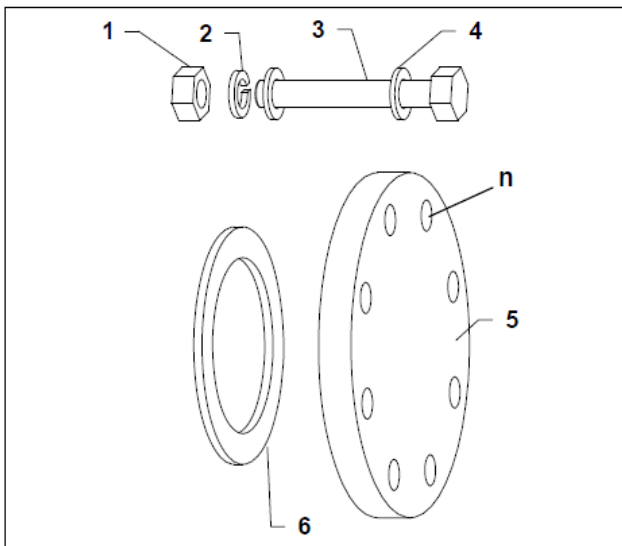
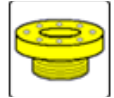

Item	Description	Material	DN50	DN80	DN100	DN200
1	Nut	SS	A-M16-A4	A-M16-A4	A-M16-A4	A-M20-A4
2	Spring Washer	SS	A-M16-VRO	A-M16-VRO	A-M16-VRO	A-M20-VRO
3	Bolt	SS	A-M16-90	A-M16-90	A-M16-90	A-M20-120
4	Washer	SS	A-M16-RON	A-M16-RON	A-M16-RON	A-M20-RON
5	Blind Flange	PP-GF	AG-DN-50B	AG-DN-80B	AG-DN-10B	AG-DN-20PPGF
6	Seal	NBR	A-2600-68	A-2600-71	A-2600-67	A-DN20-0D
			4	8	8	8
			19	19	20	41
			145	160	180	295
			185	200	220	340
			AG-DN-50L	AG-DN-80L	AG-DN-10L	A-3200-02C





PENTAIR

DECKEL & ADAPTERS



BLINDFLANGE

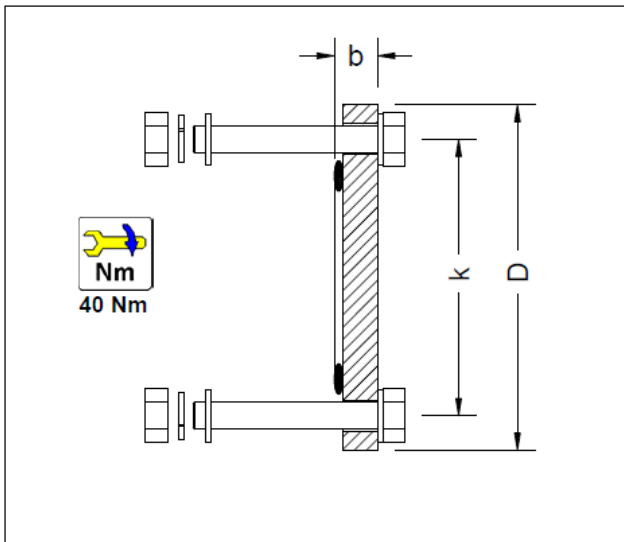
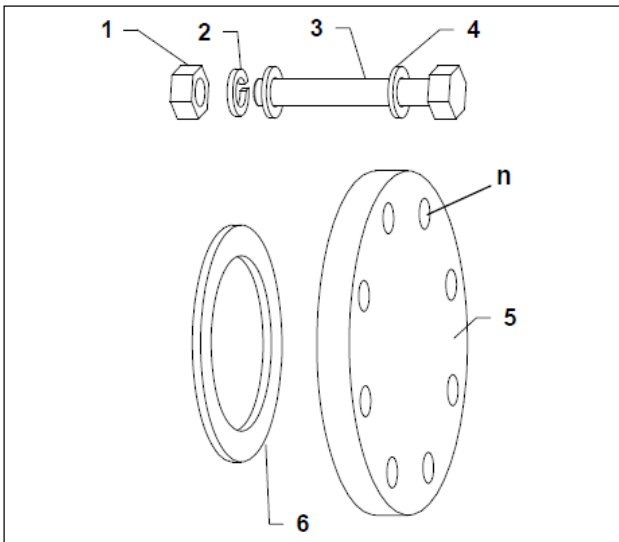
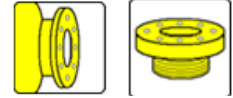

Item	Description	Material	DN50	DN80	DN100	DN200
1	Nut	SS	A-M16-A4	A-M16-A4	A-M16-A4	A-M20-A4
2	Spring Washer	SS	A-M16-VRO	A-M16-VRO	A-M16-VRO	A-M20-VRO
3	Bolt	SS	A-M16-90	A-M16-90	A-M16-90	A-M20-120
4	Washer	SS	A-M16-RON	A-M16-RON	A-M16-RON	A-M20-RON
5	Blind Flange	PP-GF/PVC	AG-DN-50B	AG-DN-80B	AG-DN-10B	A-3742-00
6	Seal	NBR	A-2600-68	A-2600-71	A-2600-67	A-DN20-0D
			4	8	8	8
			19	19	20	46
			145	160	180	295
			185	200	220	340
			AG-DN-50L	AG-DN-80L	AG-DN-10L	A-3200-01C



1



PENTAIR

DECKEL & ADAPTERS



BLINDFLANGE

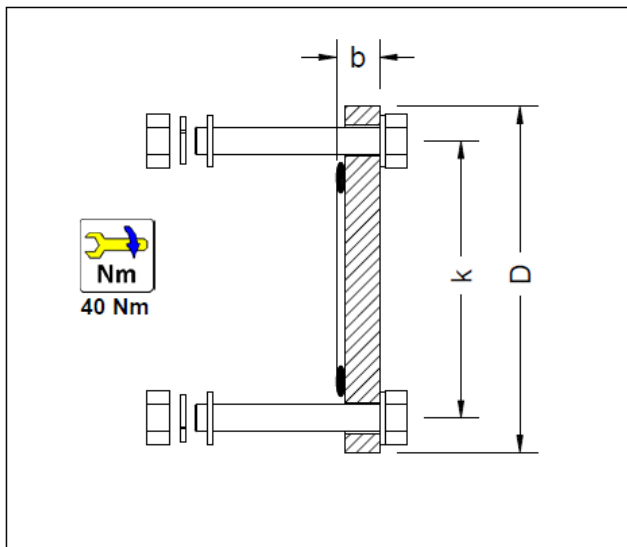
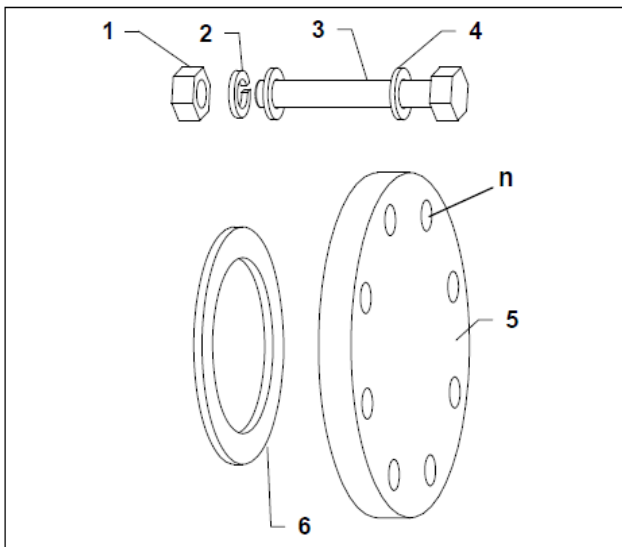
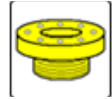
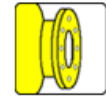

Item	Description	Material	DN50	DN80	DN100	DN200
1	Nut	SS	A-M16-A4	A-M16-A4	A-M16-A4	A-M20-A4
2	Spring Washer	SS	A-M16-VRO	A-M16-VRO	A-M16-VRO	A-M20-VRO
3	Bolt	SS	A-M16-90	A-M16-90	A-M16-90	A-M20-120
4	Washer	SS	A-M16-RON	A-M16-RON	A-M16-RON	A-M20-RON
5	Blind Flange	PP-GF	AG-DN-50B	AG-DN-80B	AG-DN-10B	AG-DN-20PPGF
6	Seal	NBR	A-2600-68	A-2600-71	A-2600-67	A-DN20-0D
			4	8	8	8
			19	19	20	41
			145	160	180	295
			185	200	220	340
			AG-DN-50L	AG-DN-80L	AG-DN-10L	A-3200-02C



1



PENTAIR

ENTLEERUNG ADAPTERS



6" FLANGE

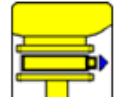

DRAIN

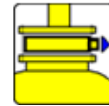
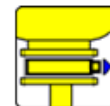
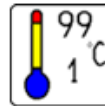

1" BSP

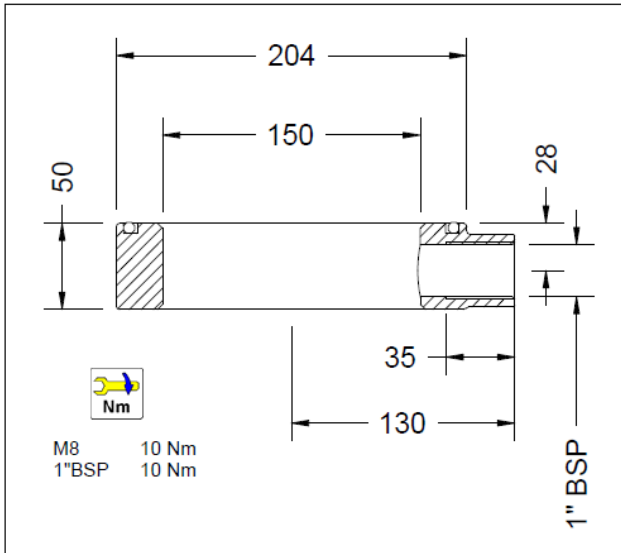
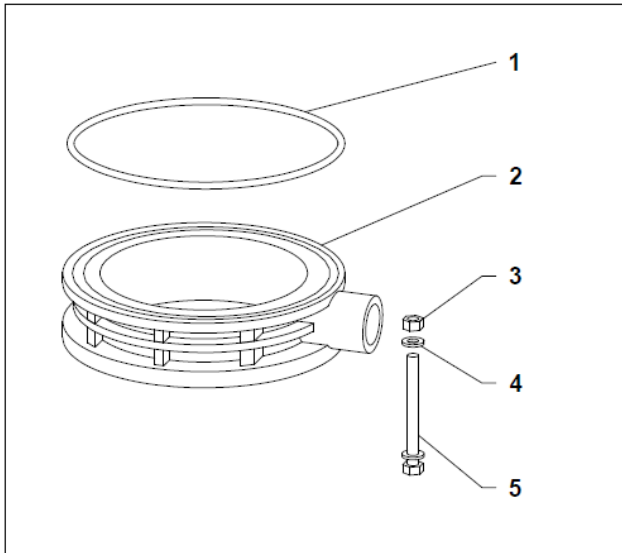



1" BSP

Item	Description	Dimensions	Quantity	Material	Part number
1	O-ring	183.52 x 6.99 mm	1	NBR	A-2694-8F
2	Drain insert	6" - 1" BSP	1	PPO	A-085-0002
3	Nut	M8	12	SS	A-M8-A4
4	Washer	M8	24	SS	A-M8-RON
5	Bolt	M8 x 120	12	SS	A-M8-120

 **A-DRAIN-1BSP**

1

ENTLEERUNG ADAPTERS



6" FLANGE

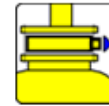
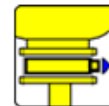
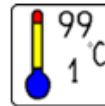
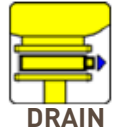
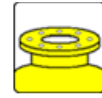

1" BSP

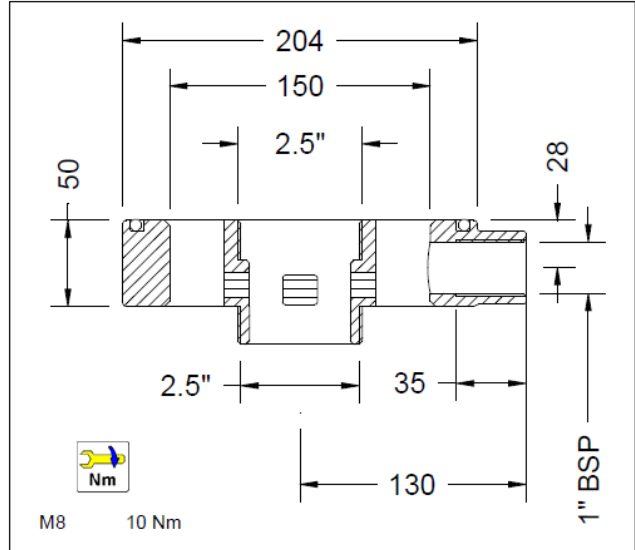
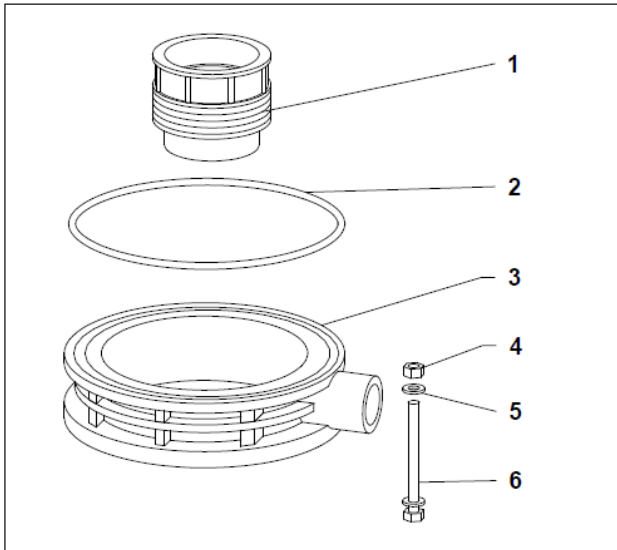

1" BSP
2.5"

Item	Description	Dimensions	Quantity	Material	Part number
1	Prolongation	2.5" – 50mm	1	PPO	A-3100-04C
2	O-ring	183.52 x 6.99 mm	1	NBR	A-2694-8F
3	Drain insert	6"-1"BSP	1	PPO	A-085-0002
4	Nut	M8	12	SS	A-M8-A4
5	Washer	M8	24	SS	A-M8-RON
6	Bolt	M8 x 120	12	SS	A-M8-120



1

A-DRAIN-LF

ENTLEERUNG ADAPTERS



6" FLANGE

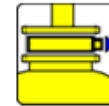
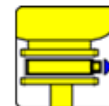
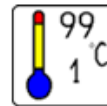
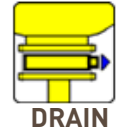
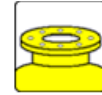

1" BSP

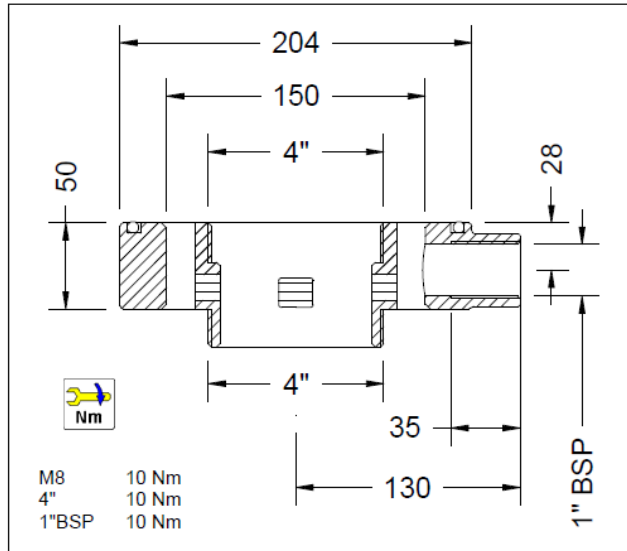
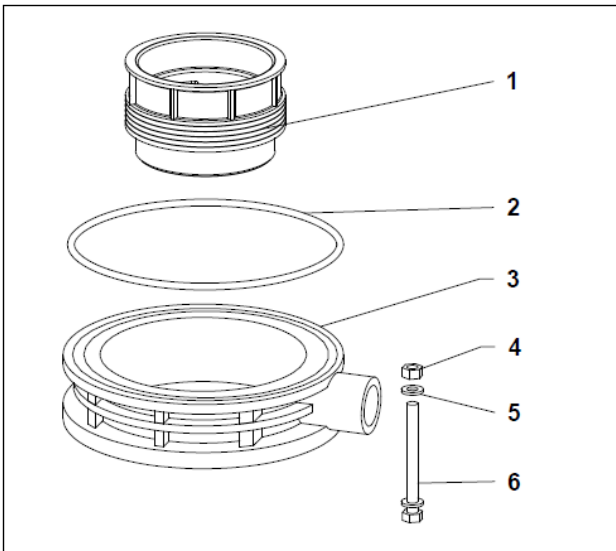

1" BSP
4"

Item	Description	Dimensions	Quantity	Material	Part number
1	Prolongation	4" – 50mm	1	PPO	A-3100-05C
2	O-ring	183.52 x 6.99 mm	1	NBR	A-2694-8F
3	Drain insert	6"-1" BSP	1	PPO	A-085-0002
4	Nut	M8	12	SS	A-M8-A4
5	Washer	M8	24	SS	A-M8-RON
6	Bolt	M8 x 120	12	SS	A-M8-120



1

A-DRAIN-HF



SIGHTGLASS

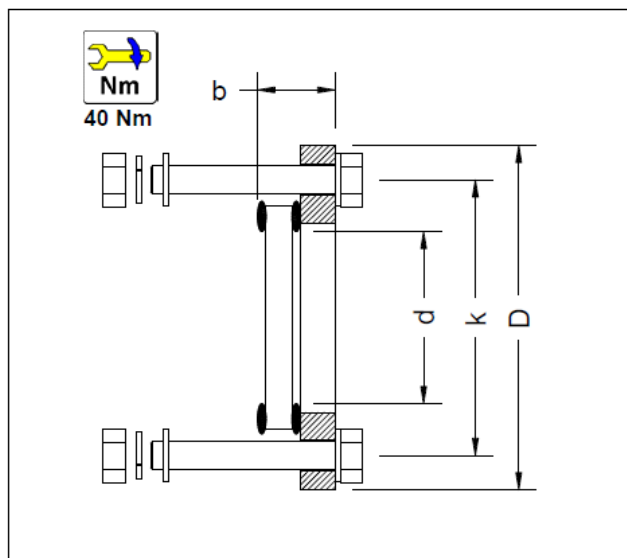
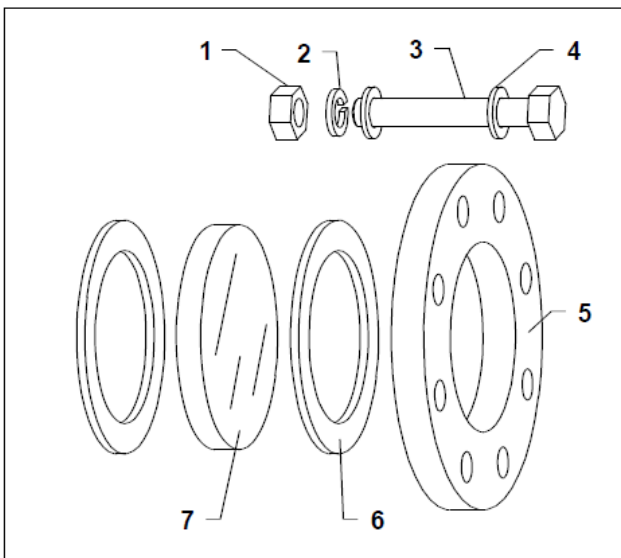
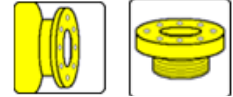

Item	Description	Quantity	Material	DN80	DN100
				Part number	
1	Nut	8	SS	A-M16-A4	A-M16-A4
2	Spring Water	8	SS	A-M16-VRO	A-M16-VRO
3	Bolt	8	SS	A-M16-110	A-M16-110
4	Washer	16	SS	A-M16-RON	A-M16-RON
5	Backing Flange	1	PP-GF	X-1V-IP80	X-0D-N101
6	Seal	1	NBR	A-2600-71	A-2600-67
7	Sightglass	1	GLASS	A-KIJK-80	A-KIJK-100
				45	45
				100	115
				200	220
				160	180
				A-SGHT-DN80	A-SGHT-DN100



1



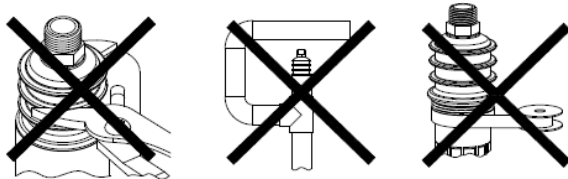
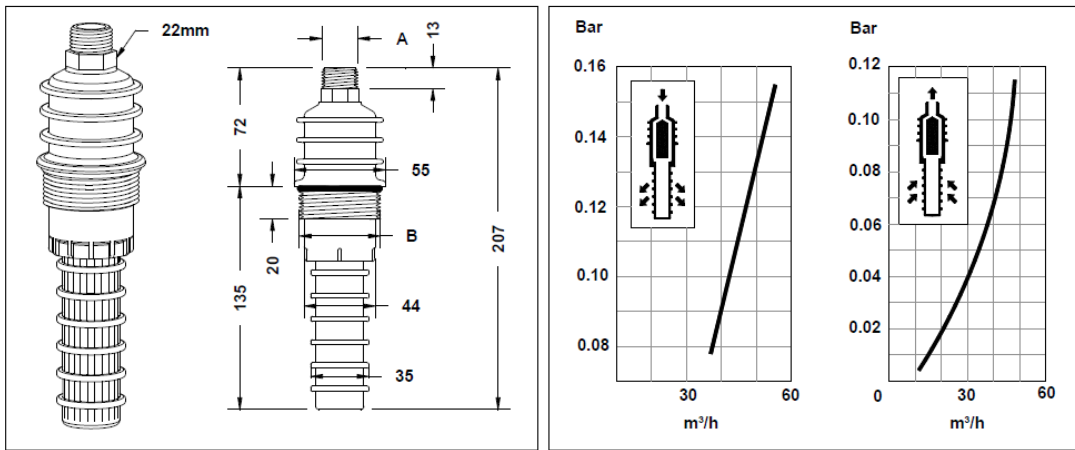

AERATION VALVE

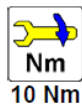
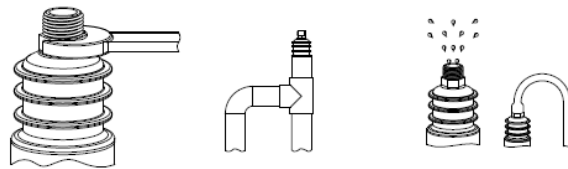

AERATION VALVE

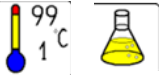

Item	Thread A	Thread B	Material	 1
	1/2" BSP	1 1/2" BSP	PP-GF/EPDM	A-AV-150PP
	1/2" NPT	1 1/2" NPT	PP-GF/EPDM	
	1/2" BSP	1 1/2" BSP	PVDF/FPM	A-AV-150PVDF
	1/2" NPT	1 1/2" NPT	PVDF/FPM	

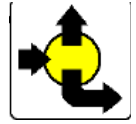

AERATION VALVE

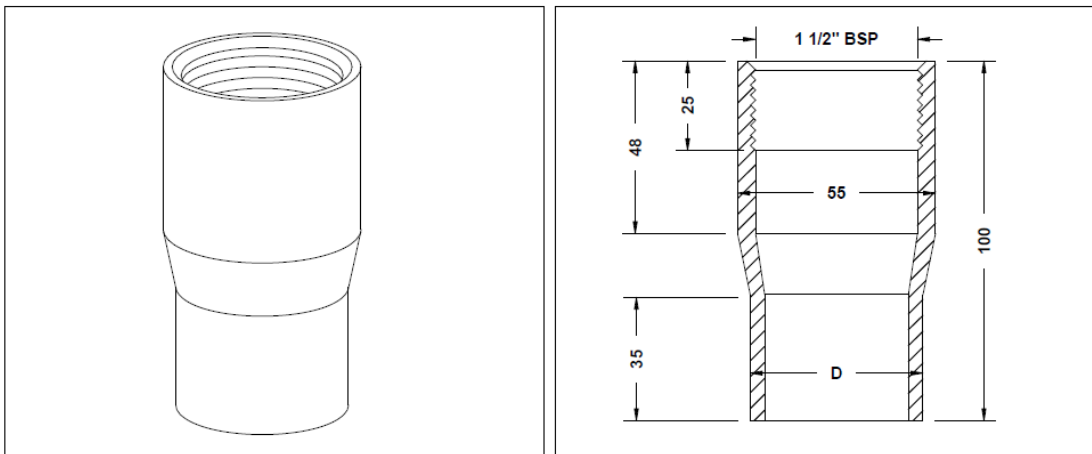

ADAPTER FOR AERATION VALVE

D		Description	Material	 1
48mm		1 1/2" BSP - 48 mm	PVC	A-AV-AD48
50mm		1 1/2" BSP - 50 mm	PVC	A-AV-AD50



2.5" VALVE

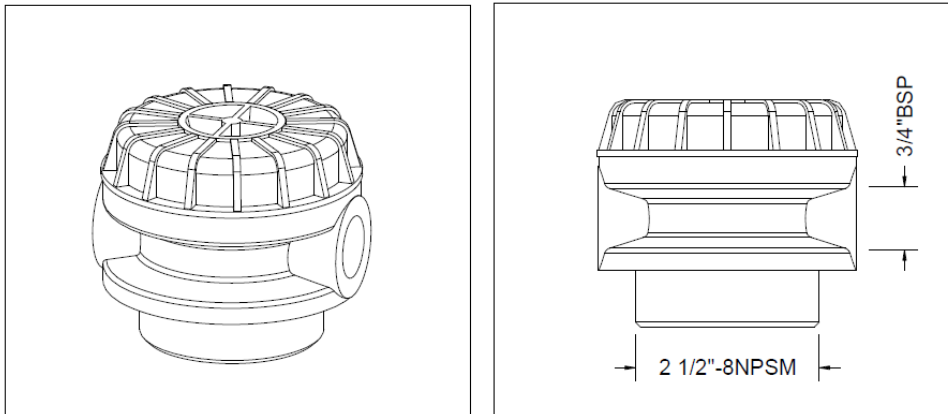
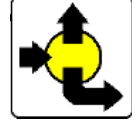

MANUAL VALVE

Type	Thread A	Thread B	Material	 1
	2.5" - 8 NPSM	3/4" BSP	PP	A-ANA-25-G3/4



WRENCHES

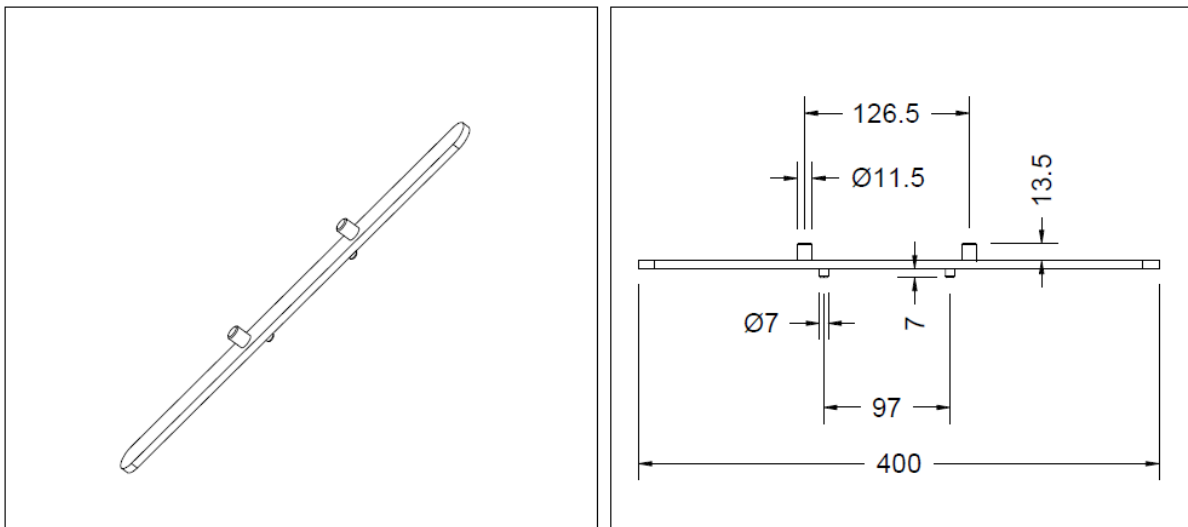
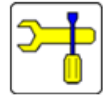

NOTCHED WRENCH FOR ADAPTERS

Item	Description	Dimensions	Quantity	Material	Part number
1	Notched wrench for adapters	Ø7 x 97 Ø11.5 x 126.5	1	STEEL	I-WR01-AD
					
					
			1		I-WR01-AD



WRENCHES

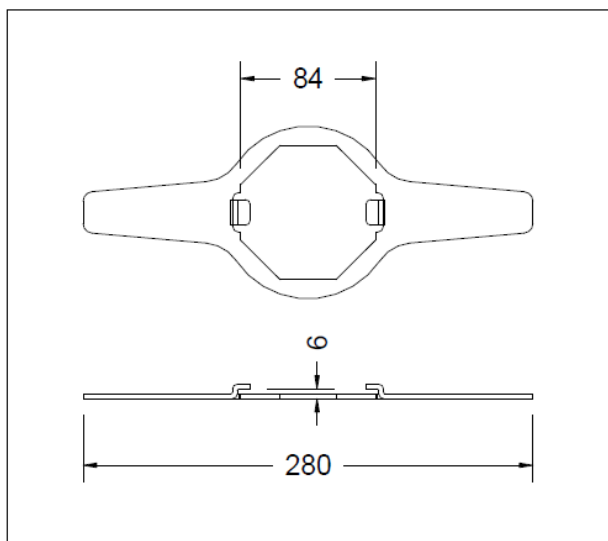
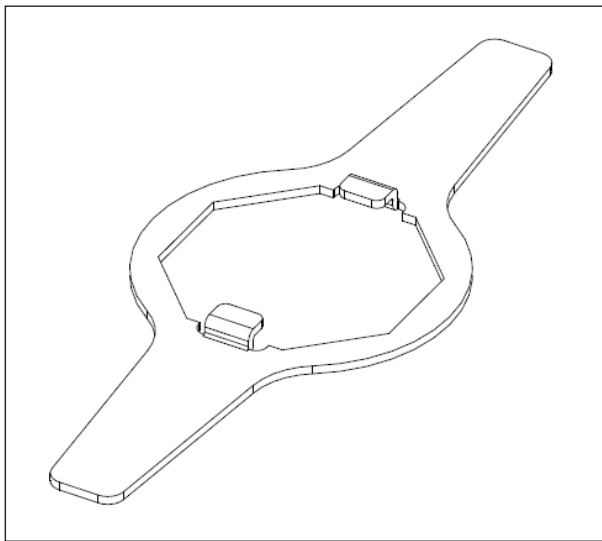
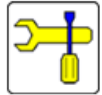

OCTOGONAL WRENCH FOR ADAPTERS
2.5" - 84 MM

Item	Description	Dimensions	Quantity	Material	Part number
1	Octagonal wrench for adapters	2.5" - 84 mm	1	PVC	I-WR05-AD
					 I-WR05-AD
					1



WRENCHES

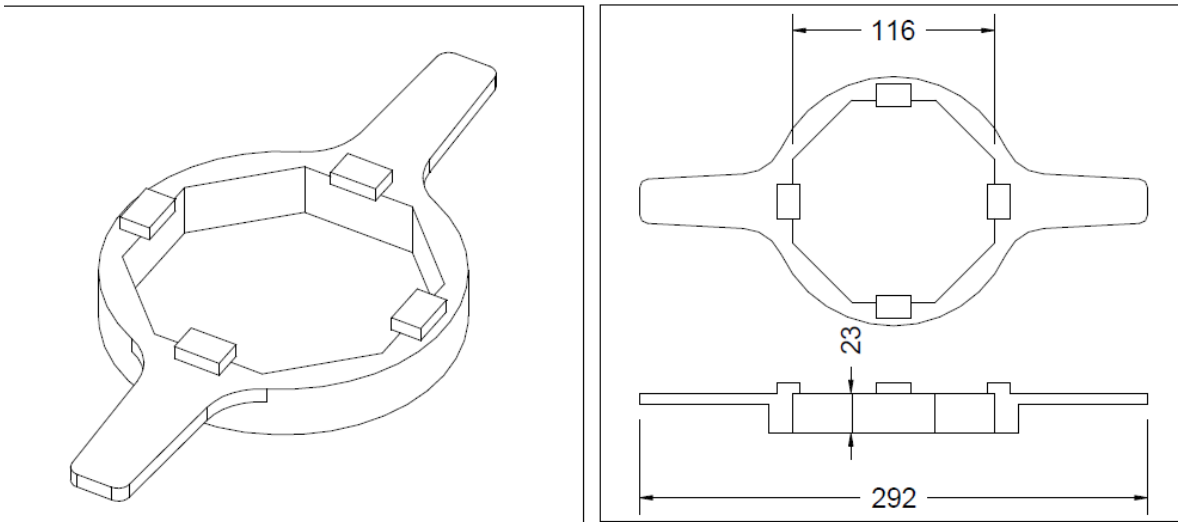
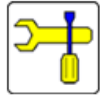

OCTAGONAL WRENCH FOR ADAPTERS
4" - 116 MM



Item	Description	Dimensions	Quantity	Material	Part number
1	Octagonal wrench for adapters	4" - 116 mm	1	PVC	I-WR06-AD



1

I-WR06-AD



WRENCHES

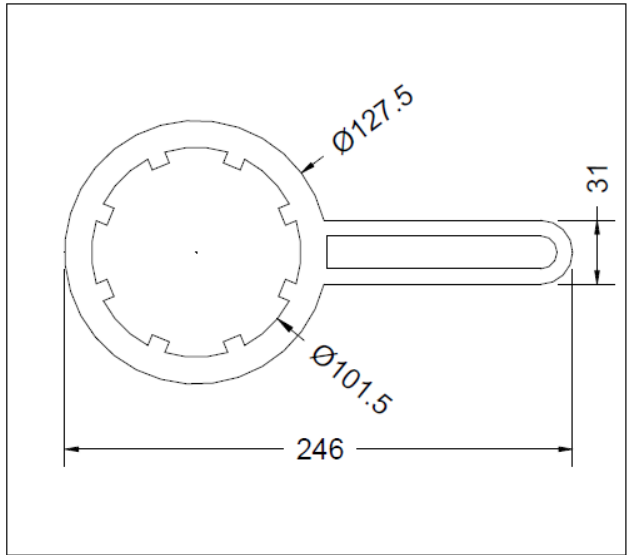
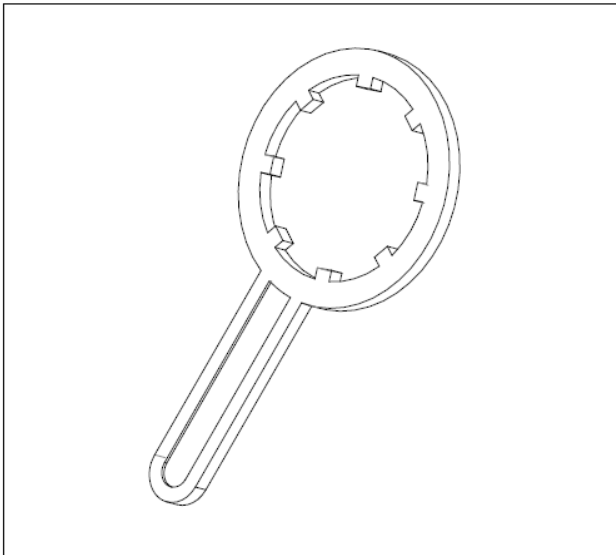

WRENCH FOR MANUAL VALVE



Item	Description	Dimensions	Quantity	Material	Part number
1	Wrench for manual valve	101.5	1	PP	A-ANA-S



1

A-ANA-S



EXTENSION

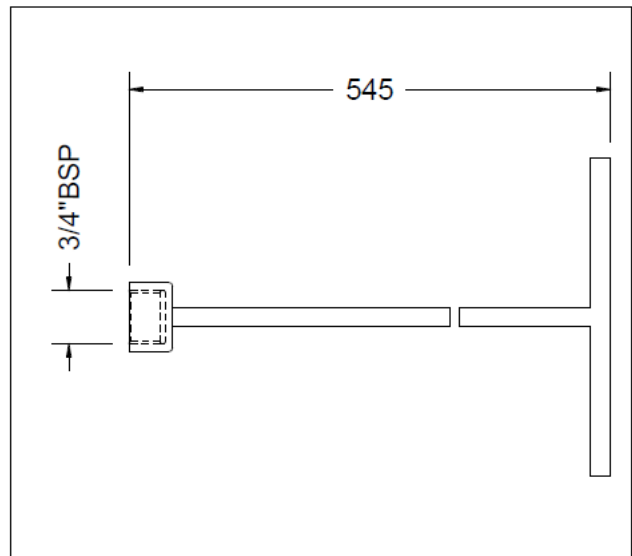
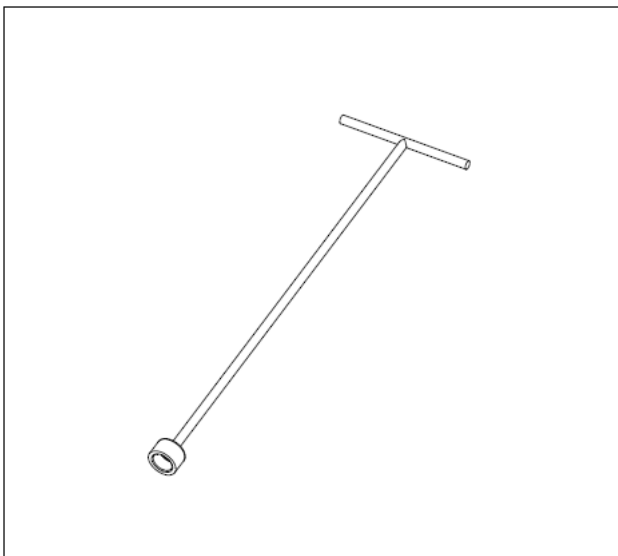
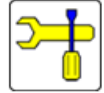

EXTENSION
3/4" BSP



Item	Description	Dimensions	Quantity	Material	Part number
1	Extension	3/4" BSP	1	STEEL	I-WR03-LA



1

I-WR03-LA



EXTENSION

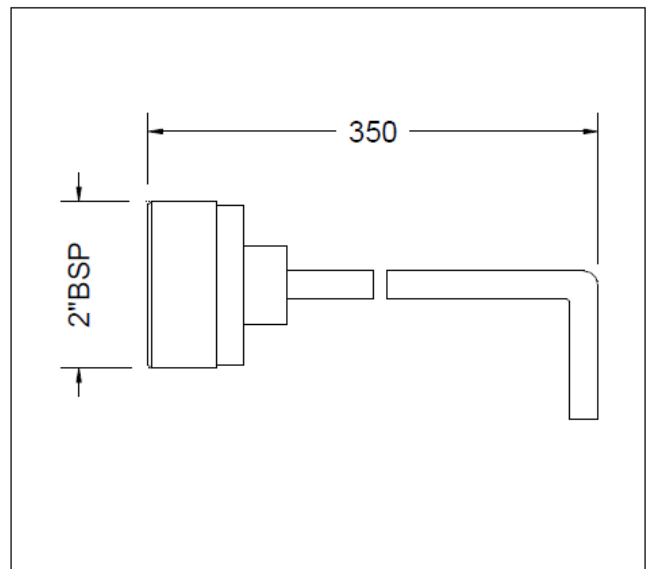
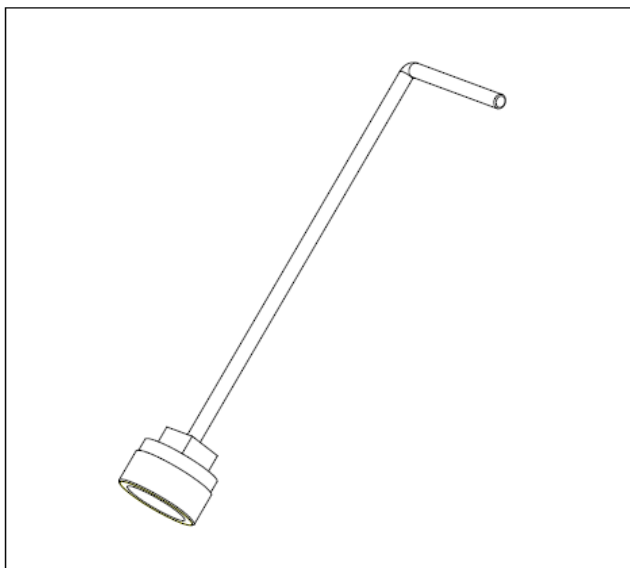
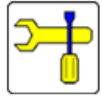

EXTENSION
2" BSP

Item	Description	Dimensions	Quantity	Material	Part number
1	Extension	2" BSP	1	STEEL	I-WR02-LA
					 1



EXTENSION

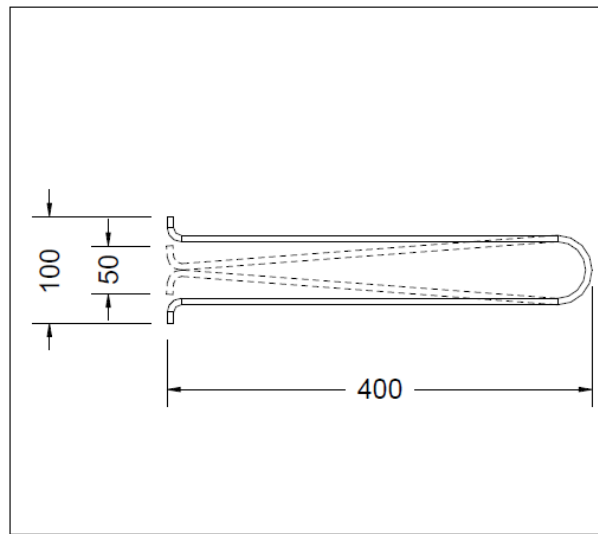
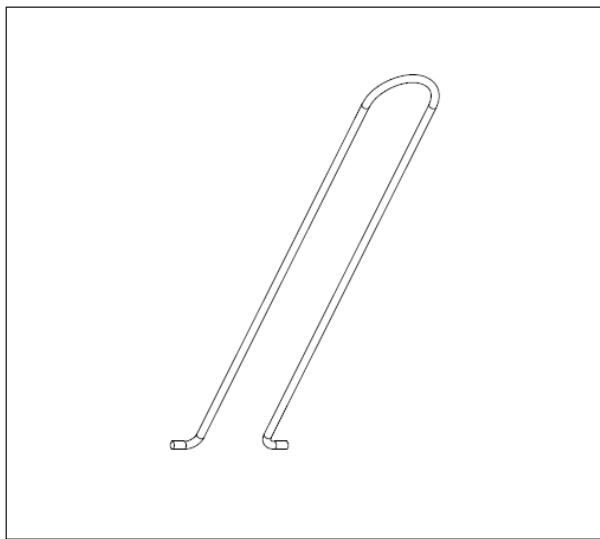
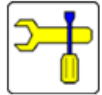

EXTENSION 6-8 HUBS

Item	Description	Dimensions	Quantity	Material	Part number
1	Extension	6-8-HUBS	1	STEEL	I-WR04-LA



1

I-WR04-LA



PENTAIR

ZUBEHÖRTEILE



HUB

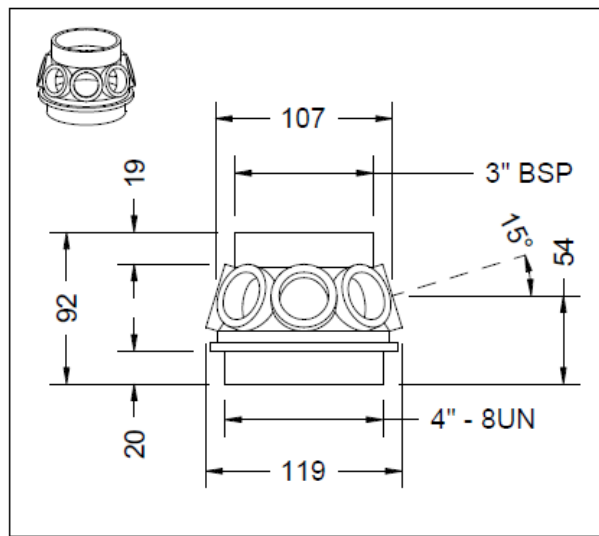
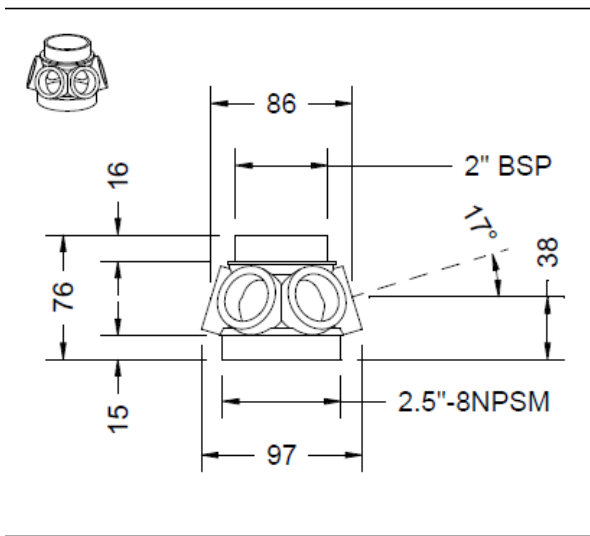

		Dimensions	Material	Part number
		Hub (6)	PP	AB-H60-00
		Hub (8)	PP	ATD-H60-00
		Hub (6)	PP-GF	ATD3-H60-00
		Hub (8)	PP-GF	ATD3-H80-00
		Hub (6)	PVDF	ATD1-H60-00
		Hub (8)	PVDF	ATD1-H80-00



HUBCAP

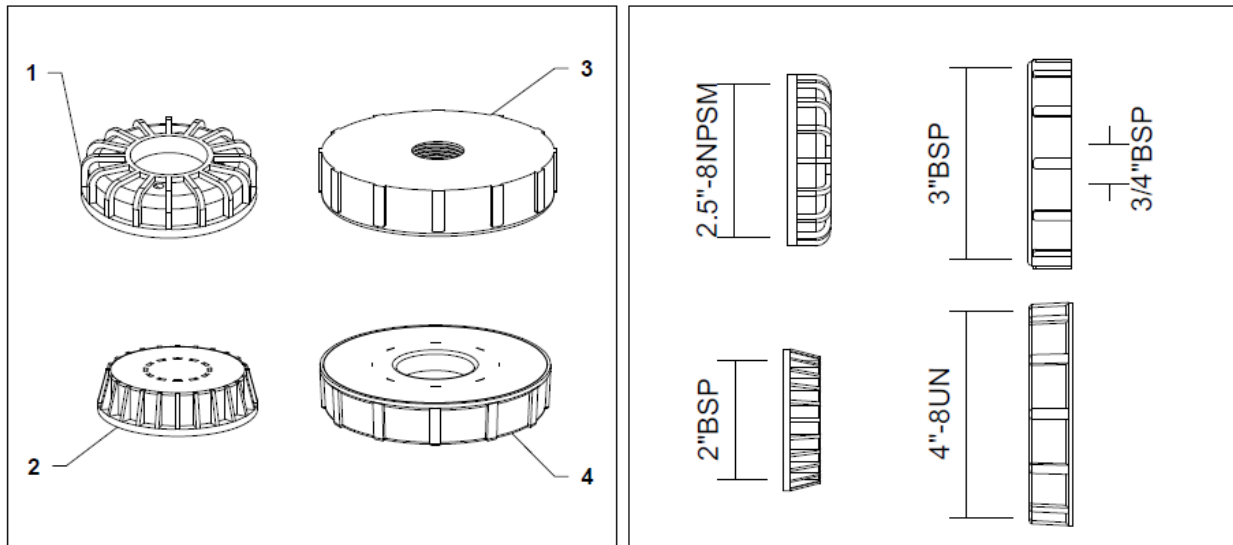



Item	Description	Part number		
		PP	PP-GF	PVDF
1	2.5" - 8 NPSM	AC-H60-00	AC3-H60-00	AC1-H60-00
2	2" BSP	AD-H60-00	AD3-H60-00	AD1-H60-00
3	3" BSP - 3/4" BSP	A-BTC8-30	A3-BTC8-30	A1-BTC8-30
4	4" - 8 UN	AD-H80-00	AD3-H80-00	AD1-H80-00

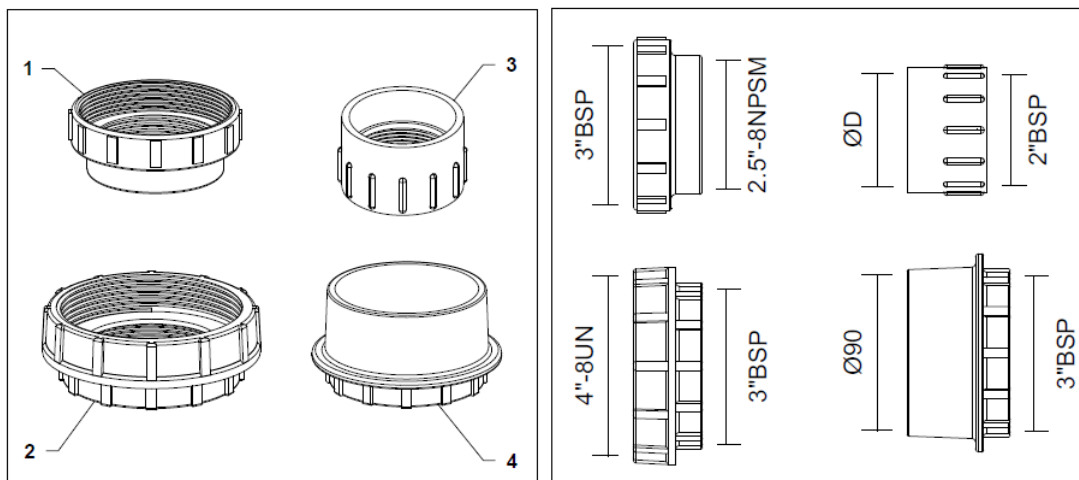

HUBADAPTER

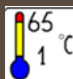
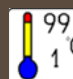

Item	Description	 PVC PP (*)			 PP-GF			 PVDF		
		Part number								
1	2.5" - 8 NPSM / 3" BSP	AB-C08-30*	AB3-C08-30	AB1-C08-30						
2	3" BSP / 4" -8 UN	AB-C08-40*	AB3-C08-40	AB1-C08-40						
3	2" BSP / D = 50mm	A-2600-63	-	-						
3	2" BSP / D = 60mm	A-1075-1	-	-						
3	2" BSP / D = 63mm	A-1074-1	-	-						
4	3" BSP / 90mm	AB-GC8-30	-	-						



PENTAIR

ZUBEHÖRTEILE



LATERAL

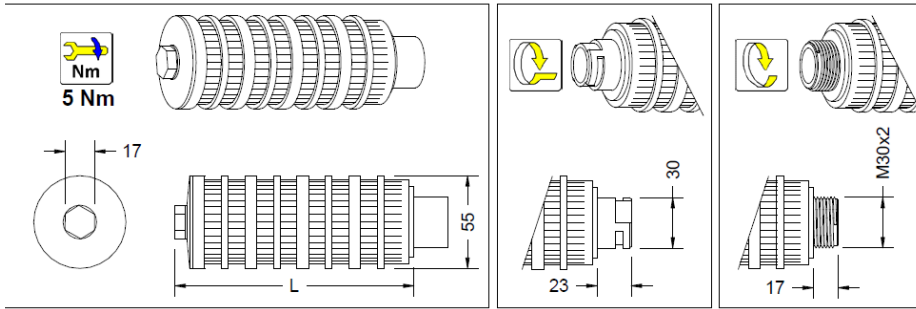

			PVDF	White
			PP-GF PPO	Black
			PP	Gray
			PP	Yellow

L (mm) Length							
113	A-BT02-113	A-BT05-113	A-TH02-113	A-TH05-113	A3-TH02-113	A1-TH02-113	6
175	A-BT02-175	A-BT05-175	A-TH02-175	A-TH05-175	A3-TH02-175	A1-TH02-175	6
268	A-BT02-268	A-BT05-268	A-TH02-268	A-TH05-268	A3-TH02-268	A1-TH02-268	6
330	A-BT02-330	A-BT05-330	A-TH02-330	A-TH05-330	A3-TH02-330	A1-TH02-330	6
361	-	-	A-TH02-361	A-TH05-361	A3-TH02-361	A1-TH02-361	8
423	-	-	A-TH02-423	A-TH05-423	A3-TH02-423	A1-TH02-423	8
485	-	-	A-TH02-485	A-TH05-485	A3-TH02-485	A1-TH02-485	8
515	-	-	A-TH02-515	A-TH05-515	A3-TH02-515	A1-TH02-515	8
578	-	-	A-TH02-578	A-TH05-578	A3-TH02-578	A1-TH02-578	8



DIFFUSOR



Nm
5 Nm

 	 	 	 White	 Gray	 Yellow
----------	----------	----------	-----------	----------	------------

T2 (mm) Thread	T1(mm) Thread	h (mm) Height	L (mm) Length					
2" BSP	ø50	30	126	A-2721-26	-	-	-	1
2" BSP	ø50	30	180	A-2721-80	A-2600-65	A1-2742-BSP	-	1
2.5" - 8 NPSM	2" BSP	20	180	A-2740--	A-2746--	A1-2740--	-	1
2.5" - 8 NPSM	2" BSP	20	338	-	A-2746-338	-	-	1



PENTAIR

ZUBEHÖRTEILE



UNION

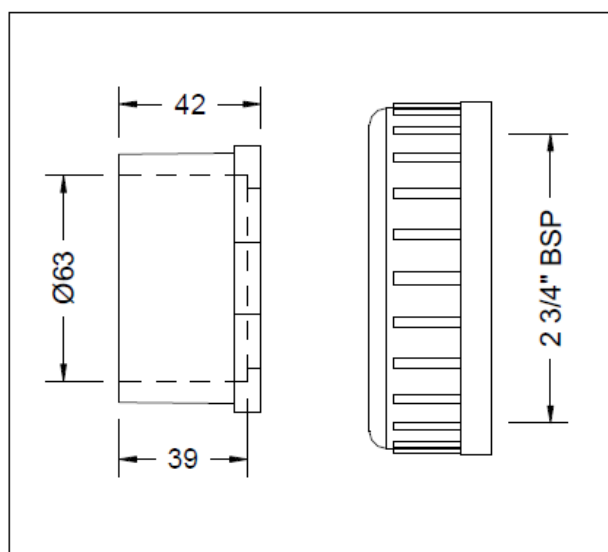
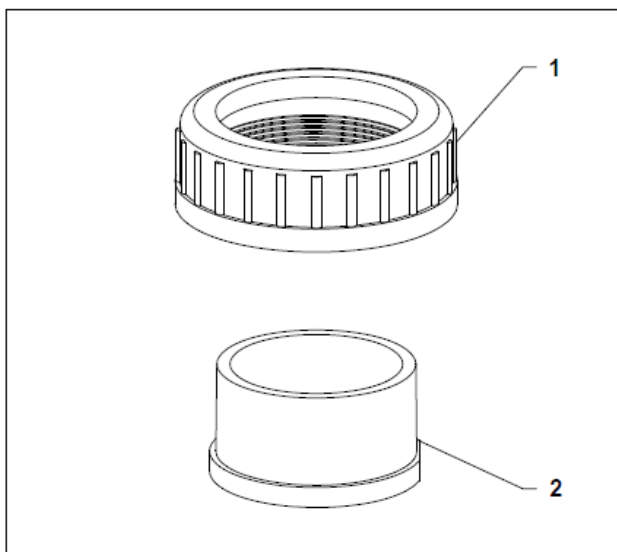

Item	Description	Material	Part number
1	Collat	PVC	A-8250-63
2	Union nut	PVC	A-8200-63



5

A-8200-63C



ELBOW

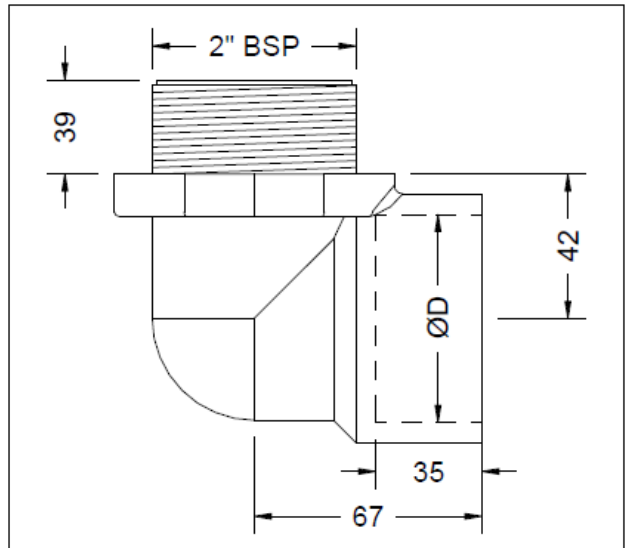
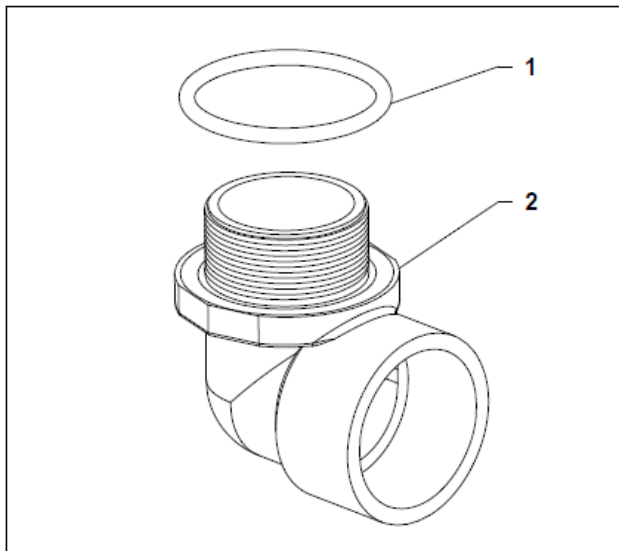

Item	Description	Material	D= 60 mm	D= 63 mm
			Part number	
1	O-ring	NBR	A-2694-17	A-2694-17
2	Elbow	PVC	A-2700--	A-2693--
			A-2700-C	A-2693-C



5



O'RING

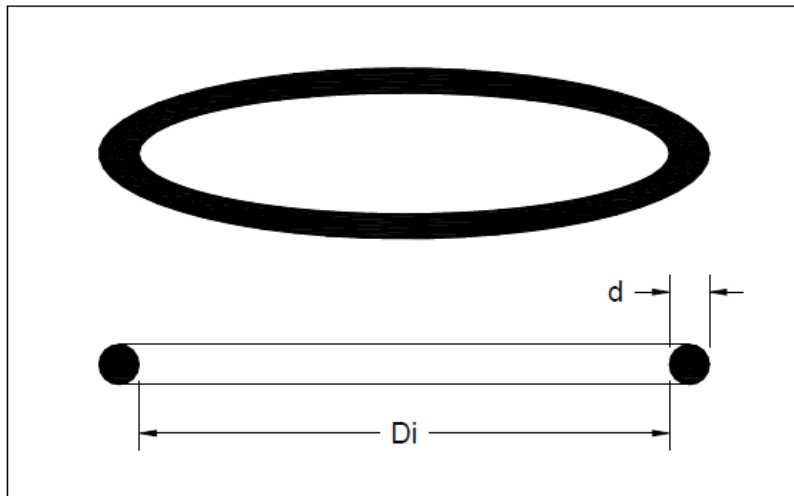

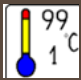
Di	d	AS-N°			 		
			NBR	EPDM	FPM	FEP	
56.52	5.33	AS331	A-2694-60	-	-	-	20
66.04	5.33	AS334	A-2694-17	-	-	-	20
68	3.53	-	-	A-2694-1	-	-	20
98	4	-	A-2694-3	-	-	-	20
110	4	-	A-2694-3F	-	-	-	20
115	5	-	A-2694-BF	-	-	-	20
145.64	3.53	AS256	A-2694-19	-	-	-	20
183.52	6.99	AS442	A-2694-8F	-	A-2694-V8F	A-2694-F8F	20



FLAT SEAL

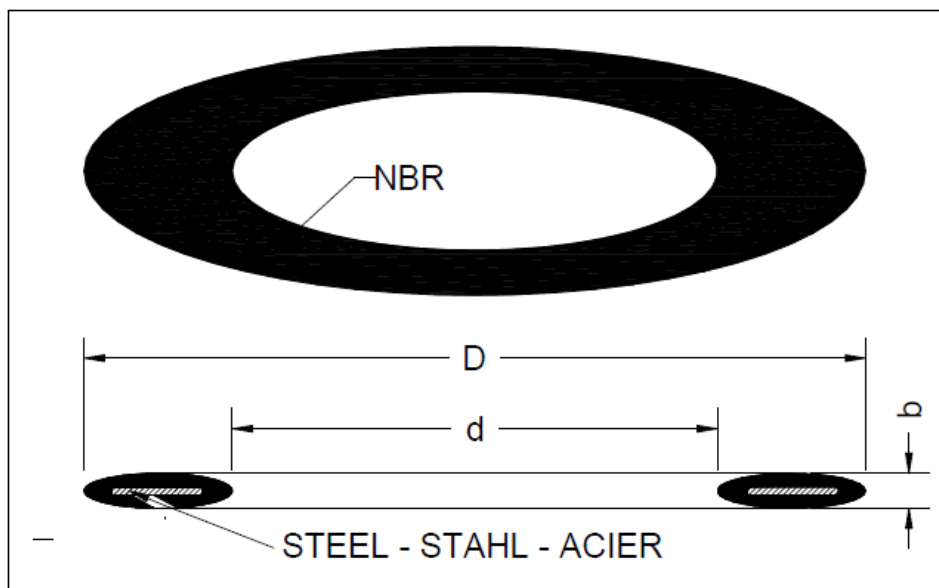

DN DIN2690	D	d	b	Part Number	
DN50	107	61	4	A-2600-68	10
DN65	127	77	4	-	10
DN80	142	90	4	A-2600-71	10
DN100	162	115	5	A-2600-67	10
DN125	192	141	5	-	5
DN150	218	169	5	A-DN15-0D	5
DN200	273	220	6	A-DN20-0D	5
DN300	378	325	6	A-DN30-0D	5
DN400	490	420	7	A-DN40-0D	5

Kontakt:

Per E-Mail

Kommerzielle Unterstützung

commercial.prfemea@pentair.com

Technische Unterstützung

techsupport.water@pentair.com

Marketing-Unterstützung

marketing.prfemea@pentair.com

Per Telefon

Tel. +41 21 623 69 69