



PENTAIR

STRUCTURAL
ACCESORIOS & PIEZAS DE
RECAMBIO DE LAS BOTELLAS

WATER PURIFICATION

TANKS & SYSTEMS



TABLA DE CONTENIDOS

MATERIALES	5
POLÍMEROS	5
GOMAS/ELASTÓMEROS	6
METALES	6
GUÍA DEL USUARIO	7
DESCRIPTIVO	7
SÍMBOLOS E ICONOS	8
INSTRUCCIONES	9
INSTRUCCIONES DE INSTALACIÓN	9
MONTAJE DE BRIDAS	9
MONTAJE.....	10
ACCESORIOS	
CIERRE & ADAPTADORES	
ROSCA DE 2.5"	
2.5" CLOSURE PVC	11
ROSCA DE 4"	
DN 400	12
4" CLOSURE PVC	13
4" - 2.5" ADAPTER.....	14
ROSCA DE 6"	
6" CLOSURE PVC	15
BRIDA DE 6"	
6" BLINDFLANGE	16
6" BLINDFLANGE ULTRA PURE	17
6" FLANGE - 1.5 BSP	18
6" FLANGE - 2.5" 8UN	19
6" FLANGE - 4" 8UN	20
6" FLANGE - DN65	21
6" FLANGE - DN80	22
6" FLANGE - DN100	23



BRIDAS CIEGAS

DN50 FLANGE	24
DN65 FLANGE	25
DN80 FLANGE	26
DN100 FLANGE	27
DN125 FLANGE	28
DN150 FLANGE	29
DN200 FLANGE	30
DN400 FLANGE	31

INSERCIÓN DE DRENAJE

BRIDA DE 6"

1" BSP OUTLET STANDARD	32
1" BSP OUTLET LOW FLOW	33
1" BSP OUTLET HIGH FLOW	34

MIRILLA

SIGHTGLASS	35
------------------	----

VÁLVULAS

VÁLVULAS DE AIREACIÓN

1.5" AERATION VALVE	36
ADAPTER FOR AERATION VALVE 1.5"	37

VÁLVULAS 2.5"

2.5" VALVE MANUAL VALVE - 3/4" INLET/OUTLET	38
---	----

HERRAMIENTAS

LLAVES

NOTCHED WRENCH FOR ADATORS	39
OCTOGON 2.5"	40
OCTOGON 4"	41
WRENCH FOR MANUAL VALVE	42

EXTENSIONES

EXTENSION 3/4 BSP	43
EXTENSION 2" BSP	44
EXTENSION HOLDER 6-FOLD HUB	45



PIEZAS DE RECAMBIO EJE & EJE DE CONEXIÓN

HUB	46
HUBCAP	47
HUB ADAPTORS	48
LATERAL	49
DIFFUSOR	50
UNION	51
ELBOW	52

JUNTAS

O'RING	53
FLAT SEAL.....	54



MATERIALES

POLÍMEROS

POLIETILENO (PE)

PE es el material empleado para el revestimiento interior de los recipientes Structural estándar, además de en diversos cierres y adaptadores recogidos en este catálogo.

Propiedades típicas:

- Ligeros.
- Altamente resistentes y con capacidad de alargamiento previo a la rotura.
- Muy baja absorción de agua y permeabilidad.
- Alta resistencia al ataque de productos químicos.
- Resistencia al agrietamiento por tensión ambiental.

POLIPROPILENO (PP)

Material moldeado por inyección para laterales estándar, cubos y adaptadores de cubo

Propiedades típicas:

- Propiedades similares al PE.
- Mayor resistencia a la temperatura que el PE.
- El PP es quebradizo en condiciones de frío (menos de 10 °C) (preste atención durante el montaje en frío).

POLIPROPILENO REFORZADO CON FIBRA DE VIDRIO (PP-GF)

Material moldeado por inyección para laterales sometidos a altas temperaturas, adaptadores de cubo. El PP-GF presenta una rigidez muy superior a la del PP normal.

POLIFENILENOXIDO (PPO)

Material moldeado por inyección para bridas típicas y cierres embridados. El PPO se emplea como producto lleno de vidrio al 30%.

Propiedades típicas:

- Alta estabilidad dimensional.
- Resistente a altas temperaturas (hasta 99 °C).
- Buena resistencia a la hidrólisis.
- Autoextinguible, sin goteo.
- Baja absorción de agua.

FLUORURO DE POLIVINILIDENO (PVDF)

Revestimientos y componentes para aplicaciones ultrapuras. El PVDF es un polímero técnico de alto grado con excelentes propiedades (químicas).

Propiedades típicas:

- Alta dureza y capacidad de alargamiento previo a la rotura a altas y bajas temperaturas.
- Muy alta resistencia al ataque de la mayoría de productos químicos.
- Idóneo para aplicaciones ultrapuras
- Alta resistencia mecánica.



POLIVINILCLORURO (PVC)

Polímero ampliamente utilizado en sistemas de transporte de agua, además de en otras aplicaciones. El PVC es uno de los plásticos más utilizados en el mundo. Usos estructurales del PVC en ciertas piezas moldeadas por inyección y mecanizadas de sistemas de distribución.

Propiedades típicas:

- Alta rigidez y dureza y resistencia mecánica.
- Resistencia al choque a bajas temperaturas.
- Alta resistencia química.
- Autoextinguible tras retirar la fuente de ignición.

EPOXI REFORZADO CON FIBRA DE VIDRIO (EP-GF)

Material termoendurecible con una muy alta resistencia. Este plástico, lleno de vidrio hasta el 60%, se aproxima a la resistencia del aluminio, pero con una proporción resistencia-peso aún mayor. No está pensado para entrar en contacto con el contenido del recipiente y se utiliza exclusivamente como elemento de refuerzo.

Propiedades típicas:

- Muy alta resistencia y durabilidad.
- Solo elementos estructurales.



PENTAIR

INTRODUCTION



GOMAS/ELASTÓMEROS

ACRILONITRILO BUTADIENO (NBR)

Compuesto de goma para fines generales

TERPOLÍMERO DE ETILENO PROPILENO DIENO (EPDM)

Compuesto de goma con una mejor resistencia térmica y química que el grado NBR estándar.

ELASTÓMERO DE CARBONO FLUORADO (FPM)

Grado especial (Viton®) para aplicaciones específicas. Apto para la mayoría de aplicaciones ultrapuras o altamente corrosivas.



TETRAFLUOROETILENO/ HEXAFLUOROPROPILENO (FEP)

Material de muy alto rendimiento para juntas tóricas. De hecho, los sellos de FEP están compuestos de un núcleo interno de FPM, que proporciona la flexibilidad necesaria, revestido de una capa de Teflón® (PFA) sin fisuras.

Empleado allí donde las propiedades químicas, toxicológicas y térmicas son de la máxima importancia.



METALES

ACERO INOXIDABLE (SS)

Todos los pernos están fabricados en acero inoxidable de grado A2 (1.4303-1.4301-1.4541) y todas las tuercas, arandelas, arandelas elásticas, etc. son de grado A4 (1.4401-1.4571).

ALUMINIO (AL)

Metal resistente a la corrosión y muy ligero destinado a la construcción de las bridas fabricadas para recipientes a presión STRUCTURAL.

Para obtener uno o más materiales y agentes de una resistencia química específica, contacte con nuestro departamento de ventas. Estaremos encantados de aconsejarle. Especifique exactamente el compuesto químico, junto con su concentración y temperatura.



PENTAIR

INTRODUCTION



GUÍA DEL USUARIO

DESCRIPTIVO

1

14" - 16" - 18"

2



6" FLANGE

6



8

7

DN65

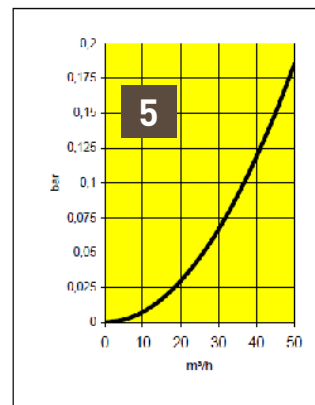
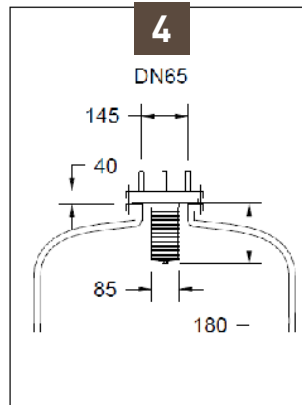
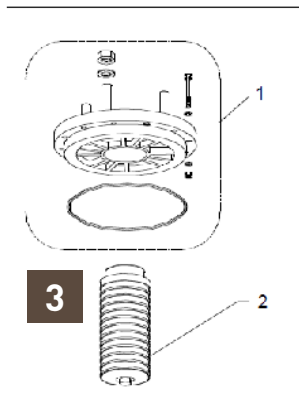

9



10

Item	Description	11	Dimensions	Quantity	Matière	N° d'article	
1	Adaptor		6" - DN65	1	PP	A-3100-02C	A-3100-02C
2	Diffusor		2.5" - 180mm	1	PP	A-2740--	A-2746--
						A-2727-F6	A-2527-F6

12



1

13

1	Diameter of vessel	8	System connection
2	Vessel connection	9	Type of lateral connection
3	Exploded View	10	Lateral slot size
4	Dimensions	11	Spare parts list
5	Pressure drop curve	12	Minimum order quantity
6	Operating temperature	13	Codes
7	Type of installation		



SÍMBOLOS E ICONOS



Sistema de bayoneta



Sistema roscado



Tamaño de ranura: 0,2 mm



Tamaño de ranura: 0,3 mm



Tamaño de ranura: 0,5 mm



Tamaño de ranura: 12 mm



Sistema o componente para recipientes embridados



Sistema o componente para recipientes roscados



Cierres embridados o roscados



Adaptadores embridados o roscados



Bajantes



Herramientas y ayudas de montaje



Sistema para instalación sobre el recipiente embridado



Sistema para instalación bajo el recipiente embridado



Sistema para instalación en el recipiente embridado superior



Sistema o componente apropiado desde 1 °C hasta 50 °C



Sistema o componente apropiado desde 1 °C hasta 65 °C



Sistema o componente apropiado desde 1 °C hasta 99 °C



Conexión de sistema exterior



Función del adaptador de ... a ...



Aplicar adhesivo en la conexión



Piezas de recambio



Sistema o componente apropiado para aplicaciones ultrapuras



Especificación de par máximo



Cantidad de pedido mínima



Sistema para instalación sobre el recipiente enroscado



Sistema para instalación bajo el recipiente enroscado



Sistema para instalación en el recipiente enroscado superior



Sistema para instalación en el recipiente embridado superior con orificio lateral



PENTAIR

INTRODUCTION



INSTRUCCIONES

INSTRUCCIONES DE INSTALACIÓN

- Busque daños de transporte en las piezas antes de proceder a su montaje e instalación.
- Proteja los componentes de la congelación 0 °C [32 °F].
- Se recomienda el precalentamiento de las piezas con agua caliente para montajes realizados a menos de 10 °C [50 °F].
- Par máximo a 5 Nm [3,69 pies/libras].

MONTAJE DE BRIDAS

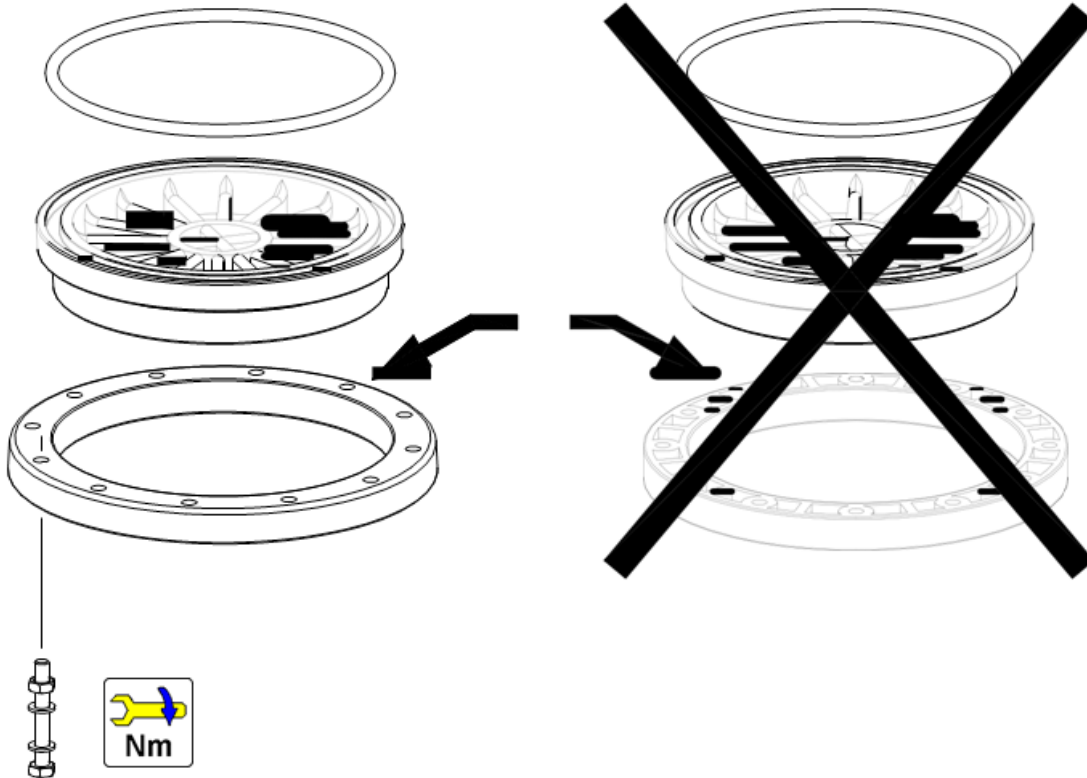



MONTAJE



Paso 1: Piezas desmontadas con la extensión I-WR03-LA.



Paso 2: Las piezas mostradas en el Paso 1 se montan (fuera del depósito) y se introducen en este mediante la extensión I-WR03-LA.



Paso 3: Coloque el montaje en el interior del depósito para montar los laterales.



Paso 4: Atornille todos los laterales al cubo mientras continúa sujetando la extensión.



Paso 5: Atornille el adaptador de brida al conjunto. Asegúrese de que la junta tórica esté correctamente fijada y sellada al adaptador.



Paso 6: Utilice la contrabrida para conectar el sistema de distribución a una brida de 6". Ahora proceda a retirar la extensión.

PENTAIR

CIERRE & ADAPTADORES



2.5" THREAD

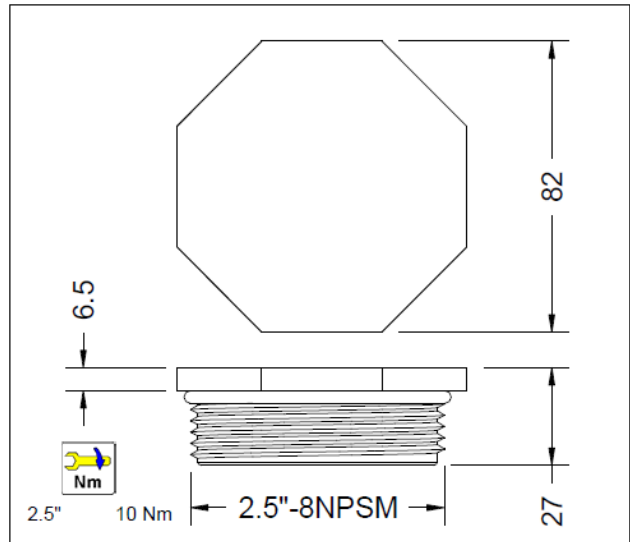
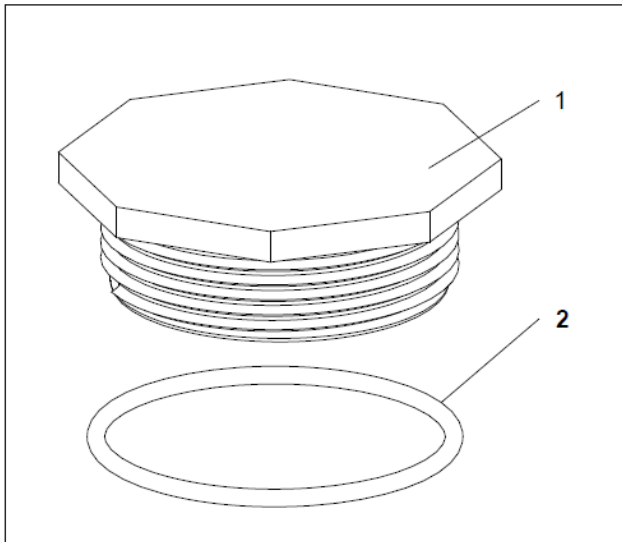
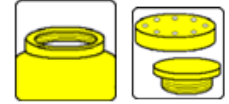



2.5"-8NPSM

Item	Description	Dimensions	Quantity	Material	Part number
1	Closure	2.5" -8NPSM	1	PVC	A-2751-1
2	O-ring	66.27 x 3.53 mm	1	NBR	A-2694-1



1

PENTAIR

CIERRE & ADAPTADORES



DN 400

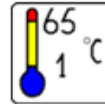
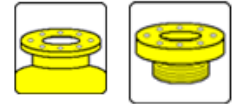

DN400



DN50

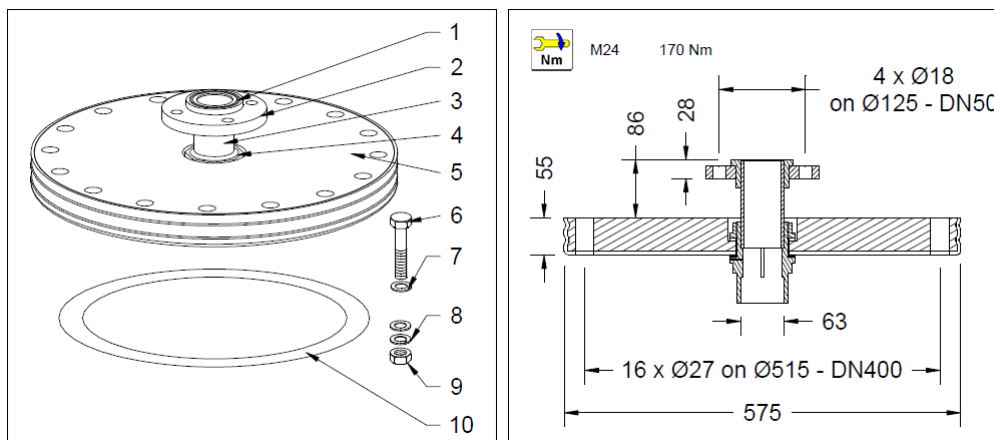

DN400 - DN50

Item	Description	Dimensions	Quantity	Material	Part number
1	Flange Adapter	DN50 - 63 mm	1	PVC	A-3720-64
2	Flange	DN50	1	PP-GF	X-1V-IPN1
3	Pipe	63 - 178 mm	1	PVC	A-PVC-063
4	Table Duct	63 mm	1	PVC	A-5160-65C
5	Flange	DN400	1	LLDPE/GR-EP	A-MACH-DN400
6	Bolt	M24 x 130	16	SS	A-M24-130
7	Washer	M24	32	SS	A-M24-RON
8	Spring Washer	M24	16	SS	A-M24-VRO
9	Nut	M24	16	SS	A-M24-A4
10	Flat Seal	DN400	1	NBR	A-DN40-0D



1

A-3400-02C

PENTAIR

CIERRE & ADAPTADORES



4" THREAD

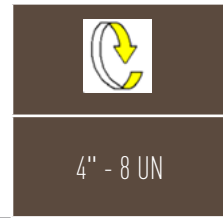
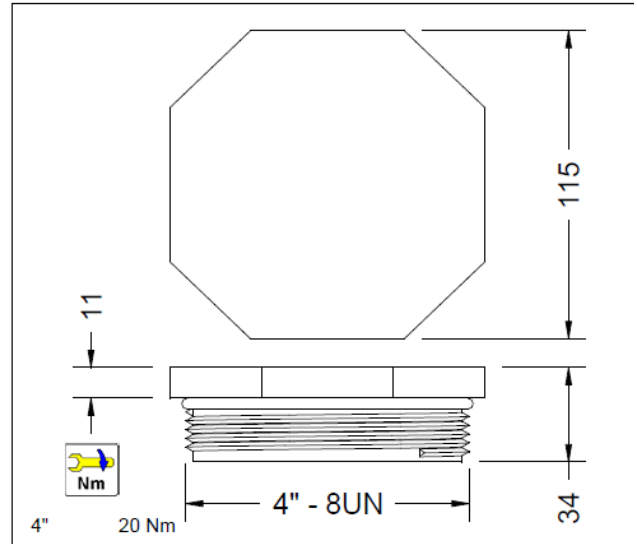
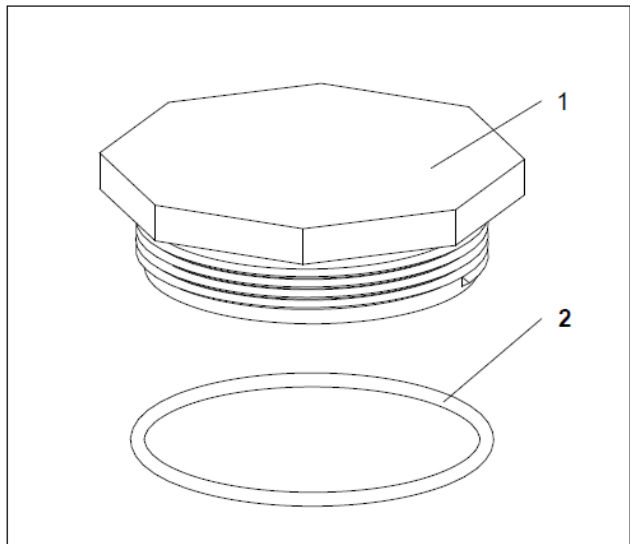
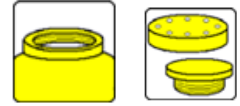

Item	Description	Dimensions	Quantity	Material	Part number
1	Closure	4"-8UN	1	PVC	A-2752-1
2	O-ring	98 x 4 mm	1	NBR	A-2694-3
					A-2752-1C



1

PENTAIR

CIERRE & ADAPTADORES



4" THREAD

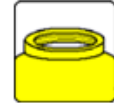

4"-8UN



2 1/2"-8NPSM

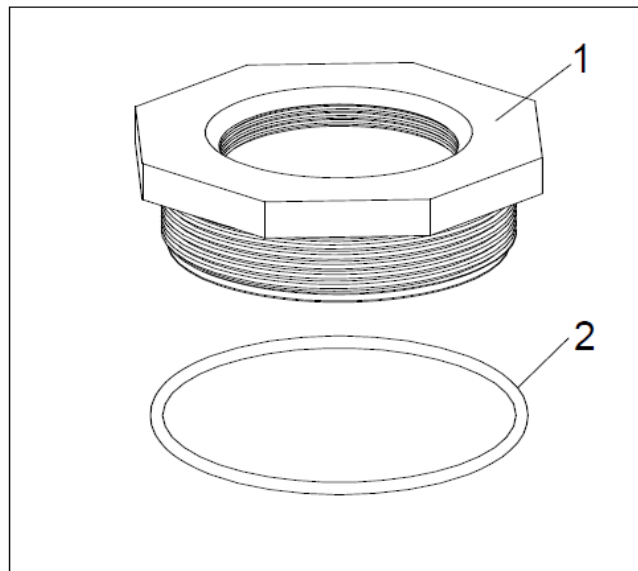

4" 20Nm



4" - 8 UN

Item	Description	Dimensions	Quantity	Material	Part number
1	Closure	4"-8UN	1	PVC	A-2752-2
2	O-ring	98 x 4 mm	1	NBR	A-2694-3
					A-2752-2C



1



6" THREAD

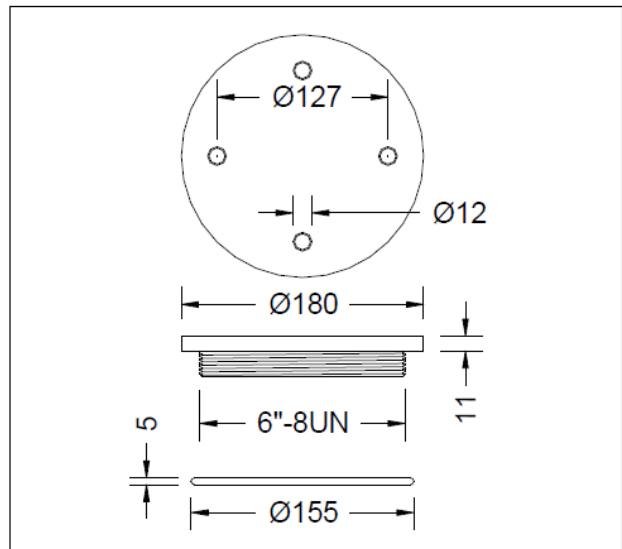
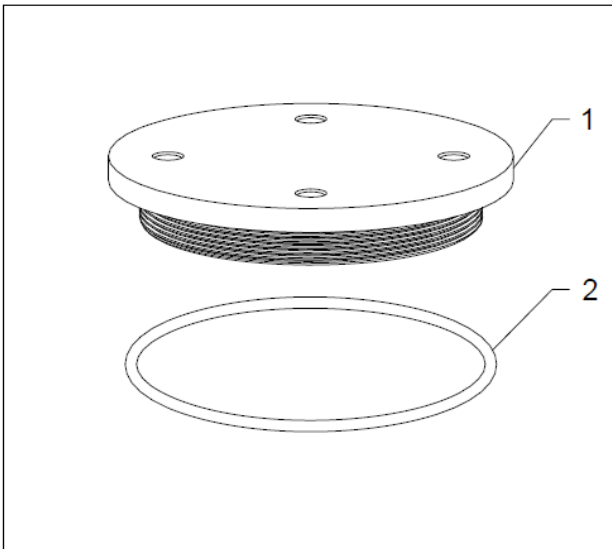
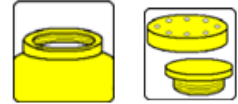

6" - 8 UN

Item	Description	Dimensions	Quantity	Material	Part number
1	Closure	6"-8UN	1	C-PVC	A-2695-3F
2	O-ring	155 x 5 mm	1	NBR	A-2694-BF

A-2695-3FC



1



6" FLANGE

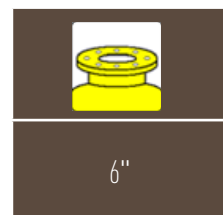
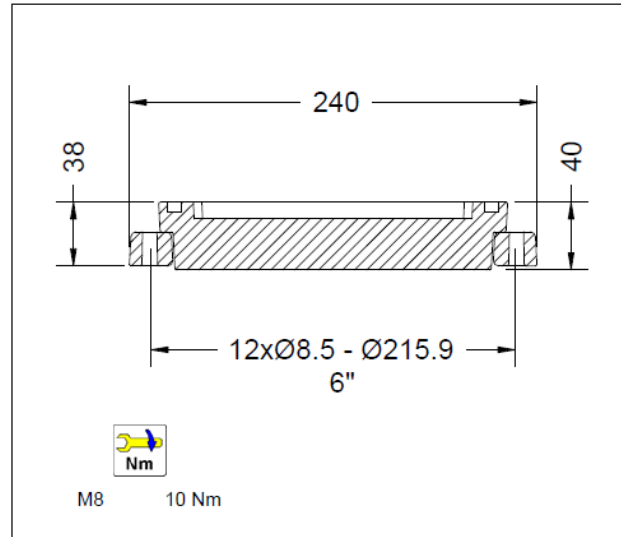
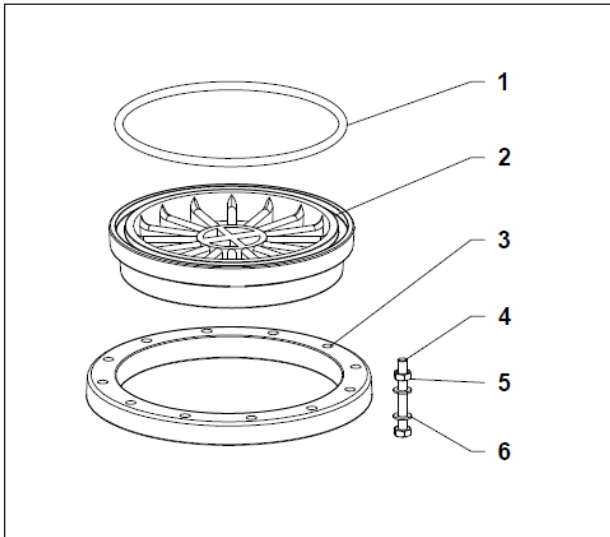
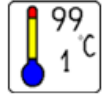
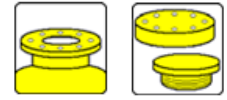

Item	Description	Dimensions	Quantity	Material	Part number
1	O-ring	183.52 x 6.99 mm	1	NBR	A-2694-8F
2	Closure	6"	1	PPO	A-085-0006
3	Backing Flange	6"	1	PPO	A-085-0221
4	Bolt	M8 x 75	12	SS	A-M8-075
5	Nut	M8	12	SS	A-M8-A4
6	Washer	M8	24	SS	A-M8-RON







A-3100-01C

1

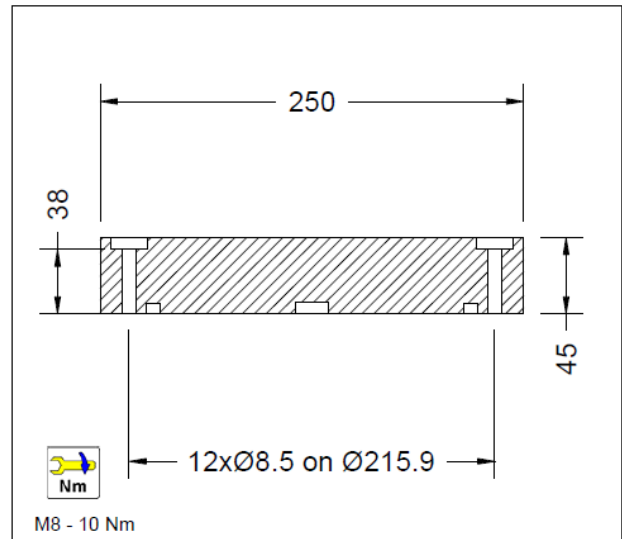
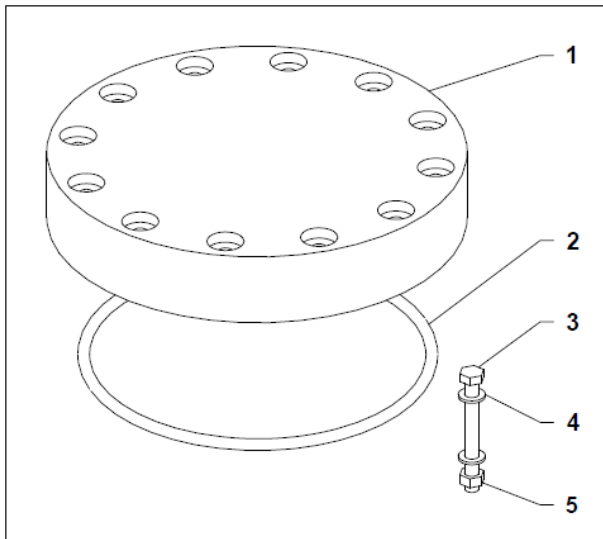
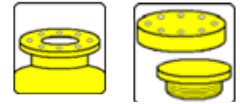

6" FLANGE

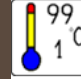

	 HDPE	 PVDF
	 50 1 °C	 99 1 °C
A-3100-ALC	A1-3100-ALC	A1-3100-ALC

Item	Description	Dimensions	Quantity	Material	Part number	
1	Closure	6"	1		A-3100-01AL	A1-3100-01AL
2	O-ring	183.52 x 6.99 mm	1	FPM	A-2694-V8F	A-2694-V8F
3	Bolt	M8 x 75	12	SS	A-8894-00	A-8894-00
4	Washer	M8	24	SS	A-M8-RON	A-M8-RON
5	Nut	M8	12	SS	A-M8-A4	A-M8-A4



PENTAIR

CIERRE & ADAPTADORES



6" FLANGE

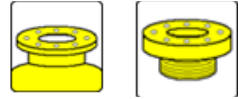

6" FLANGE
1.5" BSP



1.5" BSP

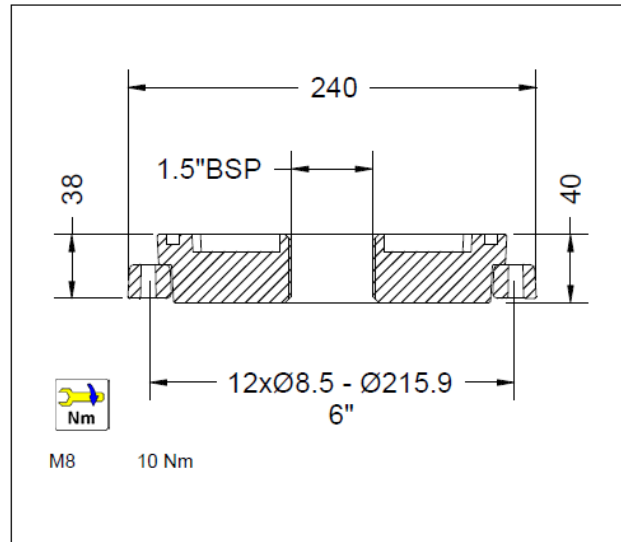
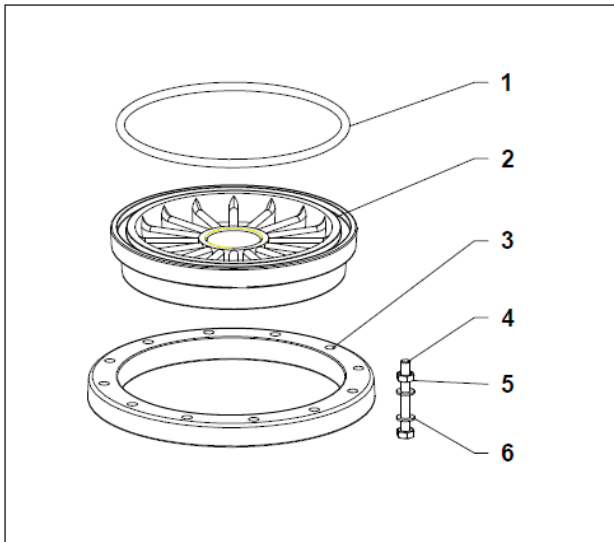

6" - 1.5" BSP

Item	Description	Dimensions	Quantity	Material	Part number
1	O-ring	183.52 x 6.99 mm	1	NBR	A-2694-8F
2	Adapter	6" - 1.5" BSP	1	PPO	A-085-0007
3	Backing Flange	6"	1	PPO	A-085-0221
4	Bolt	M8 x 75	12	SS	A-M8-075
5	Nut	M8	12	SS	A-M8-A4
6	Washer	M8	24	SS	A-M8-RON



1

A-3100-06C



6" FLANGE

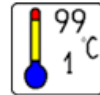
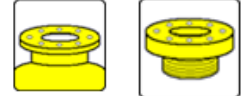

6" FLANGE
2.5"-8 NPSM



2.5" 8 NPSM

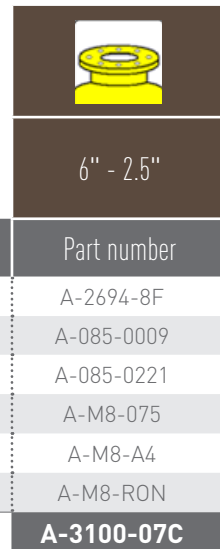
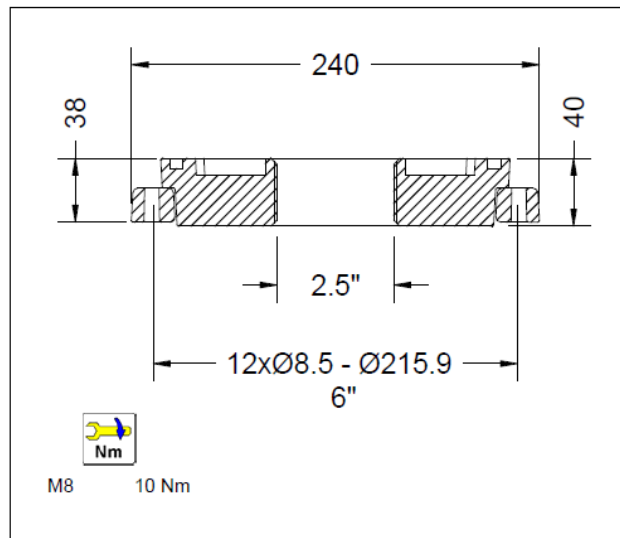
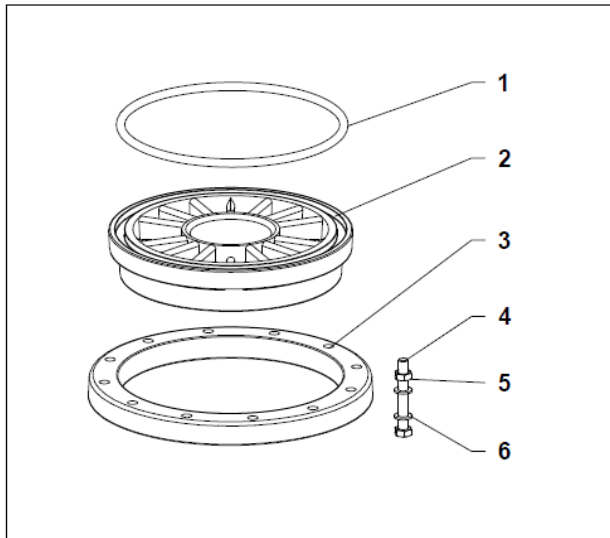

Item	Description	Dimensions	Quantity	Material	Part number
1	O-ring	183.52 x 6.99 mm	1	NBR	A-2694-8F
2	Adapter	6" - 2.5"	1	PPO	A-085-0009
3	Backing Flange	6"	1	PPO	A-085-0221
4	Bolt	M8 x 75	12	SS	A-M8-075
5	Nut	M8	12	SS	A-M8-A4
6	Washer	M8	24	SS	A-M8-RON



1

PENTAIR

CIERRE & ADAPTADORES



6" FLANGE

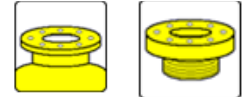

6" FLANGE
4" - 8 UN



4" - 8 UN

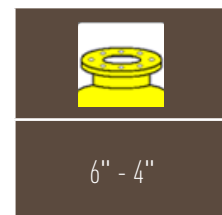
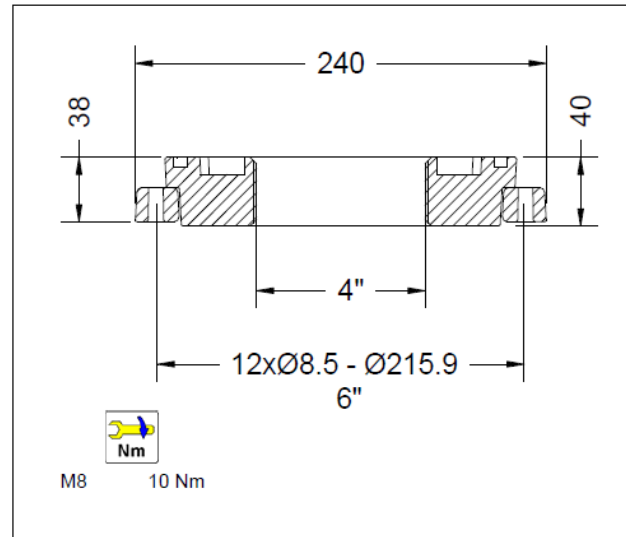
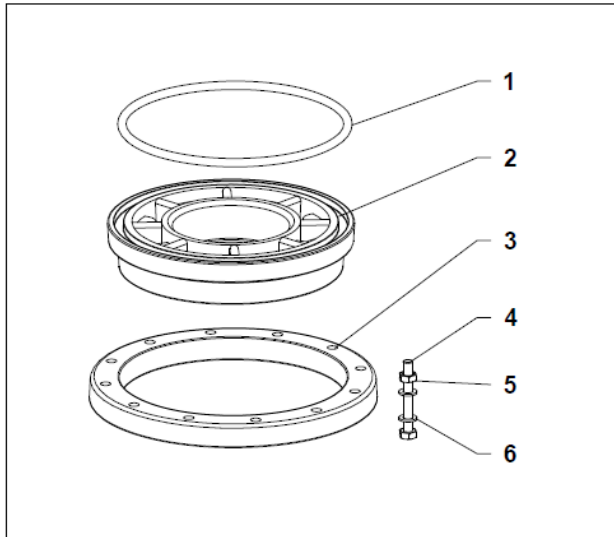

Item	Description	Dimensions	Quantity	Material	Part number
1	O-ring	183.52 x 6.99 mm	1	NBR	A-2694-8F
2	Adapter	6" - 4"	1	PPO	A-085-0101
3	Backing Flange	6"	1	PPO	A-085-0221
4	Bolt	M8 x 75	12	SS	A-M8-075
5	Nut	M8	12	SS	A-M8-A4
6	Washer	M8	24	SS	A-M8-RON



1

A-3100-08C



6" FLANGE

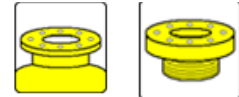

6" FLANGE
2.5" - 8 UN



DN 65

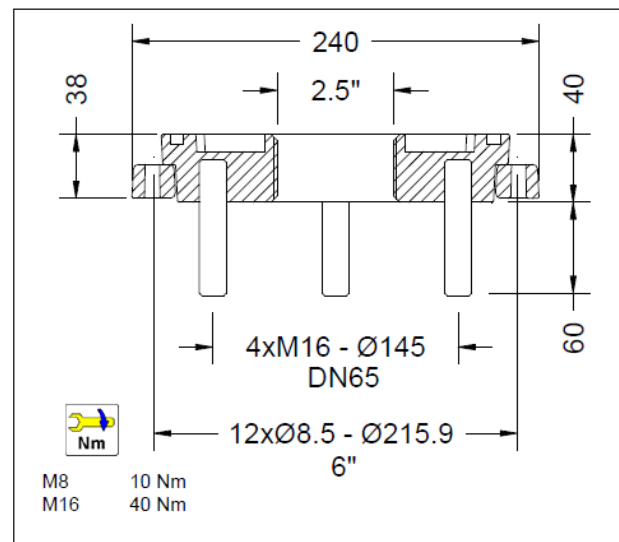
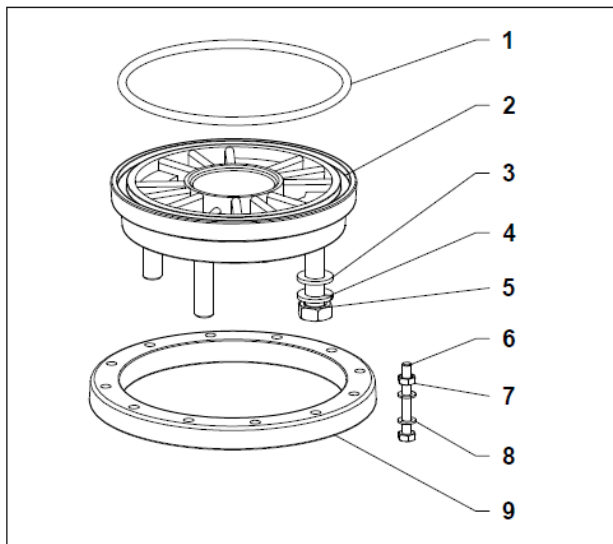

6" - DN65 - 2.5"

Item	Description	Dimensions	Quantity	Material	Part number
1	O-ring	183.52 x 6.99 mm	1	NBR	A-2694-8F
2	Adapter	6" - DN65	1	PPO	A-086-0000
3	Washer	M16	4	SS	A-M16-RON
4	Spring Washer	M16	4	SS	A-M16-VRO
5	Nut	M16	4	SS	A-M16-A4
6	Bolt	M8 x 75	12	SS	A-M8-075
7	Nut	M8	12	SS	A-M8-A4
8	Washer	M8	24	SS	A-M8-RON
9	Backing Flange	6"	1	PPO	A-085-0221



1

A-3100-02C



PENTAIR

CIERRE & ADAPTADORES



6" FLANGE

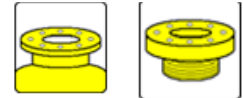

6" FLANGE
4" - 8 UN



DN 80

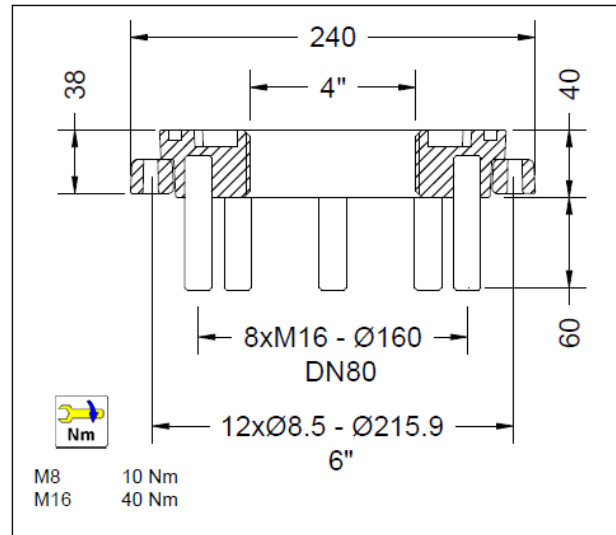
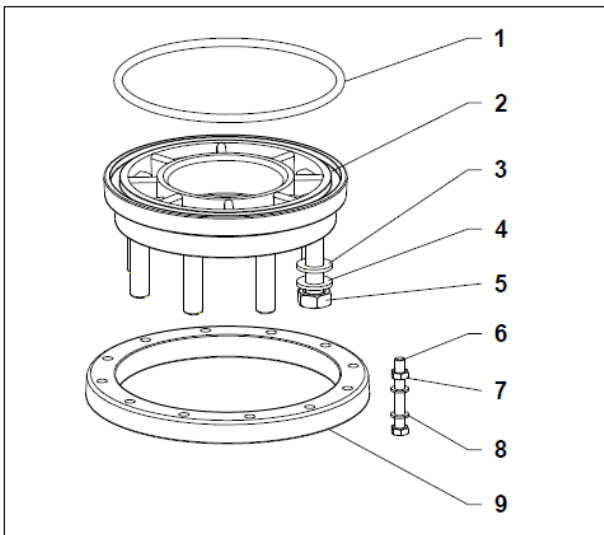

Item	Description	Dimensions	Quantity	Material	Part number
1	O-ring	183.52 x 6.99 mm	1	NBR	A-2694-8F
2	Adapter	6" - DN80	1	PPO	A-086-0003
3	Washer	M16	8	SS	A-M16-RON
4	Spring Washer	M16	8	SS	A-M16-VRO
5	Nut	M16	8	SS	A-M16-A4
6	Bolt	M8 x 75	12	SS	A-M8-075
7	Nut	M8	12	SS	A-M8-A4
8	Washer	M8	24	SS	A-M8-RON
9	Backing Flange	6"	1	PPO	A-085-0221



A-3100-03C

1



PENTAIR

CIERRE & ADAPTADORES



6" FLANGE

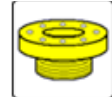
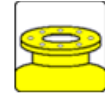

6" FLANGE
4" - 8 UN



DN 100

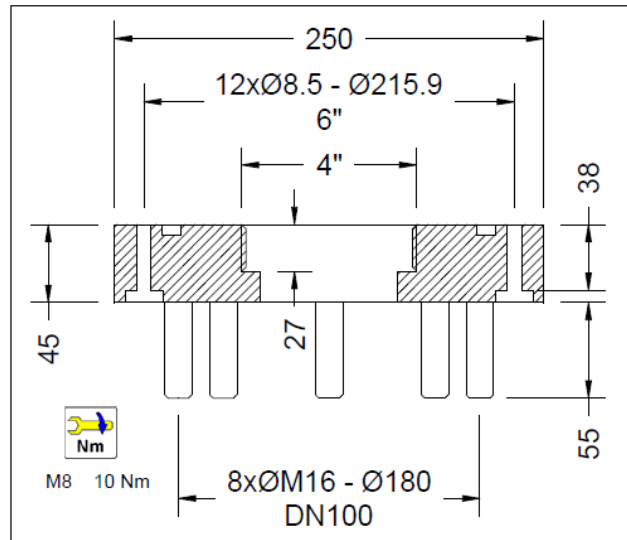
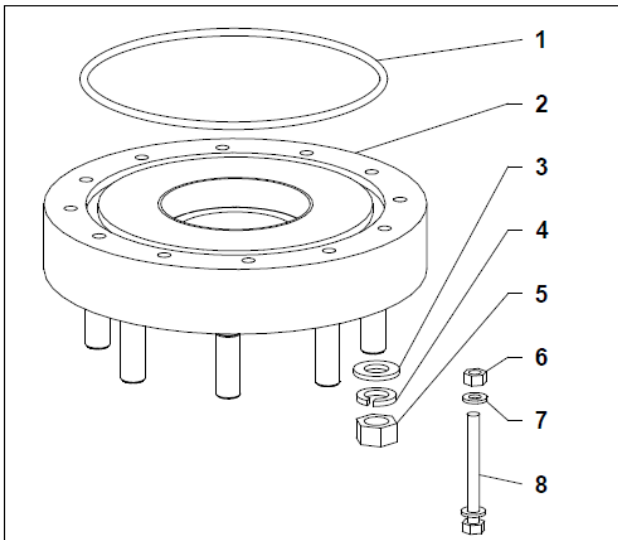

6"-DN100-4"

Item	Description	Dimensions	Quantity	Material	Part number
1	O-ring	183.52 x 6.99 mm	1	NBR	A-2694-8F
2	Adapter	6" - DN100	1	PPO	A-3100-100
3	Washer	M16	8	SS	A-M16-RON
4	Spring Washer	M16	8	SS	A-M16-VR0
5	Nut	M16	8	SS	A-M16-A4
6	Nut	M8	12	SS	A-M8-A4
7	Washer	M8	24	SS	A-M8-RON
8	Bolt	M8	12	SS	A-M8-075

A-3100-09C



1



BLINDFLANGE

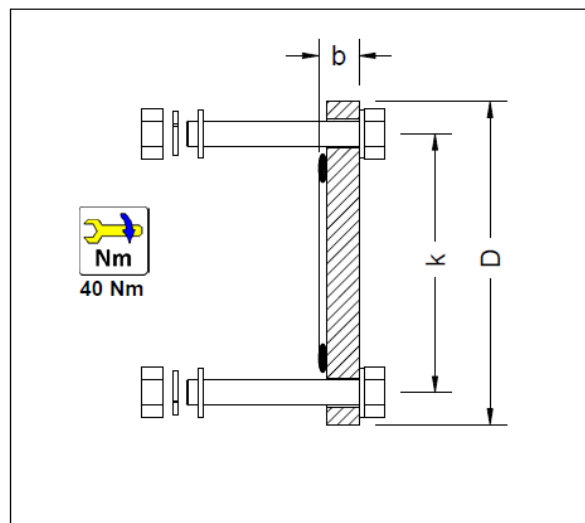
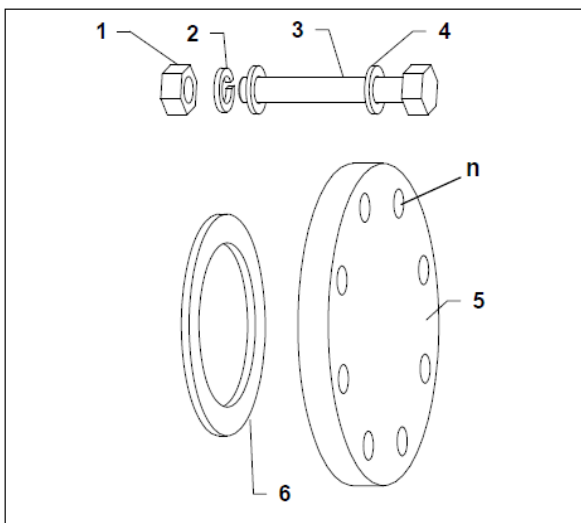
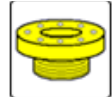
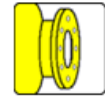

Item	Description	Material	DN50	DN80	DN100	DN200
1	Nut	SS	A-M16-A4	A-M16-A4	A-M16-A4	A-M20-A4
2	Spring Washer	SS	A-M16-VRO	A-M16-VRO	A-M16-VRO	A-M20-VRO
3	Bolt	SS	A-M16-90	A-M16-90	A-M16-90	A-M20-120
4	Washer	SS	A-M16-RON	A-M16-RON	A-M16-RON	A-M20-RON
5	Blind Flange	PP-GF/PVC	AG-DN-50B	AG-DN-80B	AG-DN-10B	A6-DN20-PPGF
6	Seal	NBR	A-2600-68	A-2600-71	A-2600-67	A-DN20-0D
			4	8	8	8
			19	19	20	46
			145	160	180	295
			185	200	220	340
			AG-DN-50L	AG-DN-80L	AG-DN-10L	A-3200-01C





PENTAIR

CIERRE & ADAPTADORES



BLINDFLANGE

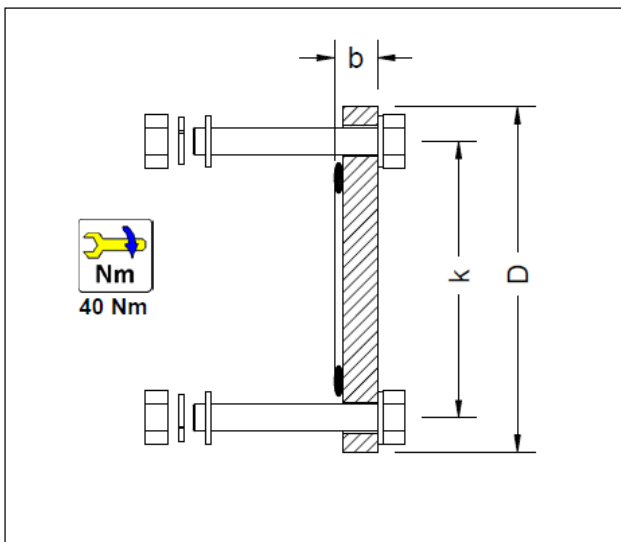
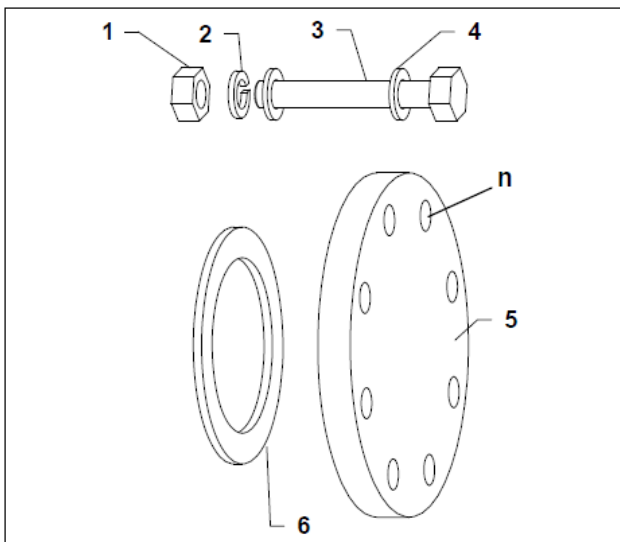
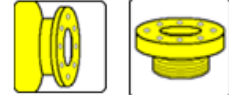

Item	Description	Material	DN50	DN80	DN100	DN200
1	Nut	SS	A-M16-A4	A-M16-A4	A-M16-A4	A-M20-A4
2	Spring Washer	SS	A-M16-VRO	A-M16-VRO	A-M16-VRO	A-M20-VRO
3	Bolt	SS	A-M16-90	A-M16-90	A-M16-90	A-M20-120
4	Washer	SS	A-M16-RON	A-M16-RON	A-M16-RON	A-M20-RON
5	Blind Flange	PP-GF/PVC	AG-DN-50B	AG-DN-80B	AG-DN-10B	A-3742-00
6	Seal	NBR	A-2600-68	A-2600-71	A-2600-67	A-DN20-0D
			4	8	8	8
			19	19	20	46
			145	160	180	295
			185	200	220	340
			AG-DN-50L	AG-DN-80L	AG-DN-10L	A-3200-01C





BLINDFLANGE

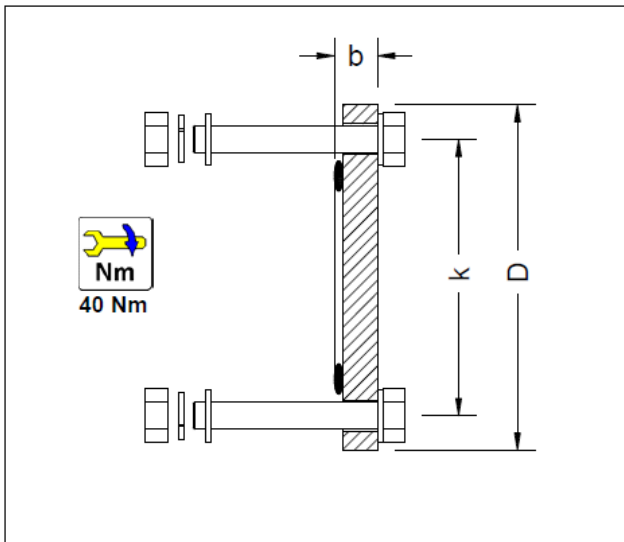
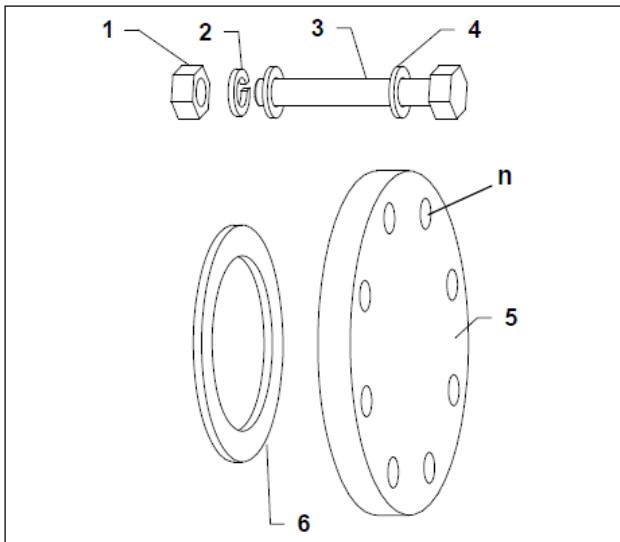
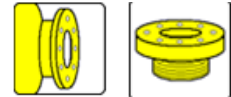

Item	Description	Material	DN50	DN80	DN100	DN200
1	Nut	SS	A-M16-A4	A-M16-A4	A-M16-A4	A-M20-A4
2	Spring Washer	SS	A-M16-VRO	A-M16-VRO	A-M16-VRO	A-M20-VRO
3	Bolt	SS	A-M16-90	A-M16-90	A-M16-90	A-M20-120
4	Washer	SS	A-M16-RON	A-M16-RON	A-M16-RON	A-M20-RON
5	Blind Flange	PP-GF/PVC	AG-DN-50B	AG-DN-80B	AG-DN-10B	A-3742-00
6	Seal	NBR	A-2600-68	A-2600-71	A-2600-67	A-DN20-0D
			4	8	8	8
			19	19	20	46
			145	160	180	295
			185	200	220	340
			AG-DN-50L	AG-DN-80L	AG-DN-10L	A-3200-01C





BLINDFLANGE

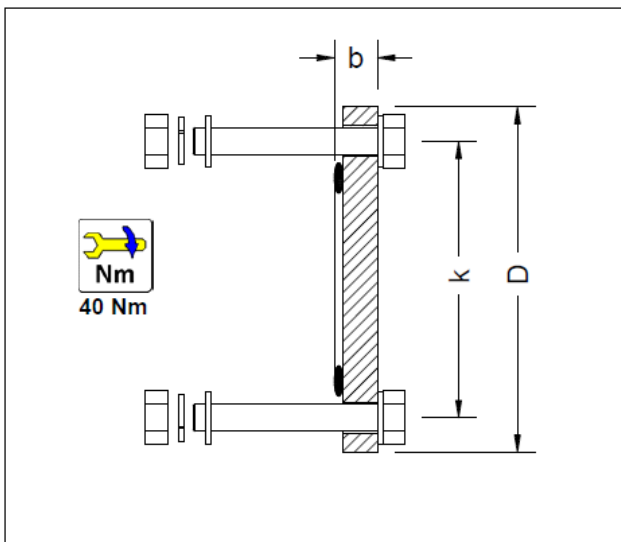
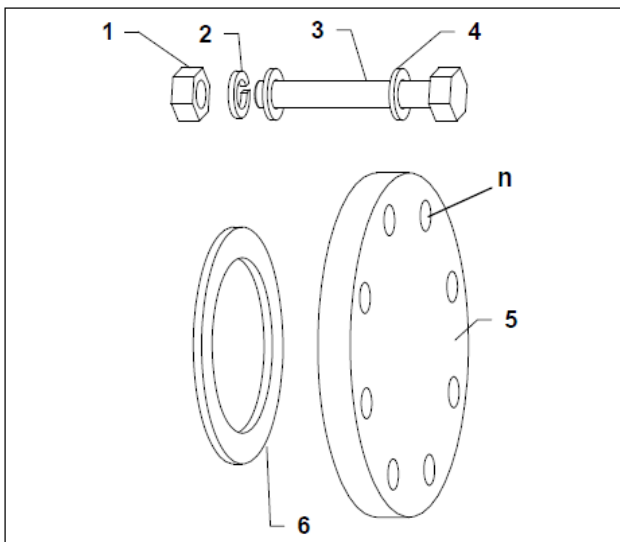
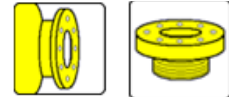

Item	Description	Material	DN50	DN80	DN100	DN200
1	Nut	SS	A-M16-A4	A-M16-A4	A-M16-A4	A-M20-A4
2	Spring Washer	SS	A-M16-VRO	A-M16-VRO	A-M16-VRO	A-M20-VRO
3	Bolt	SS	A-M16-90	A-M16-90	A-M16-90	A-M20-120
4	Washer	SS	A-M16-RON	A-M16-RON	A-M16-RON	A-M20-RON
5	Blind Flange	PP-GF/PVC	AG-DN-50B	AG-DN-80B	AG-DN-10B	A-3742-00
6	Seal	NBR	A-2600-68	A-2600-71	A-2600-67	A-DN20-0D
			4	8	8	8
			19	19	20	46
			145	160	180	295
			185	200	220	340
			AG-DN-50L	AG-DN-80L	AG-DN-10L	A-3200-01C





PENTAIR

CIERRE & ADAPTADORES



BLINDFLANGE

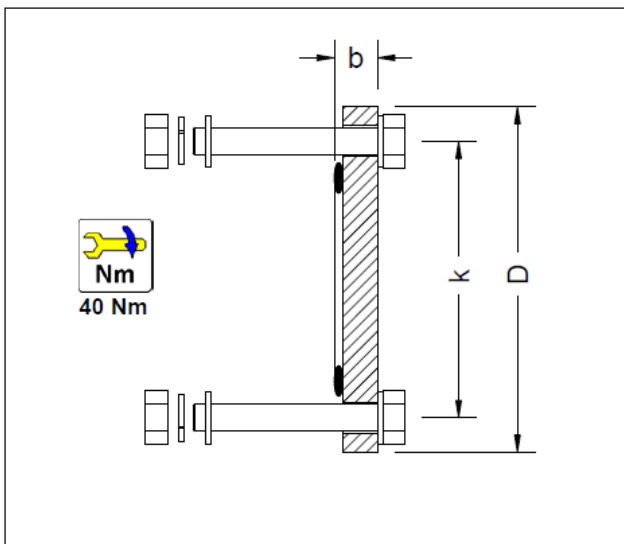
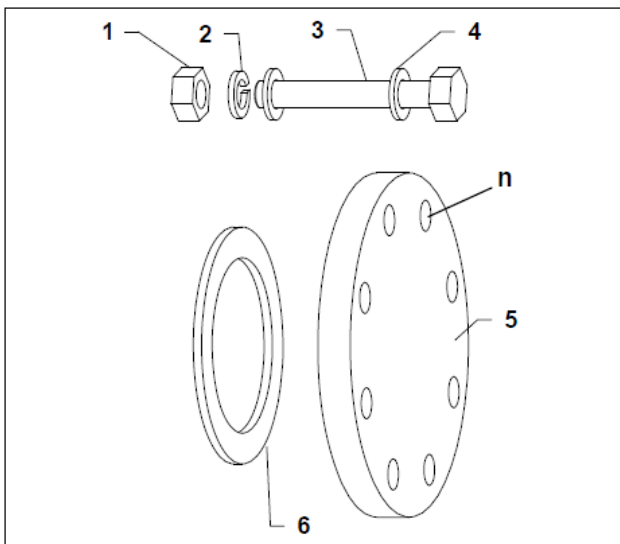
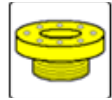
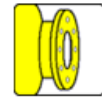

Item	Description	Material	DN50	DN80	DN100	DN200
1	Nut	SS	A-M16-A4	A-M16-A4	A-M16-A4	A-M20-A4
2	Spring Washer	SS	A-M16-VRO	A-M16-VRO	A-M16-VRO	A-M20-VRO
3	Bolt	SS	A-M16-90	A-M16-90	A-M16-90	A-M20-120
4	Washer	SS	A-M16-RON	A-M16-RON	A-M16-RON	A-M20-RON
5	Blind Flange	PP-GF/PVC	AG-DN-50B	AG-DN-80B	AG-DN-10B	A-3742-00
6	Seal	NBR	A-2600-68	A-2600-71	A-2600-67	A-DN20-0D
			4	8	8	8
			19	19	20	46
			145	160	180	295
			185	200	220	340
			AG-DN-50L	AG-DN-80L	AG-DN-10L	A-3200-01C





BLINDFLANGE

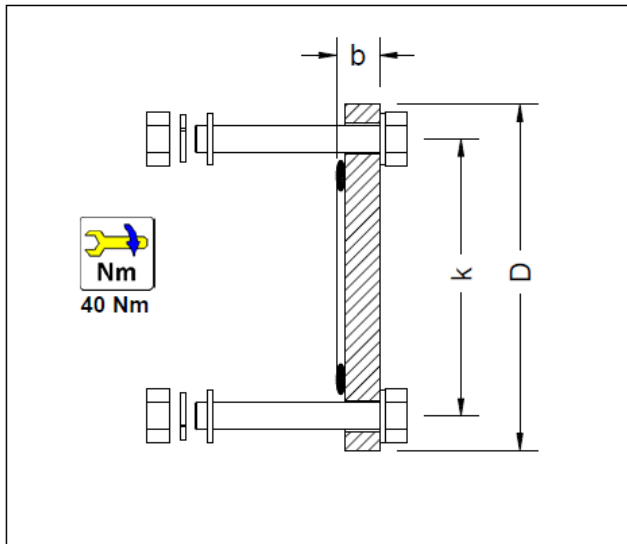
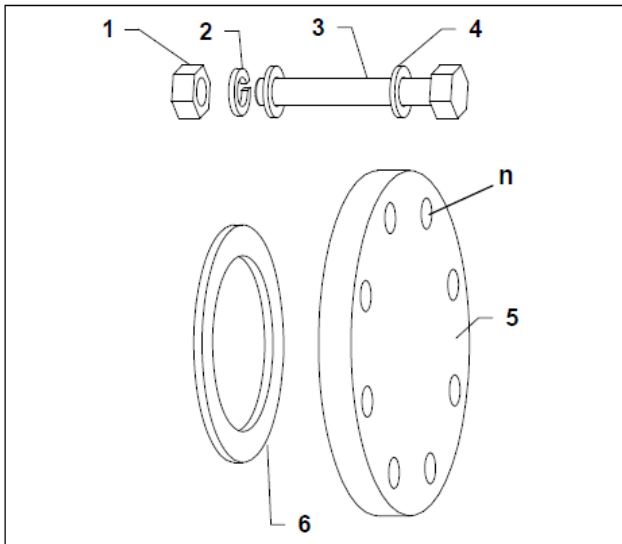
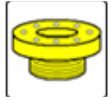
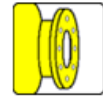

Item	Description	Material	DN50	DN80	DN100	DN200
1	Nut	SS	A-M16-A4	A-M16-A4	A-M16-A4	A-M20-A4
2	Spring Washer	SS	A-M16-VRO	A-M16-VRO	A-M16-VRO	A-M20-VRO
3	Bolt	SS	A-M16-90	A-M16-90	A-M16-90	A-M20-120
4	Washer	SS	A-M16-RON	A-M16-RON	A-M16-RON	A-M20-RON
5	Blind Flange	PP-GF	AG-DN-50B	AG-DN-80B	AG-DN-10B	AG-DN-20PPGF
6	Seal	NBR	A-2600-68	A-2600-71	A-2600-67	A-DN20-0D
			4	8	8	8
			19	19	20	41
			145	160	180	295
			185	200	220	340
			AG-DN-50L	AG-DN-80L	AG-DN-10L	A-3200-02C





BLINDFLANGE

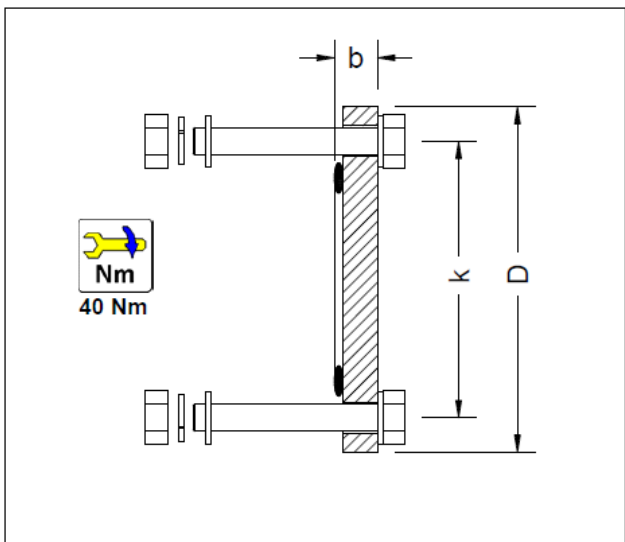
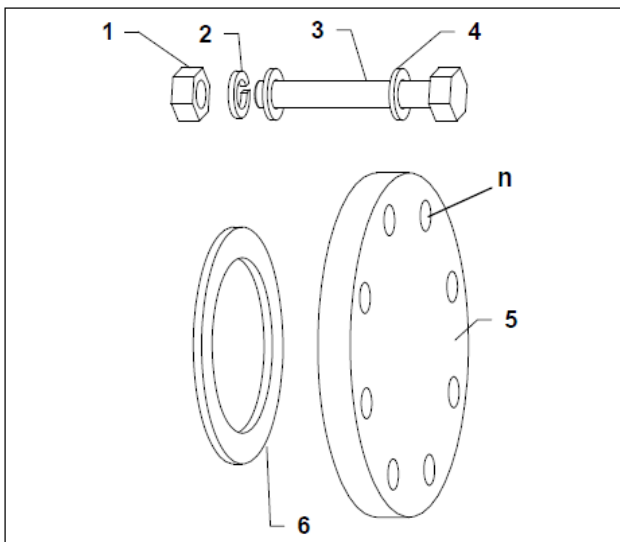
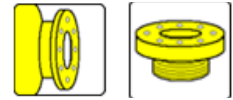

Item	Description	Material	DN50	DN80	DN100	DN200
1	Nut	SS	A-M16-A4	A-M16-A4	A-M16-A4	A-M20-A4
2	Spring Washer	SS	A-M16-VRO	A-M16-VRO	A-M16-VRO	A-M20-VRO
3	Bolt	SS	A-M16-90	A-M16-90	A-M16-90	A-M20-120
4	Washer	SS	A-M16-RON	A-M16-RON	A-M16-RON	A-M20-RON
5	Blind Flange	PP-GF/PVC	AG-DN-50B	AG-DN-80B	AG-DN-10B	A-3742-00
6	Seal	NBR	A-2600-68	A-2600-71	A-2600-67	A-DN20-0D
			4	8	8	8
			19	19	20	46
			145	160	180	295
			185	200	220	340
			AG-DN-50L	AG-DN-80L	AG-DN-10L	A-3200-01C





BLINDFLANGE

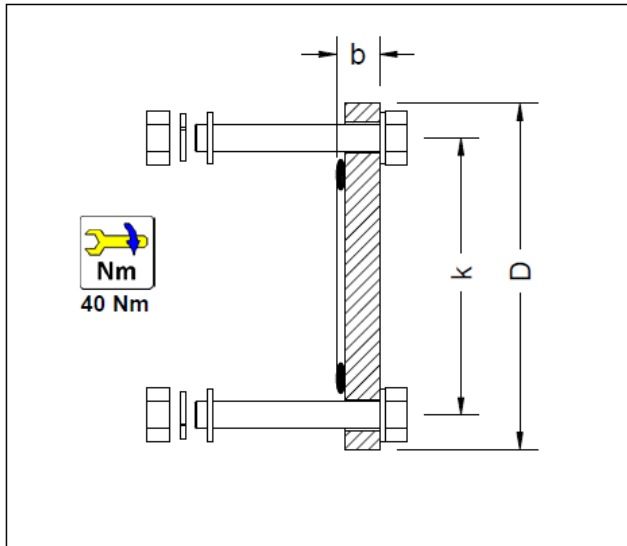
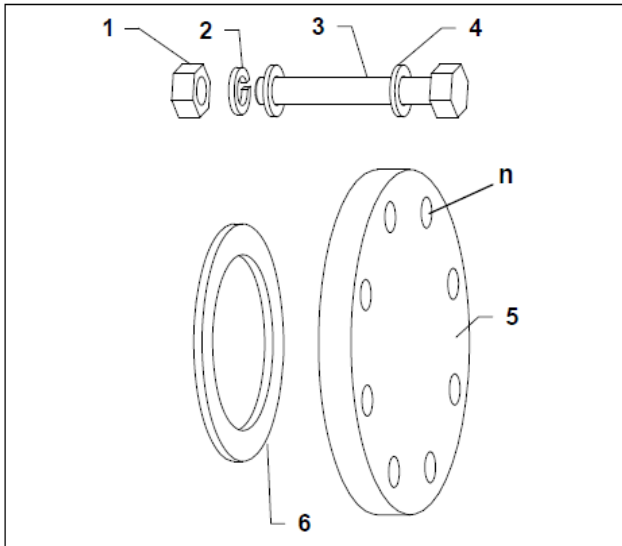
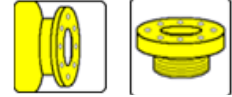

Item	Description	Material	DN50	DN80	DN100	DN200
1	Nut	SS	A-M16-A4	A-M16-A4	A-M16-A4	A-M20-A4
2	Spring Washer	SS	A-M16-VRO	A-M16-VRO	A-M16-VRO	A-M20-VRO
3	Bolt	SS	A-M16-90	A-M16-90	A-M16-90	A-M20-120
4	Washer	SS	A-M16-RON	A-M16-RON	A-M16-RON	A-M20-RON
5	Blind Flange	PP-GF	AG-DN-50B	AG-DN-80B	AG-DN-10B	AG-DN-20PPGF
6	Seal	NBR	A-2600-68	A-2600-71	A-2600-67	A-DN20-0D
			4	8	8	8
			19	19	20	41
			145	160	180	295
			185	200	220	340
			AG-DN-50L	AG-DN-80L	AG-DN-10L	A-3200-02C



1



PENTAIR

INSERCIÓN DE DRENAJE



6" FLANGE

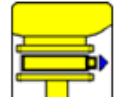

DRAIN

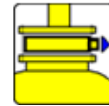
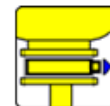
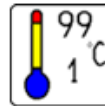

1" BSP

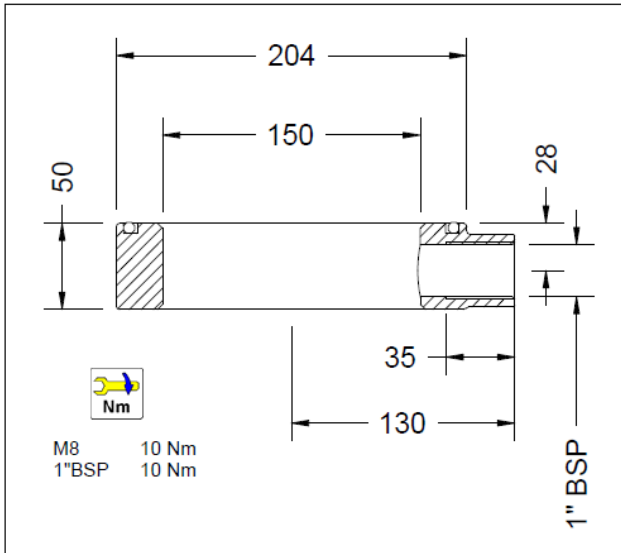
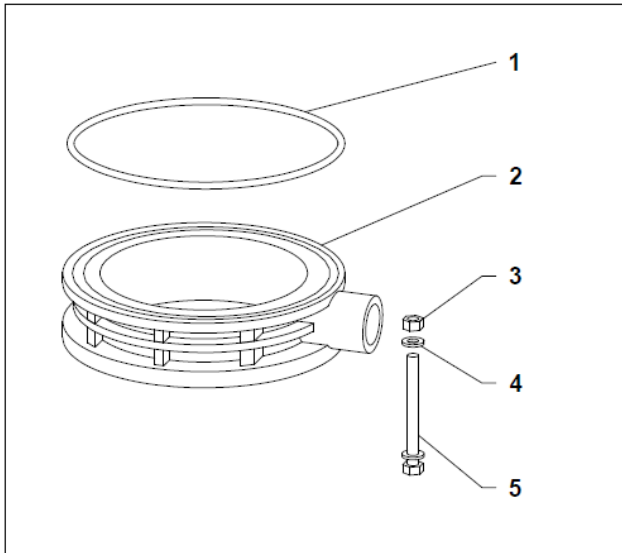

M8 10 Nm
1" BSP 10 Nm



1" BSP

Item	Description	Dimensions	Quantity	Material	Part number
1	O-ring	183.52 x 6.99 mm	1	NBR	A-2694-8F
2	Drain insert	6" - 1" BSP	1	PPO	A-085-0002
3	Nut	M8	12	SS	A-M8-A4
4	Washer	M8	24	SS	A-M8-RON
5	Bolt	M8 x 120	12	SS	A-M8-120



1

A-DRAIN-1BSP



6" FLANGE

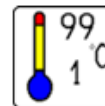
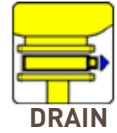
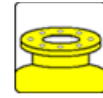

1" BSP

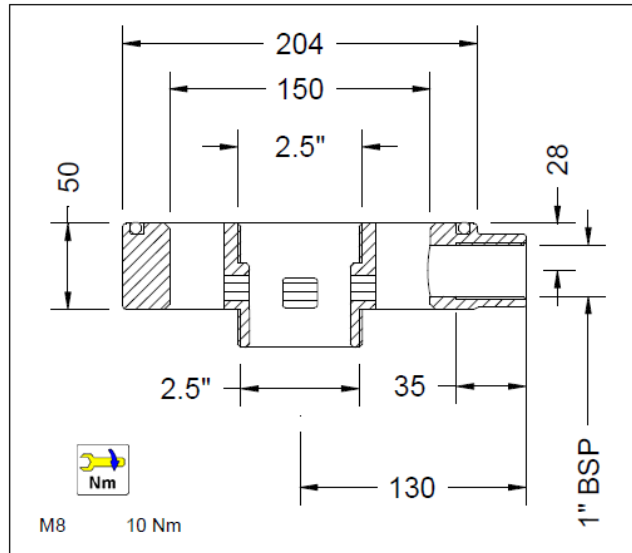
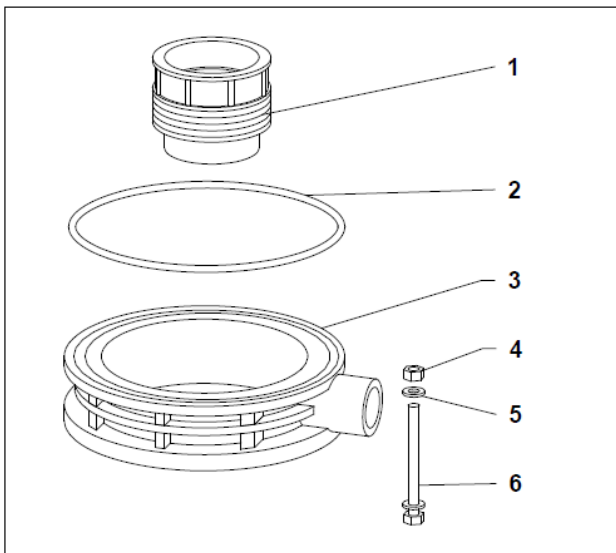

1" BSP
2.5"

Item	Description	Dimensions	Quantity	Material	Part number
1	Prolongation	2.5" - 50mm	1	PPO	A-3100-04C
2	O-ring	183.52 x 6.99 mm	1	NBR	A-2694-8F
3	Drain insert	6"-1"BSP	1	PPO	A-085-0002
4	Nut	M8	12	SS	A-M8-A4
5	Washer	M8	24	SS	A-M8-RON
6	Bolt	M8 x 120	12	SS	A-M8-120



1

A-DRAIN-LF



PENTAIR

INSERCIÓN DE DRENAJE



6" FLANGE

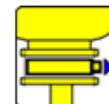
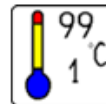
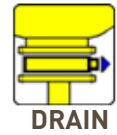
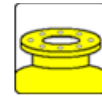

1" BSP

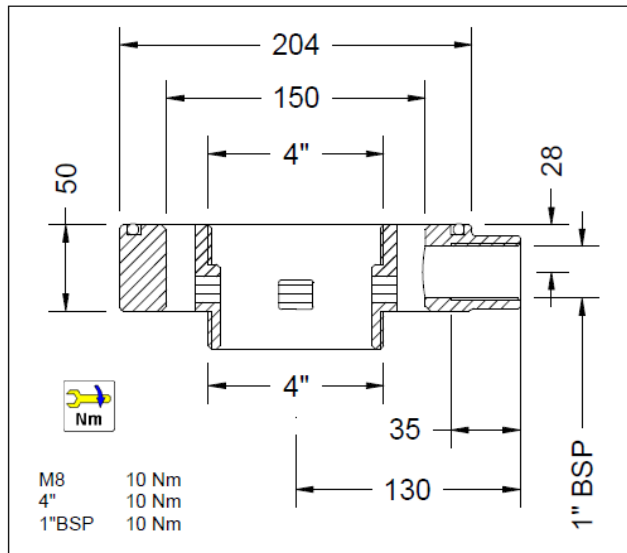
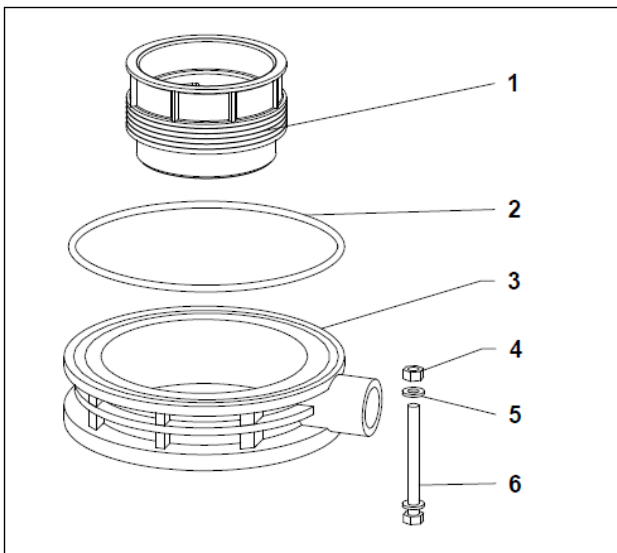

M8	10 Nm
4"	10 Nm
1" BSP	10 Nm



1" BSP
4"

Item	Description	Dimensions	Quantity	Material	Part number
1	Prolongation	4" - 50mm	1	PPO	A-3100-05C
2	O-ring	183.52 x 6.99 mm	1	NBR	A-2694-8F
3	Drain insert	6"-1" BSP	1	PPO	A-085-0002
4	Nut	M8	12	SS	A-M8-A4
5	Washer	M8	24	SS	A-M8-RON
6	Bolt	M8 x 120	12	SS	A-M8-120



1

A-DRAIN-HF



SIGHTGLASS

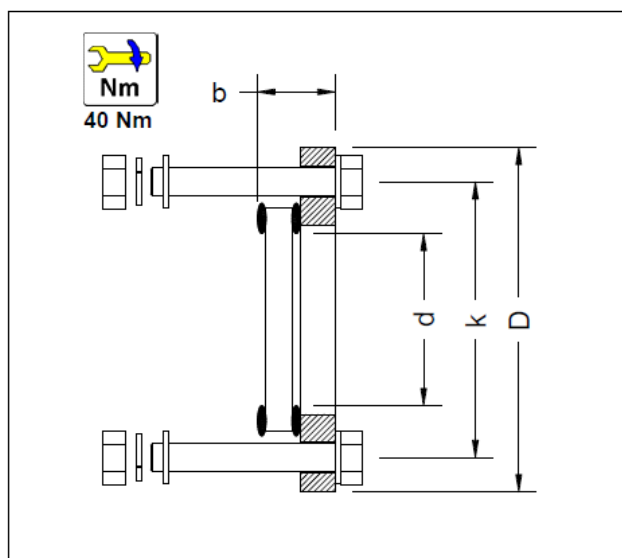
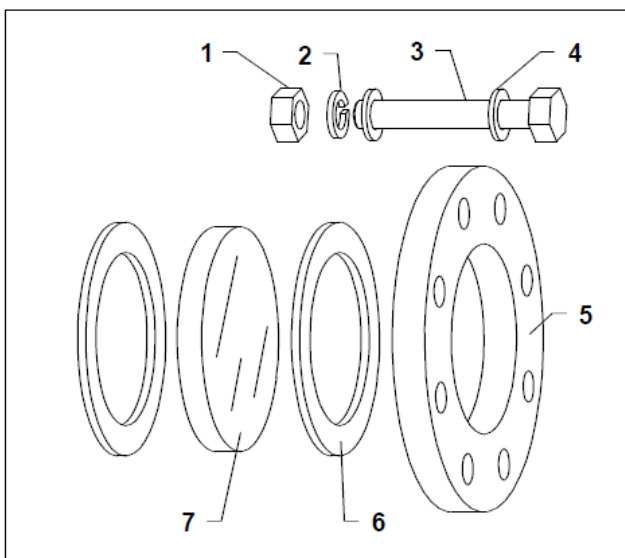
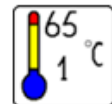
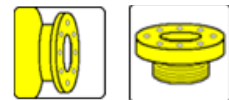

Item	Description	Quantity	Material	DN80	DN100
				Part number	
1	Nut	8	SS	A-M16-A4	A-M16-A4
2	Spring Water	8	SS	A-M16-VRO	A-M16-VRO
3	Bolt	8	SS	A-M16-110	A-M16-110
4	Washer	16	SS	A-M16-RON	A-M16-RON
5	Backing Flange	1	PP-GF	X-1V-IP80	X-0D-N101
6	Seal	1	NBR	A-2600-71	A-2600-67
7	Sightglass	1	GLASS	A-KIJK-80	A-KIJK-100
				45	45
				100	115
				200	220
				160	180
				A-SGHT-DN80	A-SGHT-DN100



1



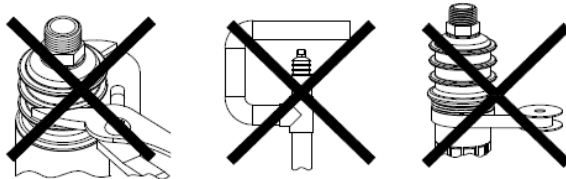
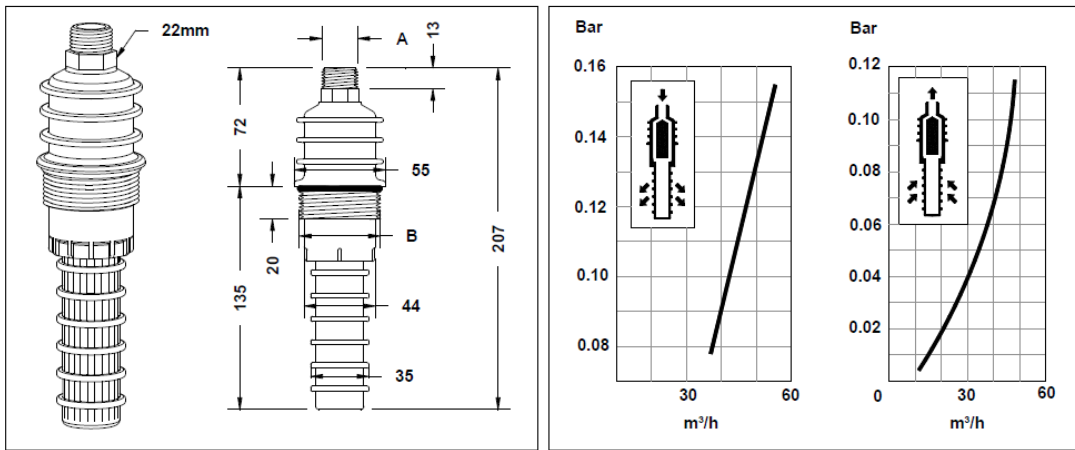

AERATION VALVE

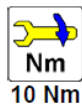
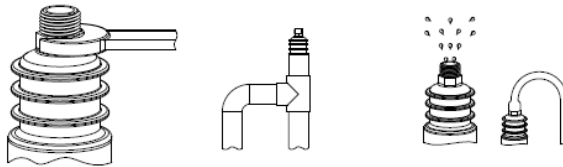

AERATION VALVE



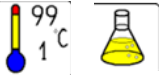

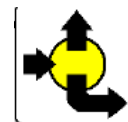
Item	Thread A	Thread B	Material	 1
	1/2" BSP	1 1/2" BSP	PP-GF/EPDM	A-AV-150PP
	1/2" NPT	1 1/2" NPT	PP-GF/EPDM	
	1/2" BSP	1 1/2" BSP	PVDF/FPM	A-AV-150PVDF
	1/2" NPT	1 1/2" NPT	PVDF/FPM	

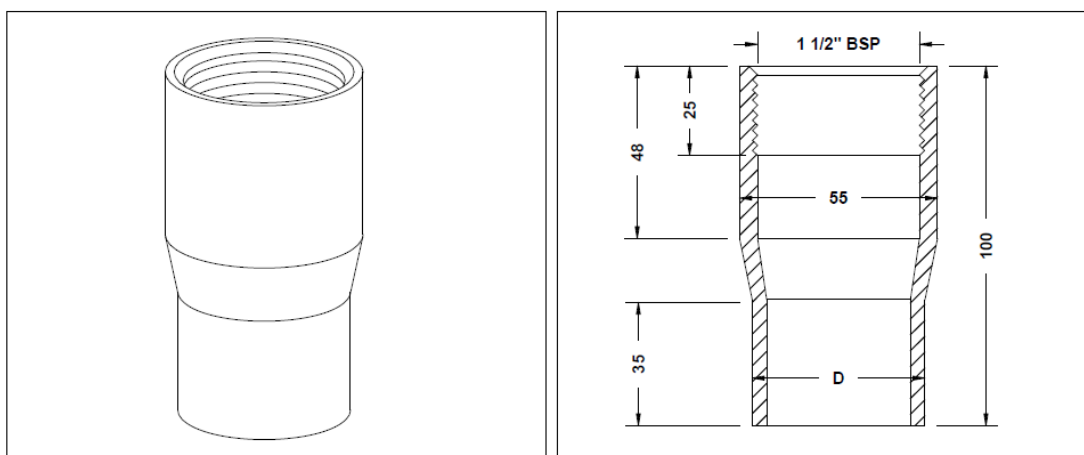

AERATION VALVE



ADAPTER FOR AERATION VALVE

D		Description	Material	 1
48mm		1 1/2" BSP - 48 mm	PVC	A-AV-AD48
50mm		1 1/2" BSP - 50 mm	PVC	A-AV-AD50



2.5" VALVE

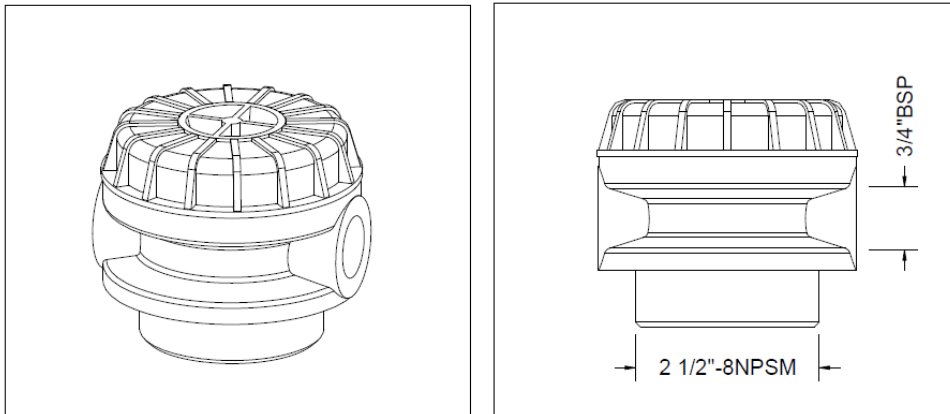
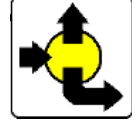

MANUAL VALVE

Type	Thread A	Thread B	Material	 1
	2.5" - 8 NPSM	3/4" BSP	PP	A-ANA-25-G3/4



WRENCHES

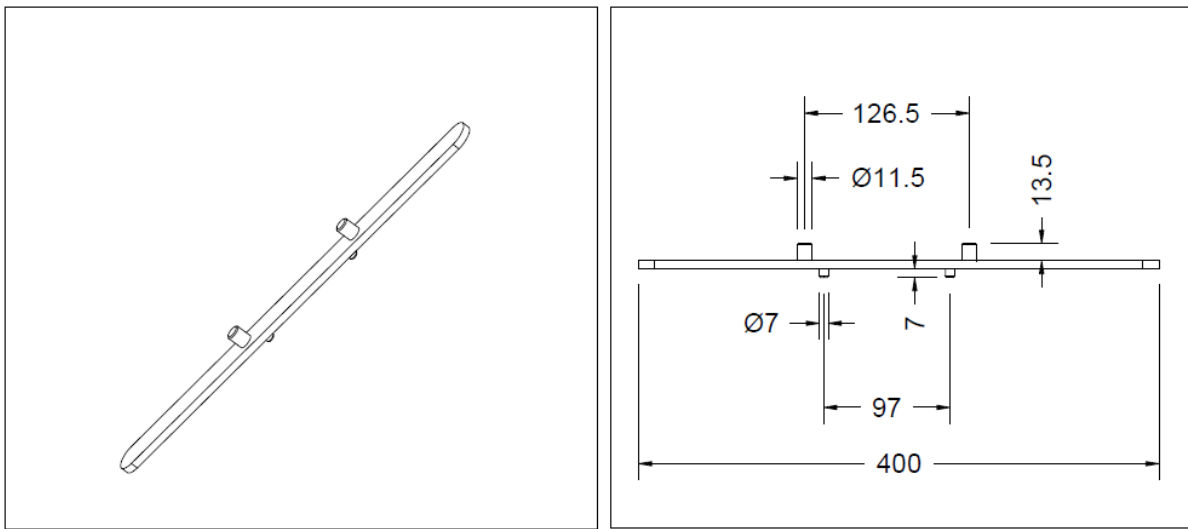
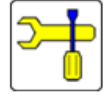

NOTCHED WRENCH FOR ADAPTERS

Item	Description	Dimensions	Quantity	Material	Part number
1	Notched wrench for adapters	Ø7 x 97 Ø11.5 x 126.5	1	STEEL	I-WR01-AD
					 I-WR01-AD
			 1		



WRENCHES

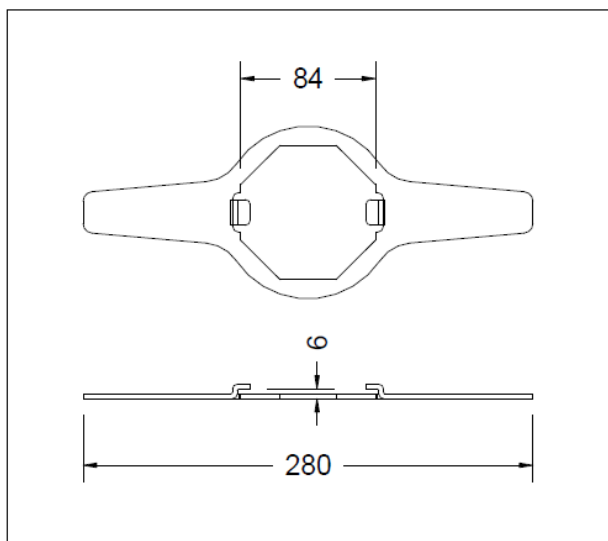
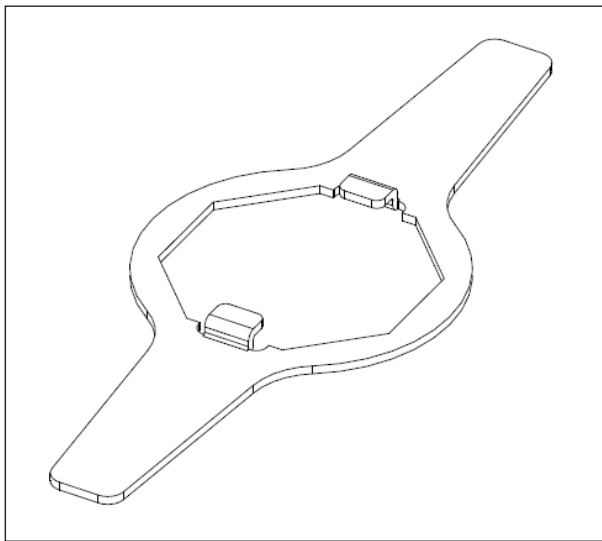

OCTOGONAL WRENCH FOR ADAPTERS
2.5" - 84 MM



Item	Description	Dimensions	Quantity	Material	Part number
1	Octagonal wrench for adapters	2.5" - 84 mm	1	PVC	I-WR05-AD



1

I-WR05-AD



WRENCHES

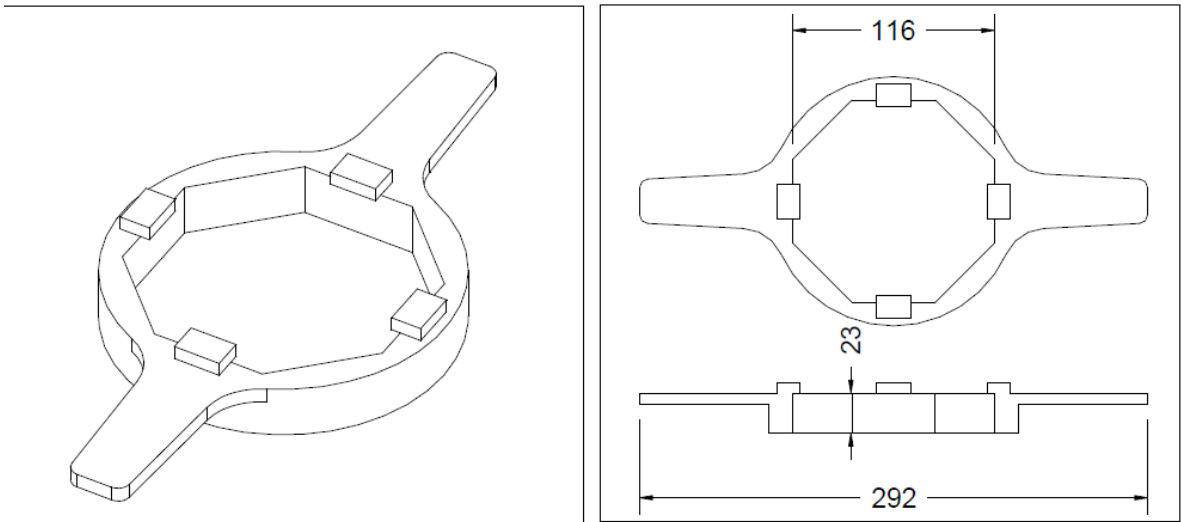

OCTAGONAL WRENCH FOR ADAPTERS
4" - 116 MM

Item	Description	Dimensions	Quantity	Material	Part number
1	Octagonal wrench for adapters	4" - 116 mm	1	PVC	I-WR06-AD
					I-WR06-AD

 1



WRENCHES

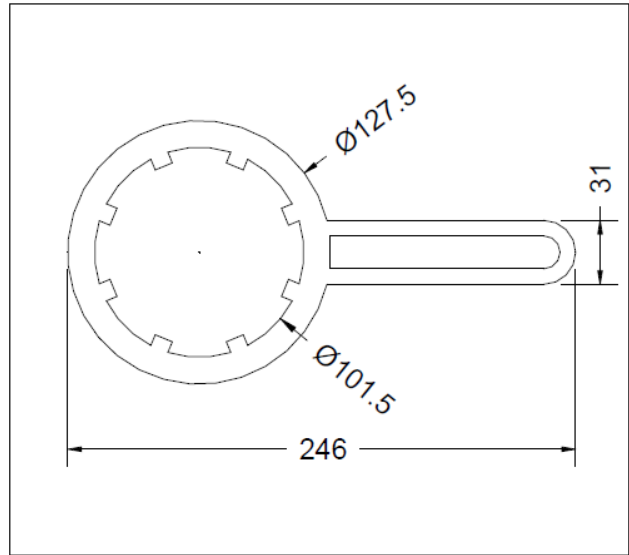
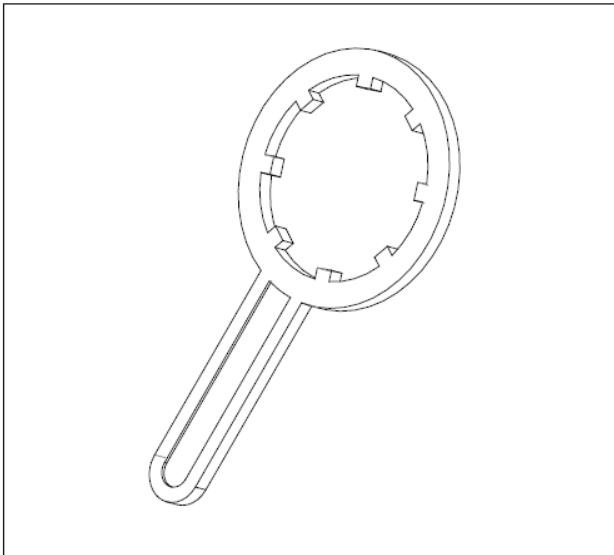

WRENCH FOR MANUAL VALVE



Item	Description	Dimensions	Quantity	Material	Part number
1	Wrench for manual valve	101.5	1	PP	A-ANA-S
					A-ANA-S





EXTENSION

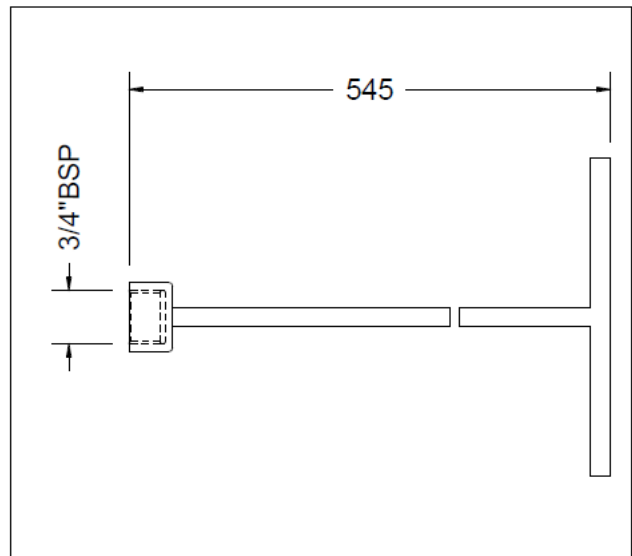
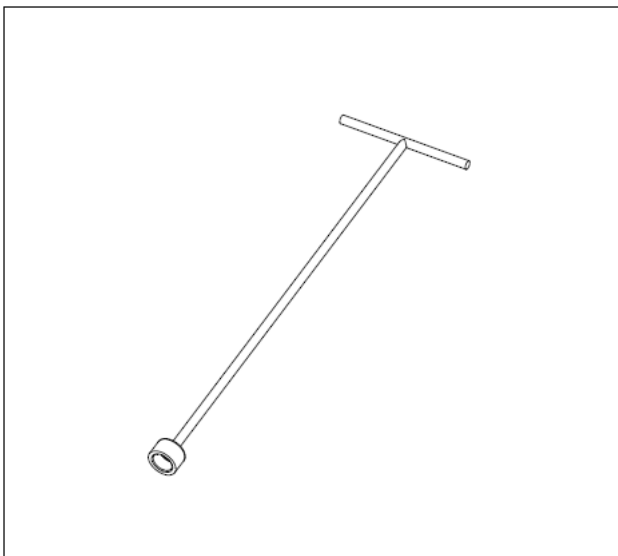
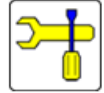

EXTENSION
3/4" BSP



Item	Description	Dimensions	Quantity	Material	Part number
1	Extension	3/4" BSP	1	STEEL	I-WR03-LA



1

I-WR03-LA



EXTENSION

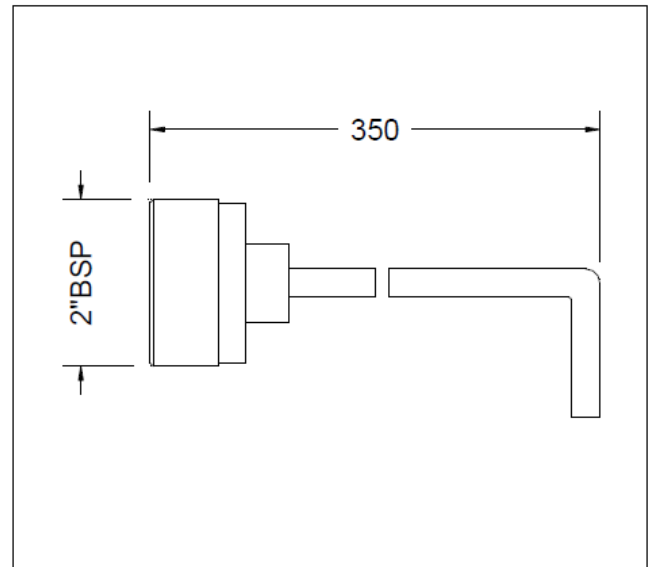
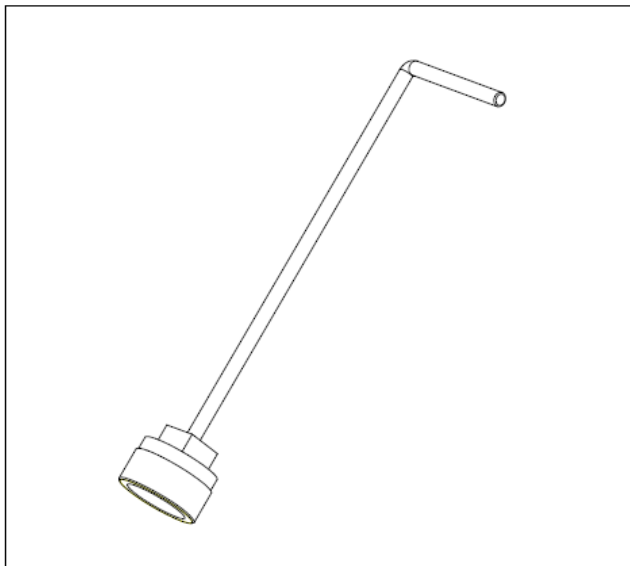

EXTENSION
2" BSP

Item	Description	Dimensions	Quantity	Material	Part number
1	Extension	2" BSP	1	STEEL	I-WR02-LA
					 1



EXTENSION

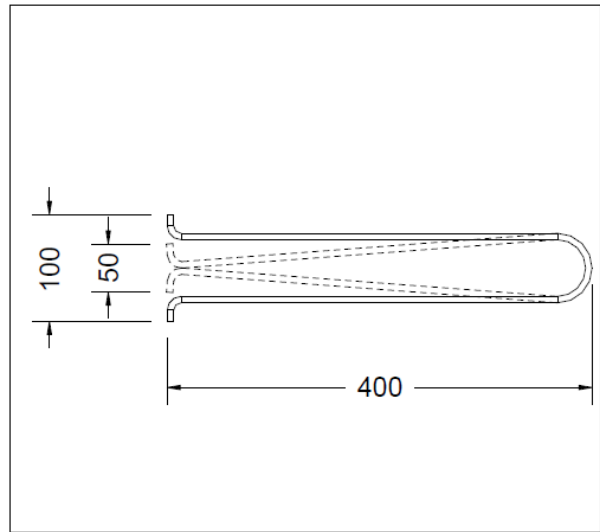
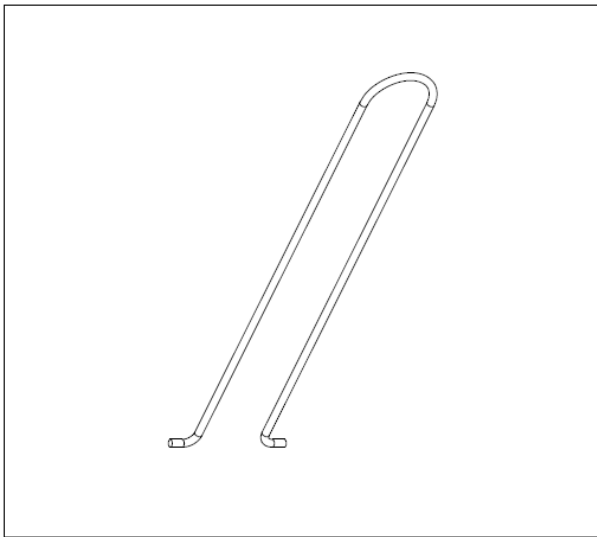

EXTENSION 6-8 HUBS

Item	Description	Dimensions	Quantity	Material	Part number
1	Extension	6-8-HUBS	1	STEEL	I-WR04-LA







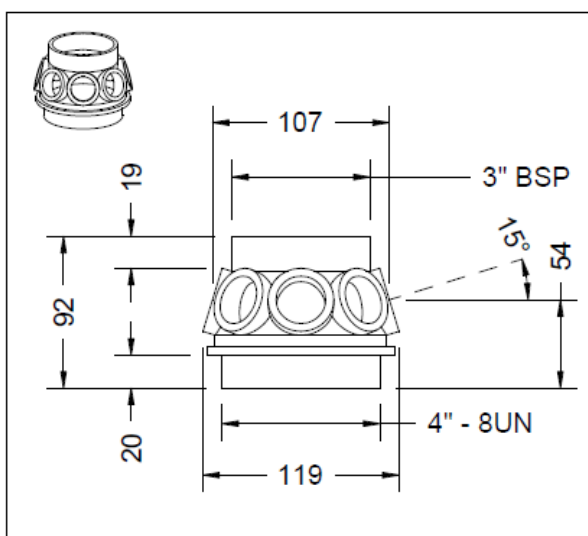
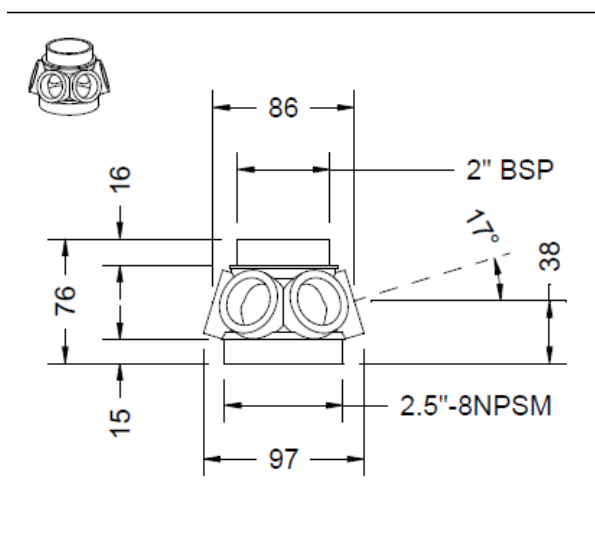

1

I-WR04-LA

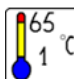
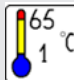

HUB

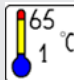
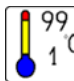
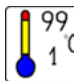
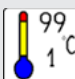

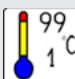
		Dimensions	Material	Part number
		Hub (6)	PP	AB-H60-00
		Hub (6)	PP	ATD-H60-00
		Hub (8)	PP	ATD-H80-00
		Hub (6)	PP-GF	ATD3-H60-00
		Hub (8)	PP-GF	ATD3-H80-00
	 	Hub (6)	PVDF	ATD1-H60-00
		Hub (8)	PVDF	ATD1-H80-00



HUBCAP

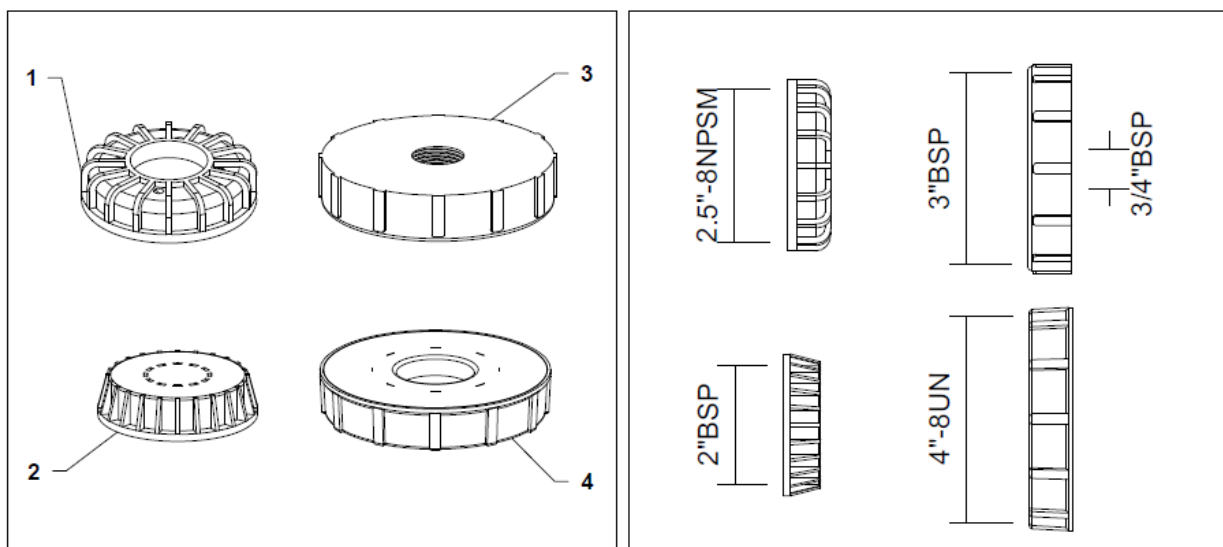



Item	Description	Part number		
		PP	PP-GF	PVDF
1	2.5" - 8 NPSM	AC-H60-00	AC3-H60-00	AC1-H60-00
2	2" BSP	AD-H60-00	AD3-H60-00	AD1-H60-00
3	3" BSP - 3/4" BSP	A-BTC8-30	A3-BTC8-30	A1-BTC8-30
4	4" - 8 UN	AD-H80-00	AD3-H80-00	AD1-H80-00

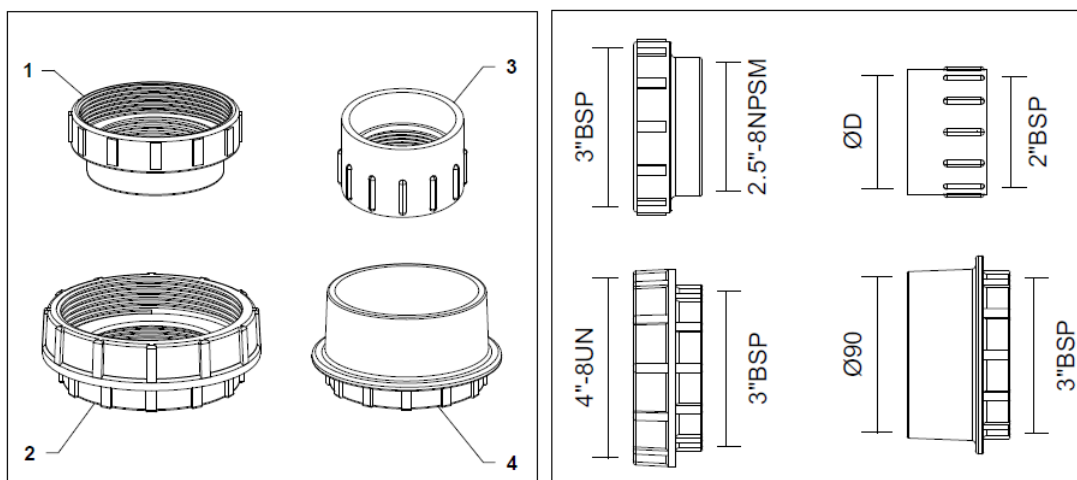

HUBADAPTER

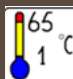
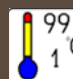

Item	Description	 PVC PP (*)			 PP-GF			 PVDF 		
		Part number								
1	2.5" - 8 NPSM / 3" BSP	AB-C08-30*	AB3-C08-30	AB1-C08-30						
2	3" BSP / 4" -8 UN	AB-C08-40*	AB3-C08-40	AB1-C08-40						
3	2" BSP / D = 50mm	A-2600-63	-	-						
3	2" BSP / D = 60mm	A-1075-1	-	-						
3	2" BSP / D = 63mm	A-1074-1	-	-						
4	3" BSP / 90mm	AB-GC8-30	-	-						



LATERAL

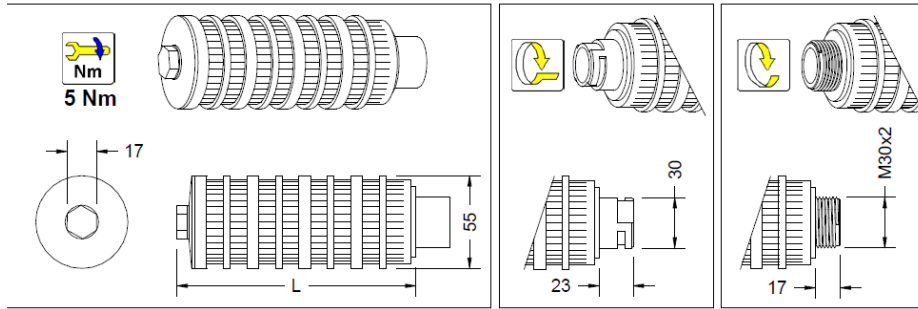

			PVDF	White
			PP-GF PPO	Black
			PP	Gray
			PP	Yellow

L (mm) Length							
113	A-BT02-113	A-BT05-113	A-TH02-113	A-TH05-113	A3-TH02-113	A1-TH02-113	6
175	A-BT02-175	A-BT05-175	A-TH02-175	A-TH05-175	A3-TH02-175	A1-TH02-175	6
268	A-BT02-268	A-BT05-268	A-TH02-268	A-TH05-268	A3-TH02-268	A1-TH02-268	6
330	A-BT02-330	A-BT05-330	A-TH02-330	A-TH05-330	A3-TH02-330	A1-TH02-330	6
361	-	-	A-TH02-361	A-TH05-361	A3-TH02-361	A1-TH02-361	8
423	-	-	A-TH02-423	A-TH05-423	A3-TH02-423	A1-TH02-423	8
485	-	-	A-TH02-485	A-TH05-485	A3-TH02-485	A1-TH02-485	8
515	-	-	A-TH02-515	A-TH05-515	A3-TH02-515	A1-TH02-515	8
578	-	-	A-TH02-578	A-TH05-578	A3-TH02-578	A1-TH02-578	8







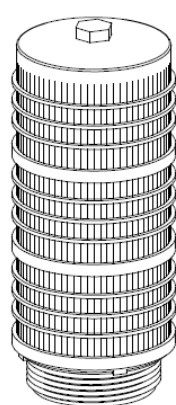

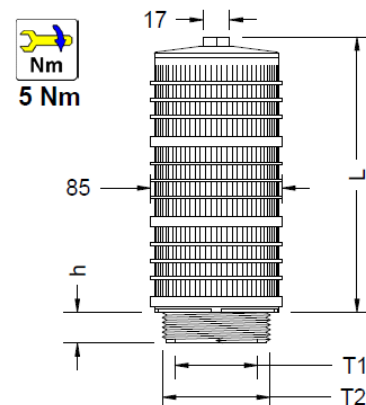

DIFFUSOR

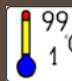



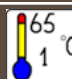

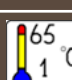









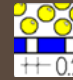

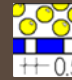
Nm
5 Nm

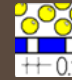
 			PVDF	White
 			PP	Gray
 			PP	Yellow

T2 (mm) Thread	T1(mm) Thread	h (mm) Height	L (mm) Length	 		 		 
				 	 	 		
2" BSP	ø50	30	126	A-2721-26	-	-	-	1
2" BSP	ø50	30	180	A-2721-80	A-2600-65	A1-2742-BSP	-	1
2.5" - 8 NPSM	2" BSP	20	180	A-2740--	A-2746--	A1-2740--	-	1
2.5" - 8 NPSM	2" BSP	20	338	-	A-2746-338	-	-	1



UNION

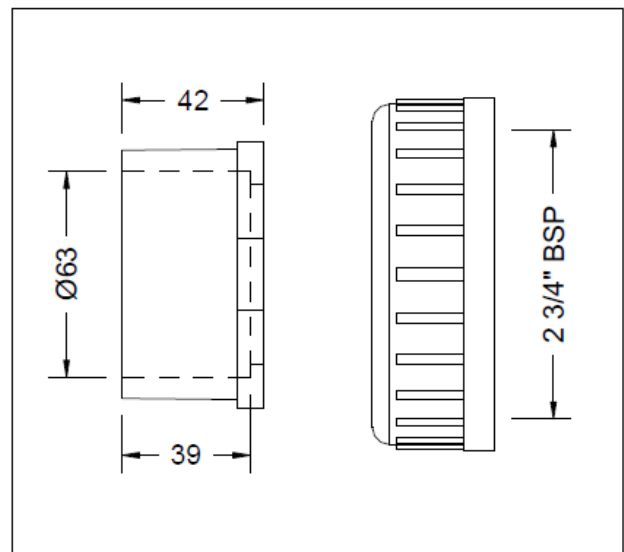
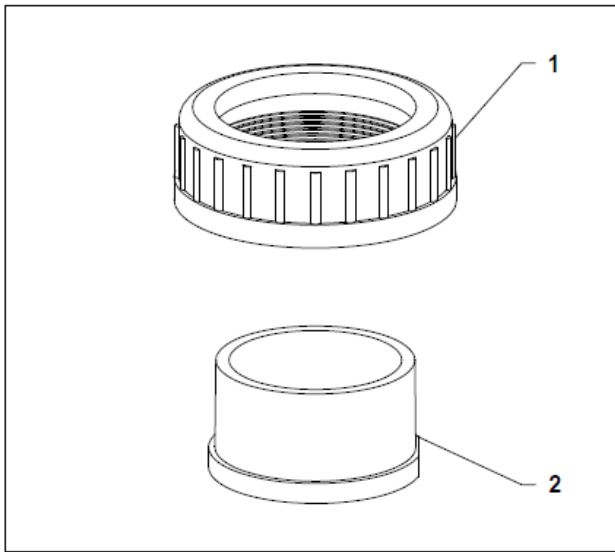

Item	Description	Material	Part number
1	Collat	PVC	A-8250-63
2	Union nut	PVC	A-8200-63
			A-8200-63C



5



ELBOW

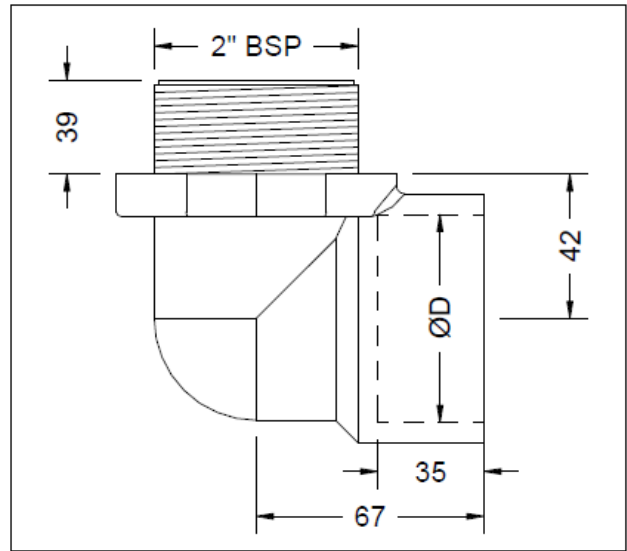
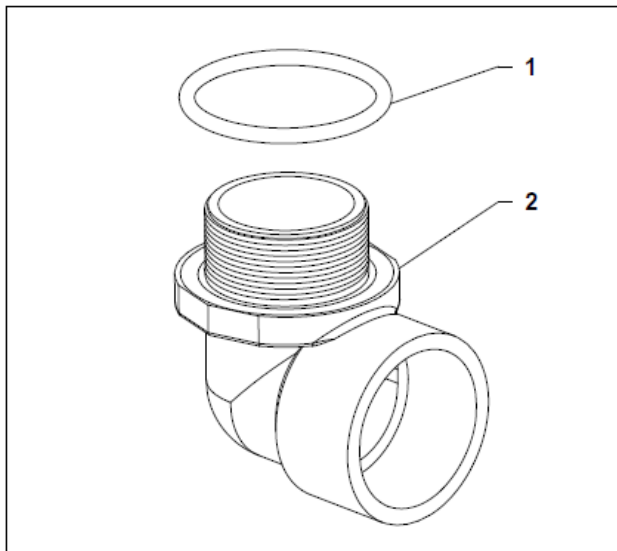

Item	Description	Material	D= 60 mm	D= 63 mm
			Part number	
1	O-ring	NBR	A-2694-17	A-2694-17
2	Elbow	PVC	A-2700--	A-2693--
			A-2700-C	A-2693-C





5

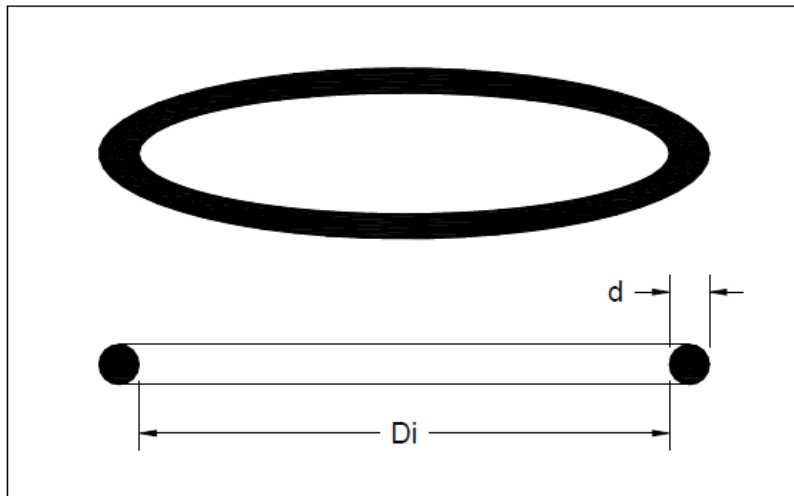

O'RING

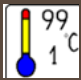
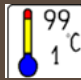

Di	d	AS-N°			 		
			NBR	EPDM	FPM	FEP	
56.52	5.33	AS331	A-2694-60	-	-	-	20
66.04	5.33	AS334	A-2694-17	-	-	-	20
68	3.53	-	-	A-2694-1	-	-	20
98	4	-	A-2694-3	-	-	-	20
110	4	-	A-2694-3F	-	-	-	20
115	5	-	A-2694-BF	-	-	-	20
145.64	3.53	AS256	A-2694-19	-	-	-	20
183.52	6.99	AS442	A-2694-8F	-	A-2694-V8F	A-2694-F8F	20



FLAT SEAL

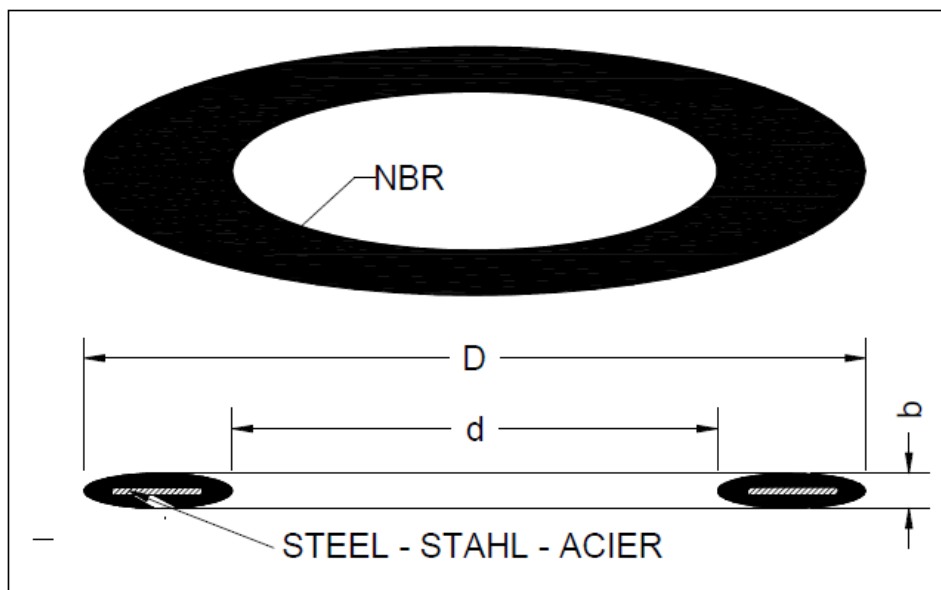

DN DIN2690	D	d	b	Part Number	
DN50	107	61	4	A-2600-68	10
DN65	127	77	4	-	10
DN80	142	90	4	A-2600-71	10
DN100	162	115	5	A-2600-67	10
DN125	192	141	5	-	5
DN150	218	169	5	A-DN15-0D	5
DN200	273	220	6	A-DN20-0D	5
DN300	378	325	6	A-DN30-0D	5
DN400	490	420	7	A-DN40-0D	5



Contact us:

By mail

Commercial support

commercial.prfemea@pentair.com

Technical support

techsupport.water@pentair.com

Marketing support

marketing.prfemea@pentair.com

By phone

Tel. +41 21 623 69 69