



TECHNICAL GUIDE

PACKAGED PRODUCTS - COMMERCIAL & INDUSTRIAL SYSTEM SOLUTIONS

2850 FILTRATION KIT





2850 FILTRATION KIT

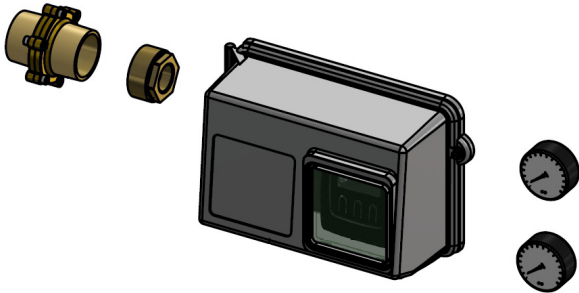

KIT DESCRIPTION

- All components and accessories included to build various types of filtration systems
- Suitable for a wide range of filter applications and adaptable to various vessel sizes: from 21x60 to 24x69 inches
- Two possible choices, Budget & Premium

BUDGET KIT

TECHNICAL DATA

- Valve : Fleck 2850
- Controller : Mechanical 12 days
- Voltage : 230V 50/60 Hz - transformer 24 VAC 50/60 Hz
- IP rating : 22
- Operating pressure : 1,5 – 8,5 bar
- Regeneration start mode :
 - Timeclock

FEATURES

- DLFC adaptable for different applications
- Mechanical timer, ideal for heavy duty and areas with bad power supply quality which might damage electronic timers
- Inlet and outlet pressure gauges included
- Possible to combine with 21x60 & 24x69 inch "top only" Structural tanks
- Tank kit include riser tube and single element lower screen
- Auxiliary microswitch

Part number	Description
CI-F-285M12-0000	Budget filtration kit - Fleck 2850 NBP time clock 12 days for 21-24" filter
CI-F2160285M120000	Budget filtration kit - Fleck 2850 mechanical with tank 21x60
CI-F2469285M120000	Budget filtration kit - Fleck 2850 mechanical with tank 24x69

PREMIUM KIT

TECHNICAL DATA

- Valve: Fleck 2850
- Controller: NXT
- Voltage: 230V 50/60 Hz -transformer 24 VAC 50/60 Hz
- IP rating: 22
- Operating pressure: 1,5 – 8.5 bar
- Operating temperature: 2-40 °C
- Regeneration start mode:
 - Timeclock
 - Differential pressure input
 - Volumetric (adding a water meter)

FEATURES

- DLFC adaptable for different applications
- NXT timer, possible to extend to a multi-tank
- Differential pressure switch included
- Inlet and outlet pressure gauges included
- Possible to combine with 21x60 & 24x69 Structural tanks
- Tank kit includes riser tube and a star lower screen system
- Dry contact during backwash and rinse: time is adjustable in controller programming

Part number	Description
CI-F-285NXT-0001	Premium filtration kit - Fleck 2850 NXT, NBP during backwash and differential pressure switch
CI-F2160285NXT0001	Premium filtration kit - Fleck 2850 NXT with tank 21x60, NBP during backwash and differential pressure switch
CI-F2469285NXT0001	Premium filtration kit - Fleck 2850 NXT with tank 24x69, NBP during backwash and differential pressure switch

PERFORMANCE (service flow rate: 0,7 - 7,2 m³/h)

Common applications	21x60	24x69
Service flow Multi-media [m ³ /h]	5,7	7,2
Service flow Antracite [m ³ /h]	3,4	4,3
Service flow GAC Cl [m ³ /h]	1,8	2,3
Service flow GAC organics [m ³ /h]	0,7	0,9
Service flow Birm [m ³ /h]	2,3	2,9
Service flow with sand [m ³ /h] (best filtration quality)	1,6	2,0
Service flow with sand [m ³ /h] (good filtration quality)	2,3	2,9
Service flow with sand [m ³ /h] (average filtration quality)	3,4	4,3
Service flow with sand [m ³ /h] (rough Filtration)	4,5	5,8

EXPLODED VIEW

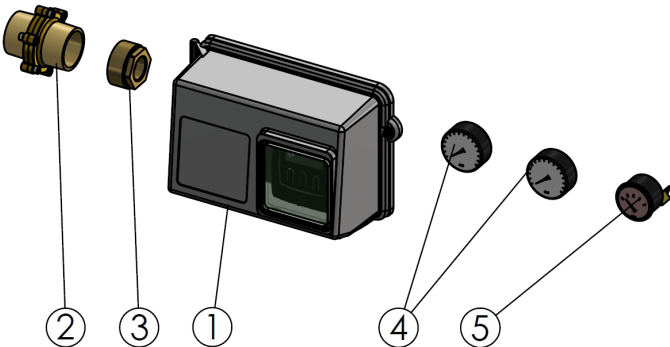

- 1. Valve 2850
- 2. DLFC kit
- 3. 3 DLFC 2" adapter
- 4. Inlet & outlet pressure gauge
- 5. Differential pressure switch (only with Premium kits)

DLFC ASSEMBLY & SETTING

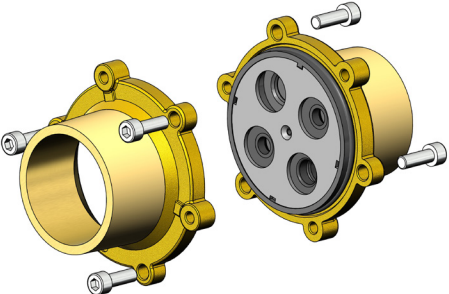
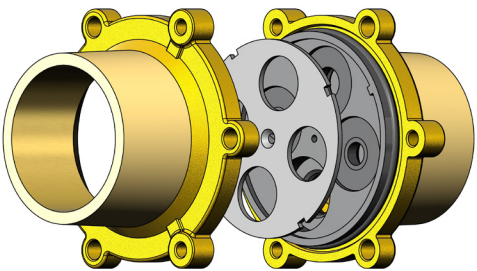
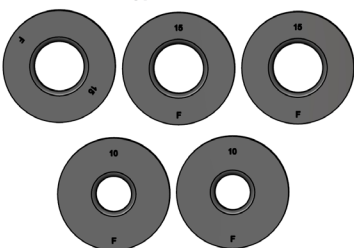
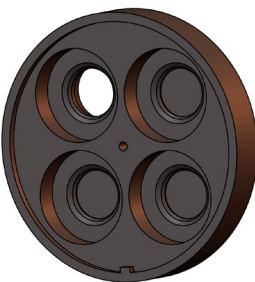
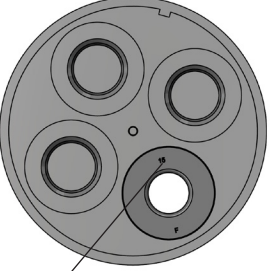
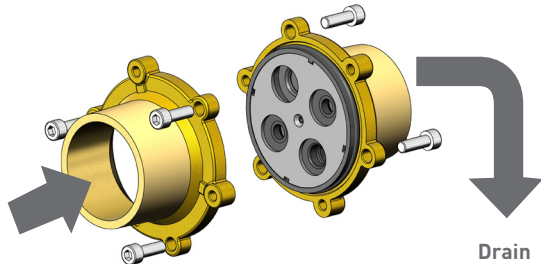
<p>1</p> 	<p>2</p> 
<p>3</p> <p style="text-align: center;">gpm value</p>  <p>Inside the kit there are 5 DLFC washers, 3 washers of 15 gpm and 2 of 10 gpm. Flow rate is printed on the surface of the washer.</p>	<p>4</p>  <p>The DLFC plate have 4 washer seat. Drill the needed amount of holes based on the number of washers to be installed. (see the table below)</p>
<p>5</p>  <p>The DLFC have to be installed with the chamfered side of the washers upfront the water stream flow. Flow indication must be visible after the washer is placed on the seat.</p> <p style="text-align: center;">gpm value visible</p>	<p>6</p>  <p style="text-align: center;">Valve drain Drain</p>
<p>To be compliant to what is stated on the step 5, the DLFC must be assembled to the valve drain as indicated in the step 6.</p>	

DLFC ASSEMBLY & SETTING

Suggested DLFC settings per media types:

Type of media	21" tank	24" tank
Sand (ca. 40 m/h)	40 gpm (2x15 + 10)	50 gpm (2x15 + 2x10)
Birm (ca. 30 m/h)	30 gpm (2x15)	35 gpm (2x10 + 15)
GAC (ca. 20 m/h)	20 gpm (10 + 10)	25 GPM (10 + 15)
Multi media and anthracite (ca.35 m/h)	35 gpm (2x10 + 15)	45 gpm (3x15)

CONNECTION OF THE DIFFERENTIAL PRESSURE SWITCH

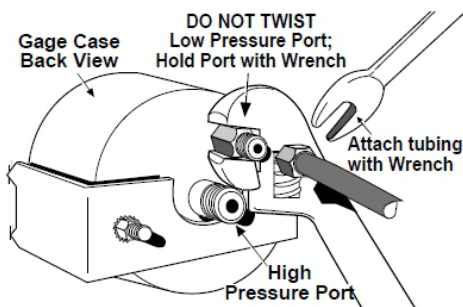
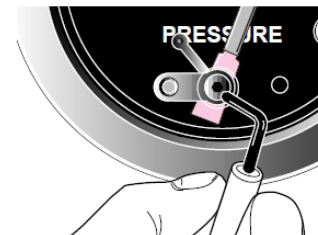

Fig.1

- The "High" pressure port (center mounted) is piped to the Inlet side of the filter. The "Low" pressure port (top center mounted) is piped to the Outlet side of the filter.



- You MUST use a second wrench on the low pressure port when tightening tube fittings (see Fig. 1)
- Notice that a wrench is used for holding the low pressure port while a second wrench will tighten the pressure tubing/hose fitting onto the port.
- All contacts are set using a 1/16 inch hex wrench. Rotate the contact until you reach the wanted setting. Set the contact slightly below the desired maximum differential pressure. Default setting is 2 bar.
- Connect the switch to the NXT (see Fig. 2)

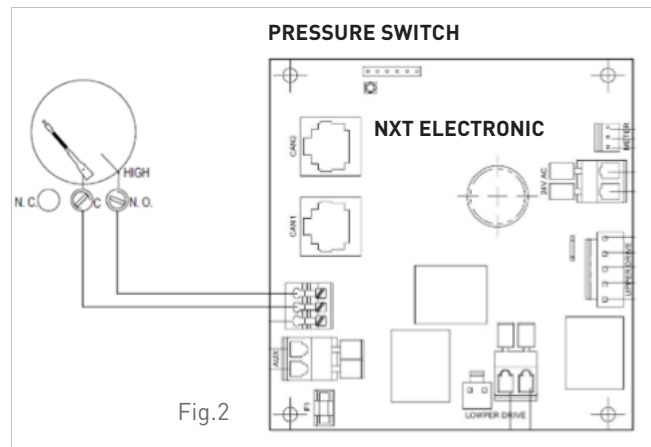

Fig.2

Note: Performance and flow settings advised by Pentair are calculated upon common media manufactures data sheets. We advise to always check with the filter media supplier the service and backwash velocities to use, and contact Pentair technical support whenever is needed to adapt the kit to different values from the ones specified in this document.

techsupport.CI@pentair.com



www.pentairaquaeurope.com